



---

# TRAIL BREAKERS

---



---

<sup>#3</sup>  
VOLUME VIII 1981-1982



CLARK COUNTY  
GENEALOGICAL SOCIETY





# CCGS

PRESIDENT  
VICE-PRESIDENT  
RECORDING SECRETARY  
TREASURER  
ASS'T SECRETARY & TREAS.

TRAIL BREAKERS EDITOR  
NEWSLETTER EDITOR  
DIRECTORY EDITOR  
LIBRARIAN

MEMBERSHIP  
HOSPITALITY  
PUBLICITY  
RESEARCH  
PRINTER  
MAILING & COLLATING  
PURCHASING & SUPPLIES  
BIBLE RECORDS  
CEMETERY RECORDS  
EARLY MARRIAGE RECORDS  
EARLY LAND RECORDS  
EARLY VITAL RECORDS  
RECENT VITAL RECORDS  
EARLY CLARK COUNTY FAMILIES  
ACCESSION RECORDS  
LIBRARY UPDATE

BOOK REVIEWS  
PERIODICALS  
ANCESTOR CHARTS  
QUERIES  
MEMBERS SURNAME FILE  
SANTIAM & FLAV-R-PAC  
NEWSPAPERS

Evelyn Maloney  
Gloria Holverson  
Nancy Stout  
Richard Lawton  
Doris Wastradowski

Janet Strode  
Kitty Oman  
Mildred Porter  
Rose Marie Harshman

Vera Sessoms  
Nadine Mikesell  
Mildred Fnnley  
June Andrews  
Mildred Porter  
Rose Marie Harshman  
Carl Wastradowski  
Jo Landers  
Kitty Oman  
Peggy Mackey  
June Andrews  
Colleen Bennett  
Vera Sessoms  
Jean Holroyd  
Bertha Krause  
Rose Marie Harshman &  
Shirley Rask  
Frances Harris  
Shirley Rask  
Gloria Holverson  
Jan Masser  
Laurie Okel  
Eurah Fish  
Shirley Rash &  
June Andrews





# *C.C.G.S. Publications*

## CLARK COUNTY WASHINGTON CEMETERIES - VOLUME ONE

Old City Cemetery of Vancouver by Mildred E. Porter  
Includes tombstone inscriptions, cemetery maps, information  
from sextons records and some obituaries. 184 pages 8½"x11"  
offset soft covers price \$15.00 + \$2.00 postage.

## CLARK COUNTY WASHINGTON LAND RECORDS

by Mary Frances Zimmerman  
Information extracted from early land ownership maps of Clark  
County. Relates if donation land claim or homestead. Gives claim  
number, township, section and range. 39 pages 8½"x11" offset  
soft covers price \$5.00 + \$1.00 postage.

## 1850 and 1860 CENSUS OF CLARK COUNTY WASHINGTON

by Mildred E. Porter  
Gives complete information on all members of household, not  
just an index. Approximately 70 pages 8½"x11" offset  
soft covers Pre-publication price \$5.00 + \$1.00 postage  
after 1 June 1982 \$7.50 + \$1.00 postage.

## CLARK COUNTY WASHINGTON CEMETERIES - VOLUME TWO

Compiled by Clark County Genealogical Society Cemetery Committee  
Includes several early Clark County cemeteries. Has inscriptions  
from tombstones, additional information from funeral home records  
or sextons records, maps with grave locations. Approximately 200  
pages 8½"x11" offset soft covers Pre-publication price  
\$10.00 + \$1.50 postage after 1 June 1982 \$12.50 + \$1.50 postage

---

Make checks payable to Clark County Genealogical Society

Cemeteries Vol. 1 \_\_\_\_\_  
Cemeteries Vol. 2 \_\_\_\_\_  
Land Records \_\_\_\_\_  
1850 - 1860 Census \_\_\_\_\_

Send order to:  
C.C.G.S. Publications  
P.O. Box 2728  
Vancouver, WA 98668

Total amount enclosed \_\_\_\_\_

Name \_\_\_\_\_

Address \_\_\_\_\_  
street state zip





# TRAIL BREAKERS

Published By

CLARK COUNTY GENEALOGICAL SOCIETY

1511 Main Street, P.O. Box 2728  
Vancouver, Washington 98668

Janet R. Strode, Editor

---

Vol VIII, No 3

SPRING 1982

Page One

---

MEMBERSHIP. . . . . Membership is open to anyone interested in the collection and preservation of family and regional history. It includes a subscription to the TRAIL BREAKERS, free publication of queries, and book check-out privileges at the CCGS Library

DUES: \$8.00 per year for an individual; \$10.00 for two members of the same household, receiving one subscription to the TRAIL BREAKERS. Dues are payable by June 30th. Dues for new memberships after March 1st (one-half year) are \$4.00.

MEETINGS. . . . . CCGS meetings are held on the fourth Wednesday of each month, September thru June, except: in November and December they are held on the third Wednesday, due to the Holidays.

TIME: 10:00 A.M. September, November, December, February  
March, May and June  
7:30 P.M. October, January and April  
Each meeting is preceeded by one hour of beginning instruction.

LIBRARY . . . . . The CCGS Library is located in the lower level of Fort Vancouver Historical Museum, 1511 Main Street, Vancouver. It is open Tuesday, Thursday and Saturday afternoons from 1:00 P.M. to 4:30 P.M.

TRAIL BREAKERS. . . . . The TRAIL BREAKERS is published quarterly - FALL (September), WINTER (December), SPRING (March), SUMMER (June). Submit any material for publication to the Editor: Janet R. Strode, P.O. Box 2728, Vancouver, WA 98668.

\*\*\*\*\*

The CLARK COUNTY GENEALOGICAL SOCIETY is a service organization dedicated to the collection, preservation and publication of the heritage of Clark County. CCGS offers assistance to genalogical researchers and family historians.

## TABLE OF CONTENTS

Letters from the Editor and President . . . . .	3
Clark County Survey, Letter from the War Department. . . . .	4
1880 Census, CLARK COUNTY . . . . .	6
San Diego Sewer Records . . . . .	.12
BOOK REVIEWS. . . . .	.18
BIBLE RECORDS      Needry Bible. . . . .	.24
Gillett Bible . . . . .	.25
CEMETERY RECORDS      Chelatchie Cemetery . . . . .	.26
Johnson Letters . . . . .	.30
SURNAME FILE. . . . .	.32
ANCESTOR CHARTS      Holverson . . . . .	.34
Gressitt. . . . .	.35
Grafton . . . . .	.38
Lewis . . . . .	.39
Rask. . . . .	.39
QUERIES . . . . .	.40
INDEX . . . . .	.42

From the President. . .

It is Spring Seminar time again. Our genealogical seminar is set for Saturday, March 27th. We have a very qualified speaker scheduled. He is Prof. David H. Pratt from Brigham Young University. He will be lecturing on four very important and informative subjects: 1) Using U. S. Military Records, 2) Using the Computer File to Solve Research Problems, 3) In Pursuit of the Illusive Black Sheep, and 4) How to Read Old English and Colonial American Handwriting. I am sure all of you have received a registration blank with your February CCGS Newsletter. If not, they are available at our library or write to me requesting one. Please return your registration early.

Not only will CCGS be having a Spring Genealogical Seminar, but there are several others within reasonable mileage. Tacoma has one scheduled for March 13th. Olympia and Portland each have one scheduled for April 17th. Other societies will be getting theirs scheduled and we will keep you informed.

Genealogical seminars are very informative and worth the effort to attend. Every speaker/lecturer has his own areas of research knowledge. It is through these seminars/workshops that we have the opportunity to increase our research know-how and develop the skills that will open the doors to informative records. Being a family historian requires all the genealogical education one can get.

Evelyn Maloney  
President

From the Editor. . . .

The TRAIL BREAKERS has a new look about it. It was printed on the Offset Press just purchased by the Clark County Genealogical Society. This purchase will save us in printing costs for years to come and will allow us develop several publication projects which will be of great benefit to the society. Besides printing the quarterly TRAIL BREAKERS and the monthly NEWSLETTER, volumes on Clark County cemetery and census records are being prepared for publication.

As a service for the membership of the CCGS, the Printing Department will do printing for you on genealogically related items. Are you contemplating publishing your genealogical records? If so, this should prove to be very economical. It is certainly worth your consideration. If interested, contact Kitty Oman or myself for further information.

Two typists are urgently needed. There is no longer the restriction of having a typewriter that can type stencils. The copy is typed on plain white paper and duplicated from that. So, if you have a typewriter that types neat and clean please let me know. THANK YOU.

Janet R. Strode  
Editor

## FORT VANCOUVER SURVEY

## Letter from the War Department

Submitted by June Andrews, who is doing research on the Early Land Records of Clark County, Washington located at the Bureau of Land Management in Portland, Oregon. The Bureau is the repository of records for Oregon, Washington and Idaho. They cover a period approximately 1853 to 1923. This letter (a copy) was found among these records.

Page 1.

War Department  
Washington City  
Jan 15, 1878

To  
The President  
Sir:

I have the honor to submit the following statement and recommendation respecting the U. S. Military Reservation at the Post of Fort Vancouver, Wash. Territory.

The Post was established May 15, 1849 and was first designated Columbia Barracks, Oregon Territory, the name was changed to Fort Vancouver July 13, 1853.

On the 1st of Oct. 1850, Brevet Colonel W. W. Loring, Lieutenant Colonel Regiment Mounted Rifleman commanding the 11th Military Dept. declared a military reservation at the post of above

Page 2.

miles square, map and description of which are herewith marked A and A 1.

To meet the provisions of the Act of Congress approved, Feb. 14, 1853 the reservation was reduced - under instructions of the Secretary of War to the commanding General Division of the Pacific, dated October 29, 1853 to an area of six hundred forty (640) acres. A map and description of the survey made in accordance with the Secretary's instructions, being forwarded to this Department by General Wool, commanding Dept of the Pacific in letter of March 15, 1854. The reservation as reduced was also announced via order from Post Headquarters aide Map and papers enclosed Mark B and B 1.

Another survey of the reservation was made in 1859 by officers of Engineers, under direction of General Harvey and plat thereof filed in the Engineers Dept. -- copy of which is

Page 3.

enclosed mark C. It further appears that still another survey was made by officers of the General Land Office in 1860.

In 1874 a careful survey of the reserve was made by Leut. Ward, 1st Cavalry under direction of General Davis, the Department Commander and as the other surveys differ in some respect from each other, and from Leut. Ward's survey, the latter was after due consideration adopted by the Department, July 15, 1875 as establishing the boundaries of the reservation. Map and Description according to Lieut. Ward's survey are herewith, marked D and D 1.

It is respectfully recommended that the action here in recited be confirmed by the Executive and the existing reservation at Fort Vancouver according to the survey of Lieut. Ward, duly declared as set apart for military purposes to the end that



Page 4.

proper note may be made in the General Land Office.

I have the honor to be Sir,

With great respect

Your obedient servant

Geo. W. McCrary  
Secretary of War

War Department  
Received Jan 16 1878

Washington  
January 15th, 1878

1st Endorsement.

Executive Mansion  
Washington  
January 15, 1878

Secretary of War

Submits statement respecting the U. S.  
Mil. Reservation at Fort Vancouver,  
W. T. formerly "Columbia Barracks,  
O. T." with recommendation that the  
action taken in establishing the  
reservation, be confirmed

The within recommendation of the  
Secretary of War is approved, and  
the Secretary of the Interior will  
cause the proper notation to be made  
in the General Land Office.

7 enclosures

R B H

ARE YOUR GENEALOGICAL RECORDS SAFE?

What would happen to the results of all those years of research if there was a fire in your home? And those one of a kind family photographs! Destroyed! Or, when you have passed on, is there a member of your family who will see to it that your records are preserved. Or will they get thrown out as junk?

There is a good way to safeguard your records. Put together the information you have now and publish it. Don't wait til you have one more important piece of information or 'get to the end.' You never will! Having several copies available among the members of your family and copies deposited in your local library is the best way to safeguard your valuable years of research.

If publishing a book is more than your means and time schedule can handle for now, you could make a xeroxed copy of what you have now and deposit it in your CCGS Library. It will make your research just that more safe and may be helpful to a fellow researcher.

## 1880 Census, Clark County

## Washington Territory

142	151	LISHAM Lorena	F 14 S-dau	At home	IL	NC	WV
		Susanna	F 11 S-dau	At home	IL	NC	WV
		Daisy	F 9 S-dau		IL	NC	WV
		DUNLAP James	M 44	Common laborer	Ire	Scot	Scot
143	152	BRATTON William Sen.	M 65	Farmer	Eng	Eng	Eng
		Mary A.	F 35 Dau	Keeping house	Eng	Eng	Eng
144	153	PITSFORD Charles	M 34	Farmer	IL	unk	unk
		Mary E.	F 31 Wife	Keeping house	IN	KY	KY
		Mary J.	F 9 Dau		WA	IL	IN
		Harriet E.	F 8 Dau		WA	IL	IN
		Clarence	M 6 Son		WA	IL	IN
		Charles W.	M 4 Son		WA	IL	IN
145	154	JOHNSON William A.	M 55	Farmer	WV	VA	VA
		Catherine	F 48 Wife	Keeping house	WV	PA	VA
		Benjamin L.	M 19 Son	At home	WV	WV	WV
		Lurilla F.	F 16 Dau	At home	WV	WV	WV
		Flora S.	F 12 Dau	At home	WV	WV	WV
		Rhena M.	F 12 Dau	At home	WV	WV	WV
		Matilda	F 8 Dau		WA	WV	WV
		MILLER Sarah	F 80 M-in-law		VA	VA	VA
146	155	TAYLOR Samuel	M 26	Farmer	Can	Eng	Eng
		Elizabeth	F 25 Wife	Keeping house	Can	Eng	Eng
		Martha	F 2/12 Dau		WA	Can	Can
147	156	KINDER Elias	M 39	Farm laborer	IL	PA	IL
148	157	AUER Conrad	M 38	Farmer	Swtz	Swtz	Swtz
		Anna B.	F 37 Wife	Keeping house	Swtz	Swtz	Swtz
		Otilla	F 5 Dau		WA	Swtz	Swtz
		Elma	F 4 Dau		WA	Swtz	Swtz
		Maggie	F 3 Dau		WA	Swtz	Swtz
		Myrtle	F 2 Dau		WA	Swtz	Swtz
		Charles	M 7/12 Son		WA	Swtz	Swtz
149	158	CARROLL Thomas J.	M 56	Farmer	CT	Ire	CT
150	159	O'BRIEN James	M 28	Farmer	Ire	Ire	Ire
151	160	DOYLE Patrick	M 30	Farmer	MO	Ire	Ire
152	161	HUNTER Samuel	M 60	Farmer	Ire	Ire	Ire
		Jane	F 47 Wife	Keeping house	Can	Ire	Ire
		William	M 19 Son	Common laborer	Can	Ire	Can
		Robert	M 16 Son	At home	KS	Ire	Can
		David	M 14 Son	At home	KS	Ire	Can
		Anna	F 11 Dau	At home	KS	Ire	Can
		Henry	M 9 Son		KS	Ire	Can
		Martha B.	F 5 Dau		KS	Ire	Can
		Charles	M 4 Son		KS	Ire	Can
153	162	ENNIS Nicholas	M 42	Wagon maker	NovS	Ire	Ire
		Katie	F 28 Wife	Keeping house	Ire	Ire	Ire
		Joseph	M 7 Son		CA	NovS	Ire
		Mary	F 4 Dau		CA	NovS	Ire
		Katie	F 3 Dau		CA	NovS	Ire
154	163	KANE Michael	M 41	Farmer	Ire	Ire	Ire
		Ann	F 35 Wife	Keeping house	Ire	Ire	Ire
		Mary E.	F 7 Dau		WA	Ire	Ire
		James	M 5 Son		WA	Ire	Ire

	KANE Patrick	M 3 Son		WA	Ire	Ire
155 164	HARRIS Timothy T.	M 37	Shoemaker	ME	ME	ME
156 165	SEVESON <u>Eskin</u>	M 74	Unknown	Nor	Nor	Nor

Here ends LaCenter Precinct

Cathlapoodle Precinct, Clarke County, 11 June 1880

157 166	PAGE Frederick C.	M 42	Farmer	ME	<u>ME</u>	<u>ME</u>
	Edna	F 48 Wife	Keeping house	OH	<u>VA</u>	<u>VA</u>
	ARMSTRONG Mary F.	F 64 Mother		<u>ME</u>	<u>ME</u>	<u>ME</u>
	BOZARTH Lelia	F 3 S-gr-dau		<u>WA</u>	<u>WA</u>	<u>OR</u>
158 167	MILLER Nancy A.	F 29	Keeping house	IN	OH	IN
	Mary C.	F 13 Dau	At home	WA	VA	IN
	Jasper G.	M 8 Son		WA	VA	IN
	Lester L.	M 5 Son		WA	VA	IN
	Gustavus S.	M 2 Son		WA	VA	IN
	Wilhelm F.	M 12 days Son		WA	VA	IN
	GREVE Gustavus C.F.	M 32 Boarder	Farmer	Han	Han	Han
159 168	BACKMAN George J.	M 29	Farmer	Can	NY	Can
	Emily	F 21 Wife	Keeping house	OR	—	VA
	Rachel	F 2 Dau		WA	Can	OR
	Mary E.	F 2/12 Dau		WA	Can	OR
160 169	BACKMAN George	M 59	Farmer	NY	NY	NY
	Clara	F 50 Wife	Keeping house	MI	Eng	Eng
	David	M 19 Son	At home	WA	NY	MI
	Emma C.	F 16 Dau	At home	WA	NY	MI
	Albert	M 9 Son		WA	NY	MI
161 170	HOLLINGSWORTH Thomas	M 39	Farmer	IN	<u>IN</u>	IN
	Mary A.	F 37 Wife	Keeping house	IN	KY	IN
162 171	BROWN Albert	I M 68		WA	WA	WA
	Catherine	I F 40 Wife		WA	WA	WA
172	<u>TOMINUS</u> George	I M 60		WA	WA	WA
	Sauvesa	I F 45 Wife		WA	WA	WA
	Joe	I M 3 Son		WA	WA	WA
173	WILLIAM Isaac	I M 22		WA	WA	WA
	Arlis	I F 22 Wife		WA	WA	WA
	Susan	I F 18 Sis-in-law		WA	WA	WA
	Tuivaive	I F 9 Sis-in-law		WA	WA	WA
174	KANACITHS William	I M 70		WA	WA	WA
175	TAPAN Joe	I M 33		WA	WA	WA
	Jemasna	I F 50 Wife		WA	WA	WA
163 176	VOHIGH John	I M 36		WA	WA	WA
	Mary	I F 40 Wife		WA	WA	WA
	MANJOU	I N 85 Cousin		WA	WA	WA
164 177	PETERSON John H.	M 45	Farmer	Schl	Schl	Schl
	Catherine	F 35 Wife	Keeping house	Hols	Hols	Hols
	Frederick	M 14 Son	At home	IA	Schl	Hols
	Jennie	F 12 Dau	At home	IA	Schl	Hols
	Amanda	F 2 Dau		WA	Schl	Hols
	Emma	F 1/12 Dau		WA	Schl	Hols
165 178	HOUGHTON Henry	M 40	Farmer	NI	VT	NY
	Sarah A.	F 29 Wife	Keeping house	IA	MA	<u>NJ</u>
	Jepe L.	M 10 Son		WA	MI	IA
	Charles H.	M 4 Son		WA	MI	IA



	HOUGHTON Minnie	F 2 Dau		WA	MI	IA
166 179	CRUTCHLEY John	M 40	Farmer	Eng	Eng	Eng
167 180	GESSEN Jacob	M 37	Farmer	Den	Den	Den
168 181	GARDNER Daniel W.	M 65	Farmer	MA	MA	MA
	<u>Lorana</u>	F 59 Wife	Keeping house	MA	NY	MA
	Emma C.	F 19 Dau	At home	WA	MA	MA
	Edward E.	M 15 Son	At home	WA	MA	MA
169 182	GARDNER D. Wells	M 26	Farmer	WA	MA	MA
	Martha	F 19 Wife	Keeping house	WA	VT	OH
170 183	BREDFELD Henry	M 69	Farmer	Neut	Neut	Neut
	<u>Dorwitetter</u>	F 70 Wife	Keeping house	Ger	Ger	Ger
171 184	MILLER William	M 55	Farmer	IN	NY	OH
	Julia	I F 50 Wife	Keeping house	OR	OR	OR
172 185	STUBBS Peter	I M 60		WA	WA	WA
	Anna	I F 40 Wife		WA	WA	WA
	Thomas	I M 7 Son		WA	WA	WA
	Sallie	I F 3 Dau		WA	WA	WA
	Charlie	I M 2/12 Son		WA	WA	WA
173 186	<u>Isaac</u>	I M 30		WA	WA	WA
	Lucy	I F 15 Wife		WA	WA	WA
	Jimmie	I M 10/12 Son		WA	WA	WA
174 187	STOWIEE Joe	I M 65		WA	WA	WA
	<u>Mary</u>	I F 62 Wife		WA	WA	WA
175 188	<u>UMLATTS</u> Wawaloops	I M 33		WA	WA	WA
	Cleyaugh	I F 20 Wife		WA	WA	WA
	Comtatts	I M 1 Son		WA	WA	WA

Here ends Cathlapoodle Precinct

Chelatchie Precinct, Clarke County, 14 June 1880

176 189	VAN AIRSDALE Theodore F.	M 48	Farmer	NJ	NJ	NY
	Peter Q.	M 16 Son	At home	WI	NJ	OH
	Ellen C.	F 12 Dau	Keeping house	IN		
	Mary M.	F 10 Dau	At home	WI		
177 190	MATHER Henry W.	M 40	Farmer	IN	ON	OH
	Rosana C.	F 32 Wife	Keeping house	Wurt	Wurt	Wurt
	William A.	M 16 Son	Common laborer	IN	IN	Wurt
	Dora E.	F 13 Dau	At home	KS	IN	Wurt
	Chester	M 10 Son	At home	KS	IN	Wurt
	Frank	M 8 Son		KS	IN	Wurt
	Martha E.	F 6 Dau		KS	IN	Wurt
	Edward	M 3 Son		WA	IN	Wurt
	James O.	M 1 Son		WA	IN	Wurt
178 191	HENSLEY James	M 43	Farmer	KY	VA	KY
	Catherine	F 44 Wife	Keeping house	NC	NC	NC
179 192	MILLER Stephen A.	M 37	Farmer	IL	OH	DE
	Sarah J.	F 35 Wife	Keeping house	IL	KY	IL
	Charles E.	M 12 Son	At school	IL	IL	IL
	Carrie A.	F 10 Dau		MO	IL	IL
180 193	GREENE Charles	m 38	Farmer	NY	NY	NY
	Agnes	F 34 Wife	Keeping house	NY	PA	NY
	Frederick	M 12 Son	At home	NY	NY	NY
	Libbie	F 13 Dau	At home	NY	NY	NY
	Charles Jr.	M 8 Son		MO	NY	NY

		GARDNER William H.	M 14	Step-son	At home	NY	NY	NY
181	194	SMITH John B.	M 68		Farmer	OH	PA	PA
		Azenith	F 69	Wife	Keeping house	OH	PA	PA
182	195	JOHNSON Noah P.	M 34		Farmer	IA	OH	OH
		Mary E.	F 32	Wife	Keeping house	OH	OH	OH
		Annie A.	F 9	Dau		IA	IA	OH
		Alice M.	F 7	Dau		IA	IA	OH
		John S.	M 4	Son		WA	IA	OH
		Thomas E.	M 3	Son		WA	IA	OH
183	196	PAESCHEL Ferdinand	M 37		Baker	Bra	Bra	Bra
		Minnie	F 38	Wife	Keeping house	Pom	Pom	Pom
		Minnie	F 10	Dau		MO	Bra	Pom
		Anna	F 8	Dau		MO	Bra	Pom
		Ferdinand Jr	M 1	Son		WA	Bra	Pom
184	197	METZ Herman	M 31		Cook in hotel	Sax	Sax	Sax
		Richard	M 25	Bro	Farmer	Sax	Sax	Sax
185	198	LAWRENCE Hyal	M 43		Farmer	Can	Can	PA
		Elizabeth	F 34	Wife	Keeping house	Can	Ire	Can
		Sarah E.	F 12	Dau	At home	Can	Can	Can
		Susan A.	F 11		At home	Can	Can	Can
		Isabel	F 9			CA	Can	Can
		Samuel	M 4			WA	Can	Can
		PEDESEN Charles O.	M 12	Taken to raise	At home	IA	Nor	Nor
186	199	THOMPSON William	M 33		Farmer	Can	Scot	Ire
187	200	MANILY John	M 40		Brick molder	Ger	Ger	Ger
188	201	WELCH Robert	M 45		Farmer	Ire	Ire	Ire
189	202	WRIGHT James	M 45		Farmer	Scot	Scot	Scot
		Jane	F 12	Dau	At home	CA	Scot	NY
190	203	RIDDLE Andrew	I M 26		Farmer	OR	OR	OR
		Susan	I F 20	Wife	Keeping house	OR	OR	OR
		Willie	I M 4	Son		OR	OR	OR
		Frank	I M 2	Son		OR	OR	OR
191	204	BARTLETT James P.	M 42		Farmer	IL	IL	KY
		Cordelia	F 32	Wife	Keeping house	OR	KY	KY
		William E.	M 15	Son	At home	OR	IL	OR
		Charles	M 12	Son	At home	OR	IL	OR
		Addie	F 10	Dau		OR	IL	OR
		Frankie	M 6	Son		WA	IL	OR
		Marcus	M 1	Son		WA	IL	OR
192	205	REID David F.	M 35		Farmer	IN	PA	OH
		Harriet	F 34	Wife	Keeping house	IN	KY	KY
		Orin E.	M 12	Son	At home	IN	IN	IN
		Rebecca E.	F 11	Dau	At home	IN	IN	IN
		James R.	M 5	Son		WA	IN	IN
		Milton M.	M 3	Son		WA	IN	IN
193	206	SMITH Henry S.	M 24		Farmer	IA	OH	OH
		Martha	F 22	Wife	Keeping house	IL	OH	OH
		Willena	F 1	Dau		WA	IA	IL
194	207	KULPER Hein	M 44		Farmer	Ham	Ham	Ham
		Nancy	F 30	Wife	Keeping house	IN		
		Hein J.	M 15	Son	At home	WA	Ham	IN
		Rebecca	F 13	Dau	At home	WA	Ham	IN
		Emma	F 11	Dau	At home	WA	Ham	IN

	KULPER James	M 9 Son		WA	Ham	IN
	Matilda	F 7 Dau		WA	Ham	IN
	John	M 5 Son		WA	Ham	IN
	Hiram	M 3 Son		WA	Ham	IN
195 208	MANWELL Elizabeth	F 64	Keeping house	OH	PA	OH
	Francis M.	M 13 Son	At home	IA	OH	OH
196 209	MANWELL Benj. F.	M 37	Farmer	IN	OH	OH
	Sarah E.	F 30 Wife	Keeping house	IN	VA	OH
	Lillie J.	F 13 Dau	At home	IA	IN	IN
	Irene J.	F 6 Dau		WA	IN	IN
	May	F 5 Dau		WA	IN	IN
	Clementine	F 3 Dau		WA/IA	IN	IN
197 210	MANWELL George W.	M 32	Miner	IN	OH	OH
	Mary	F 24 Wife	Keeping house	IA	IN	IN
	Lorette	F 4 Dau		WA	IN	IA
	William H.	M 2 Son		WA	IN	IA
	George	M 1 Son		WA	IN	IA
198 211	MANWELL John	M 27	Miner	IN	OH	OH
	Edward	M 25	Miner	IN	OH	OH
	William H.	M 22	Miner	IA	OH	OH
	Thomas L.	M 16 Bro	Miner	IA	OH	OH
199 212	HAZEN Ziba S.	M 38	Farmer	OH	NJ	PA
	Enoch	M 23 Bro	Farmer	IN	NJ	PA
200 213	DELBECK Frederick	M 29	Farmer	Han	Han	Han
	Dorothy	F 37 Wife	Keeping house	Han	Han	Han
	Charles	M 13 Son	At home	NY	Han	Han
	Emma	F 9 Dau		CA	Han	Han
	Otto	M 8 Son		OR	Han	Han
	Anna	F 6 Dau		WA	Han	Han
	Mary	F 2 Dau		WA	Han	Han
	Freddie	M 4/12 Son		WA	Han	Han
201 214	NESWAL Vincent	M 53	Farmer & Blacksmith	Morv	Morv	Morv
	Elizabeth	F 49 Wife	Keeping house	Rhin	Rhin	Rhin
202 215	WILSON Thomas	M 22	Carpenter	Eng	Eng	Eng
203 216	PEDESEN Augusta	F 44	Keeping house	Nor	Nor	Nor
	Bennett	M 16 Son	At home	Nor	Nor	Nor
	Anna	F 13 Dau	At home	Nor	Nor	Nor
	Amelia	F 8 Dau		MN	Nor	Nor
	Julius	M 5 Son		MN	Nor	Nor
	Clara	F 3 Dau		MN	Nor	Nor
204 217	JAMES Peter	M 42	Painter	Den	Den	Den
205 218	HELLEN Frederick	M 35	Huckster	Swe	Swe	Swe
206 219	KETLER Frederick	M 50	Farmer	Furd	Prus	Prus
	Augusta	F 48 Wife	Keeping house	Berl	Prus	Prus
	Bertie	F 12 Dau	At home	WI	Prus	Prus
207 220	DOBLER Jacob	M 40	Farm laborer	Swtz	Swtz	Swtz
	Joseph	M 47 Bro	Farm laborer	Swtz	Swtz	Swtz
208 221	BAUGHER Harry C.	M 40	Carpenter	OH	MD	PA
	Barbara A.	F 40 Wife	Keeping house	IL	Eng	Eng
	Chester C.	M 2 Son		OR	OH	IL
	BAILEY Etta	F 15 Step-dau	At home	OR	IA	IL
	U. Grant	M 14 Step-son	At home	OR	IA	IL
	Ida M.	F 12 Step-dau	At home	OR	IA	IL
	Frederick J.	M 10 Step-son		WA	IA	IL
209 222	LAURENT Frank	M 46	Farmer	Bel	Bel	Bel



	LAURENT Philomena	F 41 Wife	Keeping house	Bel	Bel	Bel
	Flora	F 15 Dau	At home	WI	Bel	Bel
	Rosa	F 13 Dau	At home	WI	Bel	Bel
	Anna	F 8 Dau		WI	Bel	Bel
210 223	BORT Henry	M 34	Machinist	Wurt	Wurt	Wurt
	Antonia	F 37 Wife	Keeping house	Sax	Sax	Sax
211 224	MORRISON John	M 37	Common laborer	MO	Scot	Scot
212 225	ERCKE John	M 41	Ship Carpenter	Pom	Pom	Pom
213 226	DYER Spencer H.	M 43	Book Agent	NY	NY	NY
	Harriet H.	F 40 Wife	Keeping house	NY	NY	NY
	Harvy H.	M 14 Son	At home	MI	NY	NY
214 227	CUNNINGHAM Isaac	M 33	Farmer	MO	KY	KY
	Mary	F 30 Wife	Keeping house	KY	KY	KY
	Lillie	F 7 Dau		NO	MO	KY
	Hinnie	F 5 Dau		TX	MO	KY
	Ernest	M 3 Son		WA	MO	KY
215 228	CROUSE John	M 39	Lumberman	OH	PA	PA
216 229	CANNON Timothy	M 45	Farmer	Ire	Ire	Ire
217 230	SPURRELL William H.	M 37	Farmer	Can	Eng	Eng
	Mary	F 27 Wife	Keeping house	IL	IL	NY
	Nellie	F 6 Dau		OR	Can	IL
	Charles	M 3 Son		WA	Can	IL
	Emma	F 1 Dau		WA	Can	IL
	Fred W.	M 6/12 Son		WA	Can	IL
218 231	MURRAY Simon F.	M 42	Blacksmith	Can	Scot	Scot
	Wilma	F 42 Wife	Keeping house	ME	Scot	Scot
	Gussie	M 10 Son		OR	Can	ME
219 232	TAYLOR John T.	M 33	Farmer	IN	IN	IN
	Nancy	F 33 Wife	Keeping house	IN	IN	IN
	Charles	M 5 Son		IN	IN	IN
	John	M 3 Son		WA	IN	IN
	Aaron	M 2 Son		WA	IN	IN
	ALTIZER John	M 9 Boarder		WA	IA	—
	Philip	M 5 Boarder		WA	IA	—
220 233	PARKER David	M 42	Farmer	OH	PA	PA
	Sarah	F 36 Wife	Keeping house	IN	OH	PA
	Emma	F 14 Dau	At home	OR	OH	IN
	William	M 12 Son	At home	OR	OH	IN
	Elba	F 10 Dau		OR	OH	IN
	Anna	F 8 Dau		WA	OH	IN
	Rhoda	F 6 Dau		WA	OH	IN
	Mattie	F 3/12 Dau		WA	OH	IN
221 234	HARRIS Fred W.	M 23	Machinist	MN	ME	ME
	Lillie	F 19 Wife	Keeping house	IL	NY	NY
	Gracie	F 10/12 Dau		WA	MN	IL
222 235	BRONSON James C.	M 50	Farmer	IN	PA	PA
	Hannah M.	F 33 Wife	Keeping house	PA	PA	PA
	James R.	M 16 Son	At home	CA	IN	PA
	George C.	M 13 Son	At home	CA	IN	PA
	Lillie P.	F 5 Dau		CA	IN	PA
223 236	OTWELL Thomas	M 35	Farmer	KY	KY	SC
	Lillie	F 29 Wife	Keeping house	IN	KY	KY
224 237	WILLIAMS Charles	M 31	Farmer	IN	PA	OH
225 238	REID Adam	M 32	Lumberman	IN	PA	OH
	Jane	F 32 Wife	Keeping house	IN	KY	KY

## NAMES, DATES AND ADDRESSES

## FROM OLD SEWER RECORDS OF THE CITY OF SAN DIEGO

by Mildred Porter

OWNER	DATE	ADDITION	HOOK-UP LOCATION
HAZZARD, Mrs A.	19 Jan 1900	Newtown	Cor. State & H Sts
HAZZARD, G. W. AGT	7 Apr 1897	Hortons	10th bet J & K Sts
HAZZARD, Geo. W.	6 Oct 1892	Hortons	9th bet D & E Sts
HAZZARD, Geo. W. AGT	21 Sep 1891	Hortons	7th bet F & G Sts
HICOX, Geo & HAZZARD, Mrs Geo. W.	16 Oct 1900	Hortons	3rd bet Laurel & Maple
HAZZARD, Geo. W.	18 Sep 1893	Hortons	5th bet Kalmia & Laurel
HAZZARD, G. W.	23 Aug 1890	Hortons (Business Block)	Cor. H St on 4th St
HEALY, W. T.	8 Dec 1890	Middletown	State St. Cor. Beech St
HEARN, Dr.	16 Aug 1892	Hortons	First bet Maple & Laurel
HEARNE, Dr. J. C.	12 Jul 1893	Hortons	4th St Cor. Ash St
HEARNE, M. L.	1 Jun 1894	Shermans	20th St bet G & H Sts
HEFLEMAN, H. K.	20 Apr 1900	Hortons	Front bet Juniper & Kalmia
HEFTY, M.	4 Nov 1899	Manasse & Shiller	Logan Ave bet 22nd & 23rd
HEILBRIN, F.	2 Mar 1893	New San Diego	Union Cor. H Sts
HELLADY, Mr.	12 Dec 1896	Hortons	5th St bet Date & Cedar
HELLER, M.	3 Feb 1898	Cul. & Tag.	22nd St bet E & F Sts
HELLER, M.	1 Sep 1898	Cul. & Tag.	B St bet 24th & 25th Sts
HELLER, M. F.	12 Jul 1893	Cul. & Tag.	22nd bet E & F Sts
HELP, George	17 Jan 1894	Middletown	India St bet A & B Sts
HENSLEY, Joe	13 Jan 1900	Shermans	20th bet I & J Sts
HENKING, C. F.	12 Apr 1898	Utts	4th bet Robinson & Univ. Ave
HERBERT, W. M.	29 Jul 1896	Hortons	C St bet 14th & 15th Sts
HESS, George	16 Feb 1900	Hortons	11th St bet F & G Sts
HEWITT, D. H.	29 May 1894	Hortons	9th bet C & D Sts
HEWITT, D. H.	18 Aug 1894	Hortons	14th bet A & B Sts
HEWITT, D. H.	24 May 1898	Hortons	H bet 14th & 15th Sts
HIGH, Mrs.	14 Sep 1892	Hortons	3rd bet A & B Sts
HIGH, J. E.	10 Sep 1892	Hortons	5th bet A & B Sts
HIGLEY, A. J.	31 Dec 1890	Culverwell	22nd bet F & G Sts
HILL, Nellie E.	24 Aug 1898	Cul. & Tag.	20th bet. F & G Sts
HILLADEY, Mr.	12 Dec 1896	Hortons	5th bet Cedar & Date Sts
HILLMAN, T. T.	20 Aug 1900	Hortons	5th bet Kalmia & Laurell
HINDING, P.	26 Feb 1897	Hortons	13th bet B & C Sts
HINCKLE, W. S.	3 Oct 1891	Hortons	1st bet E & F Sts
HIRTE, A.	29 Jan 1900	Brooks	13th bet D & E Sts
HITCHCOCK, Geo.	20 Dec 1892	Hortons	5th and K Sts
HITCHCOCK, Geo.	17 Jul 1899	Hortons	21st St cor. of I St
HODGE, O. E.	2 Oct 1891	Shermans	9th bet F & G Sts
HODGE, J.	6 Dec 1892	Hortons	Front bet Cedar & Date Sts
HOFFMAN, Francis	28 Apr 1900	Hortons	Front bet Beach & Cedar Sts
HODDEN, Mrs. M. S.	23 Oct 1893	Hortons	Front bet B & C Sts
HOLDRIDGE, Mr.	3 Feb 1891	Hortons	15th St corner C St
HOLLAND, C. F.	21 Nov 1890	Gardeners	4th bet A & Ash Sts
HOODRIDGE, Mrs.	6 Jun 1895	Hortons	

OWNER	DATE	ADDITION	HOOK-UP LOCATION
HOPE, Jno.	7 Sep 1898	Hortons	4th bet H & I Sts
HORN, J. E.	25 Apr 1895	Hortons	5th St bet Beech & Cedar
HOWARD, W. E.	21 May 1891	Breed & Chase	G bet 24th & 25th Sts
HUBBELL, Chas.	10 Jan 1890	Hortons	6th bet B & C Sts
HUBON, I. A.	28 Jun 1890	Hortons	7th Corner D Sts
HUGGINS, J. W.	20 Jan 1890	Sherman	21st bet I & J Sts
HUGGINS, H. M.	11 Feb 1898	Cul & Tag.	22nd bet F & G Sts
HUGHES, S. B.	5 Nov 1895	Horton	5th bet Ash & Beech
HULBERT, Ester A.	5 Oct 1898	Sherman	19th bet H & I Sts
HUMPHRY & TULLON	22 Jul 1895	Horton	5th near D Sts
HUMPHRY, Caps	13 Nov 1895	Horton	1st bet A & Ash Sts
HUMBER, Vance	30 Dec 1899	Reed & Hubble	Union Ave bet 26th & 27th
HUNNUCKS, M. D.	11 Aug 1899	Sherman	Corner 17th & M Sts
HUSTON, J. B.	28 Jun 1890	Horton	4th bet Date & Elm Sts
HYER, F. C.	5 Mar 1898	Nutts	2nd bet University & Robinson
IGLER, Miss	30 Nov 1896	Cul & Tag.	21st bet E & F Sts
INGLE, Heber	29 Jul 1893	Caruthers	8th bet A & Ash Sts
INGLE, S. G.	7 May 1896	Cauthers	8th bet Beech & Cedar
INGLEBRETSSEN, Chas.	7 Mar 1900	Taggart	22nd bet B & C Sts
IRONSIDES, R. B.	27 Aug 1889	Hortons	Front and _____
JACOBS, A. J.	25 Sep 1894	Hortons	5th St bet Cedar & Date
JAMESON, Ammie	19 Oct 1900	Middletown	Columbia bet Fir & Grape
JACKSON, Mrs.	18 Nov 1899	Sherman	15th & I St (Corner)
JACKSON, C. S.	15 Jul 1899	Middletown	Columbia bet A & Ash Sts
JACKSON, James W.	15 Feb 1893	Caruthers	Corner Ash & 9th Sts
JACKSON, Mrs. S.	22 Aug 1893	Hortons	13th bet A & B Sts
JACKSON, Mrs. Tom	10 Jan 1900	Hortons	Corner A & 13th Sts
JEFFERY's Mrs.	6 Jul 1897	Culverwell	E bet 14th & 15th Sts
JEMICON, J. C.	28 Apr 1897	Cul & Tag.	20th bet D & E Sts
JENKS, J. L.	26 Jun 1896	Middletown	State bet C & D Sts
JENKINS, Mrs H. J.	14 Aug 1900	Horton	3rd bet Grape & Hawthorn Sts
JENKINS, Mrs.	5 Jul 1900	Hortons	Corner 3rd & Grape Sts
JEWELL, Mrs.	13 Dec 1894	Horton	1st bet Beech & Cedar Sts
JOBES, C. C.	20 Apr 1900	Hortons	12th bet G & H Sts
JOHNSEN, Jas A.	1 Jun 1893	Cul & Tag.	19th bet F & G Sts
JOHNSON, A. P. Jr	20 Feb 1891	Sherman	20th bet H & I Sts
JOHNSON, Geo. H.	28 Oct 1892	Middletown	India bet A & B Sts
JOHNSON, J. B.	30 Oct 1900	Reed & Hubble	Logan bet 26th & 27th Sts
JOHNSTONE, H. S.	20 Nov 1899	Mannesse & Shiller	Kearney Ave bet 21st & 22n
JOHNSTONE, J. S.	11 Mar 1890	Horton	4th bet Oliver & Nutmeg Sts
JOHNSTON, J. S.	3 Nov 1890	Horton	Corner 9th & C Sts
JOHNSONT, J. S.		Hortons	9th bet A & B Sts
JOHNSON, Dr. Wm	22 Jun 1897	Shermans	Corner 22nd & J Sts
JONES, Mr.	23 Dec 1899	Hortons	14th bet F & G Sts
JONES, E. F.	28 Jun 1899	Hortons	9th bet J & K Sts
JONES, Hattie D.	7 Mar 1893	Hortons	First bet B & C Sts
JONES, R. A.	31 Jan 1898	Sherman	16th bet M & N Sts
JONES, Merrideth R.	24 Aug 1896	Hortons	5th bet Grape & Hawthorne
JONES, S. P.	11 Sep 1895	Hortons	8th and G Sts
JONES, T. J.	3 Nov 1899	Breed & Chase	G St bet 24th & 25th Sts
JONES, T. G.	21 Apr 1892	Hortons	3rd bet Date & Elm Sts



OWNER	DATE	ADDITION	HOOK-UP LOCATION
JONES, V.	10 Mar 1893	New San Diego	Corner H & India Sts
JONES, Wm.	30 Apr 1891	Middletown	Corner India & B Sts
JONES, Wm.	19 Sep 1894	Middletown	Union St bet A & B Sts
JOSSELYN, C. L.	20 Dec 1889	Hortons (Vacant Lot)	6th St near B St
JOURNEAY, Geo.	12 May 1891	Cul & Tag.	Corner 20th & G Sts
JOURNEAY, Mrs.	26 Apr 1900	Newtown	SE Corner State & E Sts
JUDSON, Mr.	28 Nov 1900	Culverwell	F bet 14th & 15th Sts
JULIAN, W. A.	30 Apr 1897	Culverwell	15th bet F & G Sts
JULIAN, Mrs. M.	30 Jan 1893	Cul. & Tag.	E bet 14th & 15th Sts
KAHLE, J. F.	17 May 1893	Middletown	Union bet Cedar & Date Sts
KAIDEL, J. F.	20 Sep 1897	Hortons	11th bet B & C Sts
KALAND & CO.	15 May 1895	Shermans	17th and K Sts
KASTEL, John	20 Jun 1899	Hortons	9th bet I & J Sts
KASTLE,	19 Oct 1889	Hortons (Saloon)	6th Street
KAY, Tom	12 May 1897	Hortons	2nd bet I & J Sts
KAY, Tom	19 May 1898	Hortons	K bet I & Ivy Sts
KEATING, Mrs.	12 Apr 1894	Hortons	Corner F & 13th Sts
KEATING, Mrs. G. J.	9 Aug 1890	Hortons	near Palm & 5th Sts
KEATING, Mrs. F. L.	26 Jun 1890	Hortons (Business)	Block Corner F & 5th Sts
(trench thoroughly flushed & rock replaced in as good condition as it is now)			
KEATING, Mrs. F.	4 Oct 1895	Hortons	5th bet Palm & Quince Sts
KEATING, Mrs.	19 Oct 1896	Hortons	2nd bet Kalmia & Juniper Sts
KREHN, C.	9 Jul 1890	Hortons	9th St bet A & B Sts
KEE'S, F.	18 Feb 1892	Hortons	9th bet H & I Sts
KEESSIG, Chas.	24 Oct 1894	Hortons	Corner 2nd & Ash Sts
KEIZIE, D. Mac	9 May 1900	Sherman	21st bet J & K Sts
KELLER, Louisa R.	14 Apr 1893	Cul & Tag.	22nd bet E & F Sts
	20 Nov 1890	(the Womens Home)	
In the City Park at the head of 16th St			
KINNY, Geo. L.	8 Aug 1889	Hortons	1st Street
KERFOOT, J. H.	17 Nov 1893	Middletown	Corner State & B Sts
KERREN, James	8 Sep 1899	Hortons	Corner 13th & C Sts
KEW, M.	7 Apr 1896	Hortons	3rd and Cedar Sts
KEYS, W. W.	7 Feb 1891	Hortons	12th St bet D & E Sts
KIEHNERR, Jake	5 Jul 1890	Hortons	4th bet I & J Sts
KIES, F.	10 Apr 1894	Shermans	Corner 19th St & H Sts
KIEHNERR, Jake	5 Jul 1890	Hortons	4th St bet I & J Sts
KINDLER, A.	27 Jul 1891	Shermans	16th St bet H & I Sts
KING & HILL	11 Dec 1895	Hortons (Bus. Block)	7th bet F & G Sts
KINGS, F. E.	3 Sep 1894	Hortons	5th bet Cedar & Date Sts
KING, H. F.	9 May 1900	Cul & Tag.	18th St bet E & F Sts
KING, W. N.	19 Oct 1889	Hortons	1st St - 54ft N. of Juniper
KINGSTON, E.	20 May 1892	Hortons	5th bet Date & Elm Sts
KIPP, G.	20 Apr 1891	Hortons	1st bet D & E Sts
KIRBY, Lew	19 Aug 1896	Hortons	Front bet Grape & Hawthorn
KIRBY, Lew R.	14 Jun 1895	Caruthers	7th bet Ash & Beach Sts
KIRKEY, M.	3 Feb 1896	Shermans	Corner 16th & N Sts
KIRBY, Mrs.	17 Jan 1895	Hortons	Corner 2nd & Grape Sts
KIRBY, Mrs. M. S.	12 Sep 1895	Hortons	12 bet A & B Sts
KITZLER, Chas.	15 Nov 1892	Hortons	9th bet D & E Sts
KLINE, B.	27 Dec 1892	Hortons	5th bet Kalmia & Laurel Sts
KLINE, Mr. & Mrs.	28 Jun 1900	Loma Grande	Corner 3rd & Walnut Sts

OWNER	DATE	ADDITION	HOOK-UP LOCATION
KLINE, W. B.	20 Nov 1890	Hortons (Bus. Block)	6th & D Sts
KLINE, W. B.	11 Jul 1893	Hortons	9th bet E & F Sts
PETERS, B. J. & KNAPP, H. M.	17 Nov 1899	Shermans	15th bet H & I Sts
KNIGHT, Hannah	29 Aug 1896	Hortons	Front bet Hawthorne & Grape
KOSTLE, Jno.	12 Jan 1900	Gardner & Tag.	17th bet A & B Sts
KREMER, F.	23 May 1898	Hortons	Front and Laurel
KRIESS, J. W.	29 May 1900	Hortons	7th bet G & H Sts
KRONARH, _____	8 Jul 1899	Caruthers	8th and Beech Sts
KUHN, I.	20 Aug 1897	Caruthers	9th bet Beech & Cedar Sts
KUHN, I.	21 Nov 1893	Caruthers	9th bet Beech & Cedar Sts
KUTCHEN, H. M.	8 Sep 1890	Middletown	Union bet Cedar & Date Sts
LAKE, Benjamin	6 Oct 1898	Shermans	SW Corner of 20th & J Sts
LAMAR, R. D.	14 Aug 1899	Breeds & Chase	25th bet F & G Sts
LAMB, T. B.	14 Nov 1900	Gardners	16th bet C & D Sts
LANDIS, Mrs.	26 Dec 1899	Hortons	SE 13th & G Sts
LARSON, T.	30 Jul 1890	Hortons	Union St bet E & F Sts
LARGE, A. T.	5 Nov 1898	Shermans	J St bet 19th & 20th Sts
LARSEN, Mr. F.	28 Aug 1900	Hortons	Corner G & 14th Sts
LEFFERT, Henry	4 Aug 1899	Middletown	Columbia bet A & Ash Sts
LeFEVRE, Mrs.	16 Sep 1895	Gardners	15th bet C & D Sts
LENGENFELTON, D.	27 Apr 1891	Shermans	17th bet L & M Sts
LEOCK, Mrs. W.	13 Feb 1893	Hortons	Corner First & D Sts
LEOVY, G. J.	4 Apr 1890	Hortons	Baret St cor. Ivy Sts
LESEM, M. A.	9 Mar 1894	Hortons	First corner Laurel Sts
LEVI, A.	21 Sep 1889	Hortons	F st near G St
LEWIN, R. W.	6 Aug 1895	Hortons	5th bet Quince & Redwood
LEWIN, Margarette	3 Aug 1895	Hortons	8th St bet A & B Sts
LEWIS, J.	12 Feb 1890	Caruthers	9th St corner Beech St
LEWIS, Mrs. L.	5 May 1894	Col. & Tag.	21st bet E & D Sts
LEWIS, Mrs.	30 Aug 1898	Brooks	Alley Brooks & Thornton bet 3rd & 4th Sts
LEWIS, E. L.	18 Nov 1898	Middletown	State bet Hawthorn & Ivy Sts
LIBRARY - Public	8 Dec 1900	Hortons	9th bet D & D Sts
LIN/SIN, A.	23 Jan 1895	Hortons	11th bet A & B Sts
LINDSTROM, J. W.	19 Dec 1900	Cul. & Tag.	21st bet B & C Sts
LITTLE, & HAWKINS	30 Jun 1896	Hortons	2nd bet D & D Sts
LITTLE & HAWKINS	30 Jun 1896	Hortons (Stable)	2nd bet D & E Sts
LITTLE, Joe	7 Nov 1895	Shermans	17th and L Sts
LLEWELLYN, W.	1 Aug 1894	Hortons	Front bet Elm & Fir Sts
LLEWELYN, W.	9 Aug 1893	Hortons	9th bet H & I Sts
LOCKWOOD, B. C.	20 Aug 1895	Hortons	11th bet B & C Sts
LODGE, SUNSET #328	11 Aug 1899	Hortons	7th bet I & H Sts
LONG, J. D.	28 Oct 1889	Hortons	8th St
LONG, W. G.	3 Aug 1889	Culverwells	19th St
LONG, Mr.	3 Dec 1897	Hortons	c bet 14 & 15th Sts
LOOMIS, F. S.	3 Aug 1895	Loma Grande	Corner Walnut & 5th Sts
LOOPS, T. M. Agt.	5 May 1891	Middletown	Union bet Date & Elm Sts
LORNIG, L. V.	10 Nov 1890	Hortons	4th bet Fir & Grape Sts
LOWE, C. H.	4 Oct 1899	Middletown	Union & G Sts
LOWE, C. H.	4 Oct 1894	Hortons	9th and I Sts
LOWE, C. H.	25 Sep 1894	Hortons	2nd bet Fir & Grape Sts

OWNER	DATE	ADDITION	HOOK-UP LOCATION
LOW, M. A.	28 Apr 1898	Shermans	16th bet J & K Sts
LOW, M. T.	1 Mar 1899	Hortons	14th bet E & F Sts
LOYCOCK, N.	12 Apr 1895	Caruthers	9th bet Ash & Beech Sts
LOZENBURY, R.	30 Nov 1891	Middletown	State bet Fir & Grape Sts
LOUNSBURY, E. P.	25 Feb 1890	Hortons	2nd bet Maple & Laurel Sts
LUCE, Judge M. A.	23 Apr 1896	Hortons	2nd bet Date & Elm
LUDLOW, E. A.	29 Mar 1894	Cul & Tag.	F bet 14th & 15th Sts
LYONS, A. J.	9 Oct 1897	Middletown	Union bet Ivy & Hawthorne Sts
MACONTOSH, Mrs.	23 Jan 1899	Hortons	First bet E & F Sts
MAGINNIS, B.	29 Aug 1896	Hortons	Front bet Hawthorn & Grape
MALGRAM, Otto	22 Sep 1897	Hortons	Corner 18th & N Sts
MALNGREN, Otto	16 Oct 1900	Kimballs	Alley G & H & 24th & 25th Sts
MANTANION, Mrs O. B.	24 Sep 1900	Manasse & Shiller	24th bet Kearney & Logan Sts
MALLON, Mrs.	26 May 1891	Culverwell & Tag.	22nd bet G & H Sts
MARKS, S. B. - S. W. YARWOOD, BYRES, WHITE, E., Dr C. C. LORD, Owners		Mrs. WOODBURN,	
MARKS, S. B. et al	21 Sep 1895	Gardners	16th St bet C & D Sts
MARSTEN, G. W.	10 Sep 1891	Hortons (Hotel)	Adelphi bet C & D Sts
MARSTON, Geo. W.	11 Apr 1896	Hortons (Bus Block)	5th and C Sts
MARTIN, Mrs.	14 Feb 1896	Shermans	21st bet I & J Sts
MARTINI, Frank	11 Feb 1895	Hortons	14th Corner K Sts
MASON, John	12 Oct 1893	Hortons	5th bet A & Ash Sts
MASON, Mr.	29 Nov 1897	Shermans	NW Corner 14th & N Sts
MATHISON, J. L.	4 Jan 1893	Hortons	Front bet Cedar & Date Sts
MATTIS, Mr.	18 Jan 1900	Sherman	Corner 16th & J Sts
MAY, Chas	12 Jun 1891	Shermans	15th bet J & K Sts
MENDELSON, L.	2 Dec 1895	Gardners	18th bet A & Park Sts
MERRITT, Mrs.	11 May 1898	Nutts	4th Corner Robinson Sts
MERTZMAN, Henry	23 Jun 1897	Hortons	8th bet H & I Sts
MESSUER, M.	20 Dec 1893	Cul & Taggart's	20th bet F & G Sts
MESSUER, Frank	29 Nov 1892	Hortons	Front bet A & Ash Sts
MEYER, CHAS.	25 Jul 1899	Manasse & Schilter	Kearney Ave bet 21 & 22nd
MILLARD, O. H.	27 Feb 1890	Newtown	State bet E & F Sts
MILLARD, O. H.	27 Feb 1890	Middletown	Union Corner of Cedar St
MILLARD, O. H.	18 Jan 1894	Middletown	Union bet Cedar & Date Sts
MILLARD, O. H.	30 Jun 1894	Hortons	Front bet Elm & Fir Sts
MILLARD, O. H.	26 Sep 1894	Hortons	Front Corner Fir Sts
MILLARD, O. H.	27 Dec 1897	Middletown	NE Corner D & India Sts
MILLARD, O. H.	11 Jul 1898	Hortons	3rd bet A & Ash Sts
MILLARD, O. H.	26 Jul 1900	Hortons	Cedar bet Front & 1st Sts
MILLER, J. W.	10 Jul 1899	Middletown	India bet Date and Cedar Sts
MILLICHAMP, Mrs.	8 Oct 1900	Hanesse & Schiller	Kearney bet 23rd & 24th Sts
MISSION, CHINESE	1 May 1891	Hortons (Chinese	Mission Bldg)
			13th bet F & G Sts
MISSION, CHINESE	29 Mar 1900	Hortons (Dwell)	1st bet G & H St.
MIX, L. O.	7 Jul 1893	Hortons	8th bet B & C Sts
MOFFITT, J.	19 Jan 1893	Shermans	16th bet H & I Sts
MORE, Alexander	28 Apr 1890	Hortons	3rd bet Cedar & Date Sts
MOHR, M.	15 Sep 1896	Middletown	Corner Front & C Sts
MORAN, Mrs.	3 Mar 1890	Hortons	10th bet H & I Sts
MORGAN, W.	7 Oct 1890	Middletown	Union bet Beech & Cedar
MORIANITY, Mr.	2 Oct 1889	Cul & Tag.	22nd St bet G & H Sts

OWNER	DATE	ADDITION	HOOK-UP LOCATION
MORIARITY, Mrs. Nellie	14 Oct 1890	Cul. & Taggerts	22nd Corner G Sts
MORIARITY, Mr.	10 Sep 1897	Middletown	Corner State & Date Sts
MOORE, H.	23 Sep 1895	Hortons	Front bet B & C Sts
MOORE, W.	16 Jun 1898	Brooks	Alley bet 4th & F Sts
MOORE, W.	16 Jun 1898	Brooks	Alley bet 4th & F Sts
MOREHOUSE, G. W.	10 Feb 1896	Culverwell	19th Corner E Sts
MOREHOUSE, J. W.	19 Feb 1894	Hortons	9th bet H & I Sts
MOREHOUSE, M.	7 Apr 1897	Shermens	18th bet H & I Sts
MOREHOUSE, Mr	15 Apr 1897	Shermans	18th bet H & I Sts
MOOREHOUSE, N.	5 Sep 1899	Shermans	I bet 17th & 18th Sts
MOOREHOUSE, U.	17 Apr 1892	Hortons	10th bet H & I Sts
MORLEY, T. K. & M. T.	10 Oct 1896	Hortons	7th bet H & I Sts
MORRIS, Capt.	31 May 1899	Hortons	First bet Cedar & Beech Sts
MORRISON, Riley R.	5 Dec 1892	Horton (Vacant lot)	5th bet A & Ash Sts
MORSE, A.	17 Jan 1896	Hortons	10th bet A & Ash Sts
MORSE, E. W.	16 Apr 1890	Hortons	State bet Ash & Beech Sts
MORSE, E. W.	16 Aug 1889	Hortons	
MORSE, E. W.	13 Mar 1897	Hortons	K bet 14th & 15th Sts
MORSE, Mrs.	25 Mar 1898	Hortons	11th bet K & L Sts
MORSE, N.	10 Apr 1897	Hortons	6th bet D & E Sts
MORSE, Peter	19 May 1896	Shermans	Corner 17th & J Sts
MOSSHOLDER, W. J.	30 Oct 1889	Hortons.	First and J Sts
MOYLAND, Myles	23 Aug 1894	Hortons	2nd St bet Ivy & Juniper Sts
MUIR, B. L.	31 Mar 1893	Culverwell	20th bet G & H Sts
MUIR, B. L.	16 Nov 1898	Hortons	7th bet B & C Sts
MULVEY, E.	4 Sep	Hortons	Hawthorne & 6th Sts
MULLENDER, Joseph	20 Apr 1897	Hortons	1st bet H & G Sts
MUMFORD, Joe	22 Nov. 1892	Hortons	Corner First & Ash Sts
MURPHY, Mr.	26 Dec	Hortons	13th St bet D & E Sts
MUTH, Mrs. J. L.	27 Jan 1900	Hortons	Corner 10th & J Sts
MYERS, A.	25 Nov 1897	Hortons	14th and J Sts
MYGATT, A. S.	30 Sep 1896	Shermans	21st bet K & L Sts
MYHOFER, A.	16 Mar 1899	Hortons	2nd bet Beech & Cedar Sts
MAYLME, Rev. S.	27 Nov 1895	Newtown	Front bet Kalmia & Juniper
NADERMAN, W.	20 Sep 1892	Hortons	3rd bet I & J Sts
NAGEL, Chas.	4 May 1895	Middletown	State bet A & B Sts
NASH,	13 Oct 1894	Hortons	5th bet I & J Sts
NASON, F. S.	13 Oct 1894	Hortons	Albatross bet Hawthorn & Ivy
NEALE & TRIPPET	4 Oct 1895	Middletown	India bet A & Ash Sts
NEALE, Eliza	14 Dec 1899	Hortons	4th and Cedar
NEELY, Wm.	31 Jan 1900	Breed & Chase	G bet 24th & 25th Sts
NEARFARR, Mrs. N. E.	9 Aug 1899	Manasse & Shiller	Logan bet 21st & 22nd Sts
NECKIRK, Mr.	18 Mar 1890	Hortons	Corner 7th & C Sts
NERNEY, T. A. Agt.	20 Jul 1891	Hortons	4th bet Beech & Cedar Sts
NERNEYS, M.	11 Jul 1890	Hortons	Bet Date & Elm on 4th Sts
NEWHART, J.	15 Feb 1896	Hortons (Store Bldg)	NW Cor of H & 11th Sts
NEWKIRK, N.	19 Sep 1895	Loma Grande	Walnut & Upas on 5th St
NICHOLS, Carl E.	16 Jun 1899	Caruthers	10th bet A & Ash
NICHOLS, G. B.	7 Sep 1898	Culverwells	15th & Ash Sts
NICHOLS, M. V.	1 Oct 1900	Newtown	Logan Ave bet 24th & 25th Sts
NICCOLLS, R.	29 May 1894	Hortons	4th bet A & Ash Sts
NOBLE, Jack	20 Oct 1890	Manassee & Shiller	22nd bet Logan & Kearney

BOOK REVIEWS

by Frances Harris

These new acquisitions will not be on loan while on the "new" shelf but can be used for reference when our library is open. Later they will be placed among others on the shelves. Some will continue to be reference only while others can be checked out by members for a two week period.

Indiana County, Pennsylvania Map. Published by William Barker. Presented by Holly Goracke. This large map, about 1850, shows townships, communities, and names of pioneer farmers. Some town plans are enlarged and show building locations.

Iowa, Vanburen County, Marriages, 1837-1843. Presented by Bob Rogers.  
Des Moines, Iowa: Iowa Genealogical Society.

Jaussi, Laureen Richardson and Gloria Duncan Chaston. Genealogical Records of Utah. Salt Lake City: Deseret Book Co. 1974. Presented by Holly Goracke. A Guide to genealogical sources in Utah, this book should be a real help to searchers.

Jaussi, Laureen Richardson and Gloria Duncan Chaston. Register of LDS Church Records. Salt Lake City: Deseret Book Co. 1968. Presented by Mrs. Holly Goracke. Microfilm numbers for 4000 family group records are given as well as geographical and alphabetical listings of branches, wards, districts, and missions.

Johnson, Alvin. Pioneers' Progress. University of Nebraska Press. 1960. An autobiography, he tells of Danish heritage, his father born in 1827 in Denmark, emigrating to Nebraska, where the author was born in 1874. An economist, a university professor, he also tells of war years. Indexed.

Klickitat, Yakima, and Kittitas Counties, An Illustrated History, with an Outline of the Early History of the State of Washington. Yakima, WA: Yakima Valley Genealogical Society reprinted this 1904 book. Presented in honor of E. June Andrews, President of CCGS 1980-81. Four decades of history from exploration to fur trade to settlement with early roads and coming of the railroad give details about episodes, town, and people. The last half of this 941 page book is biographical concerning over 1000 men. Indexed.

Kunitz, Stanley. Authors Today and Yesterday. New York: HW Wilson Co. 1933.  
This is a collection of biographies of about 400 authors.

Kunitz, Stanley J. and Howard Haycraft. Twentieth Century Authors. New York: HW Wilson Co. 1942. Biographies of 1800 authors with 1700 portraits are in this large book.

Missouri Historical Review. Columbia, MO: State Historical Society of Missouri. Presented by Clifton Foreman. Seven issues between spring 1968 and July 1972. Searchers may find useful clues. Some issues are indexed.

Montgomery Ward Travel Guides. The Western Region issue give information about thirteen western states. The Central Region Issue gives information about nineteen states of the central U.S.



New Jersey, Brief History and Record Sources. Shows county changes and gives addresses for various types of records needed by genealogists.

Nicolaysen, Bruce. From Distant Shores. New York: Avon Books. 1980 Presented by Colleen Bennett. This paperback novel with historical fact in major events, tells of Dutch immigrants long ago on "an island called Manhattan".

Northeast Louisiana Genealogical Society, P. O. Box 2743, Monroe, LA 71201 published the following three books presented by E. June Andrews:  
Marriages of Bienville Parish, LA 1849-1886  
Ouachita Parish 1820 Census  
Union Parish 1850 Census

Old Westmoreland. History and Genealogy of Westmoreland County, PA: Laughlinton, PA: Southwest Pennsylvania Genealogical Services Volume 1, #1 and #2 of Aug. and Nov. 1980 have been presented by Mrs. Holly Goracke. These are the first two quarterlies published by this society. They contain many names and each issue is indexed.

Oregon, Crook County Marriages 1882-1900. Transcribed by Marjorie Tracy. Published by End of Trail Reaches, 145-24th St. S.E., Salem, OR 97301. Lists names and marriage dates. Indexed.

Oregon, Klamath County Marriages 1882-1895. Transcribed by Lula Wells.

Oregon, Lake County 1880 Census. Transcribed by Harley Haskin, Lebanon, OR. Indexed.

Oregon, Lake County, Marriages. 1875-1882. Transcribed by Lula Wells. Available from Ruby Lacy, P. O. Box 628, Ashland, OR 97520. Gives couples' names and marriage date.

Pennsylvania Archives, Use of the, in Genealogical Research. Pittsburgh, PA: Western Pennsylvania Genealogical Society. 1978. Presented by Mrs. Holly Goracke. Gives titles of various records with dates and counties to assist the genealogist.

Pennsylvania, Beaver County, Naturalization Applications 1844-1900. Published by Beaver Co. Genealogical Society. Presented by Mrs. Holly Goracke. Gives over 4000 names with date and nation of origin.

Pennsylvania, Indiana County, Births 1852-1856. Presented by Mrs. Holly Goracke. Gives name, birthdate, township, names of parents and sometimes names of siblings.

Porter, Mildred. Old City Cemetery of Vancouver, Clark County Washington. Cemetery Records, Volume I. Copyright by the compiler, 1981. Presented by Mildred Porter. We're proud of the neat and thorough job done by one of our members in compiling this volume. Her introduction is worth reading and is followed by a listing of over 50 mortuaries and grave location charts. Over 3800 burials are listed in alphabetical order with gravestone wording plus cemetery record information, often including cause of death and next of kin.

Rabold, Mary Moltenberry and Elizabeth Moltenberry Price published these three books in 1971-2 which have been presented to CCGS by Gloria Holverson.  
Allen County, Kentucky Wills and Settlements 1815-1902. About 800 wills have been copied. Indexed.

Allen County, Kentucky Cemetery Records give gravestone inscriptions from about 75 cemeteries. Indexed.

Allen County, Kentucky Vital Statistics 1852-1862. Births, marriages, deaths are listed on 186 pages. Indexed.

Ramsey, Guy Reed. Postmarked Washington. Klickitat, Benton, and Franklin Counties. Goldendale, WA: Klickitat County Historical Society. 1967. Presented by LeRoy Reynolds. This is a history of post offices with a wealth of detail about small places in these three counties.

Robinson, William F. Abandoned New England, Its Hidden Ruins and Where to Find Them. Boston: New York Graphic Society. 1976. Saying that New England was never a bountiful land, the author writes about traces of the past, roads, canals, abandoned churches, houses, factories. With bibliography for follow-up. Indexed and illustrated.

Shepherd, William R. Historical Atlas. New York: Barnes and Noble, Inc. 1956, 1966. Presented by Rose Marie Harshman. 200 pages of historical maps, such as Westward Development of the U. S., World Migrations, Treaty Adjustments.

Smith, Charles W. Pacific Northwest Americana. Portland, OR: Binfords and Mort. 1950. This bibliography is a check list of books and pamphlets relating to the history of the Pacific Northwest.

South Carolina, Laurens County, Will Books A,C,D,E. Pass Christian, Miss.: Willo Institute of Genealogy. Presented by Clifton Foreman. Bound with those of Laurens Co. are will books from Anderson, Chester, and Fairfield Counties. The information contained gives the page number, date of will, and names of heirs.

Stephenson, Clarence D. Indiana County, Pennsylvania, 175th Anniversary History. Indiana, PA: Halldin Pub. Co. 1978. Presented by Mrs. Holly Goracke in memory of her grandfather, Joseph Matthais Kuhn. This is a 700 page history of the area from Indian times to the Civil War. Illustrated.

The Study of American History, Volume I. Exploration Through Reconstruction. Guildford, Conn: The Dushkin Pub. Group, Inc. 1974. This is an interesting approach to a history text with letters and varied opinions of the times. Many charts and maps such as seven of Civil War stages plus cartoons of the times. Perhaps most impressive is the inclusion of museum paintings showing historical events.

Subject Guide to Microforms in Print. Weston, Conn: A Microform Review Publication. 1976. A guide by subject classification to materials which are available on microfilm. Lists newspapers, publishers, books.

Turner, Arthur W. Calumet Copper and People. History of a Michigan Mining Community. 1864-1970. Available at the Museum of Lake Linden, MI. A hundred page history of ethnic conglomerate mining communities in upper Michigan. Illustrated.

Vital Statistics from the Columbian, Vancouver, Washington Newspaper. Compiled by Catherine Ward. This scrapbook of 1979 births, marriages, divorces, deaths, probate is in chronological order for the year and is indexed.

Wastradowski-Ruhr Family History by Doris and Carl Wastradowski. June 1981. Here's another excellent family story done by CCGS members and a copy presented to our library. It features descendants of Christian Wostradowski and Catherine Ruhr who were married in 1901 in Austria-Hungary. In 1910 they moved to Saskatchewan and in 1923 to Vancouver, Washington. The book is enhanced by tales of early times and personal incidents and is full of family photographs.

American Heritage. August 1960. Presented by Colleen Bennett. The Magazine of History. Illustrated.

Bahti, Tom. Southwestern Indian Tribes. Las Vegas: KC Publications. 1968. Tells of 40 Indian tribes of the Arizona-New Mexico area, their crafts, history. Beautifully illustrated.

Canadian Interest Group Surname List. Compiled by Ellen Collins, Portland, OR. Over 800 surnames listed.

Clark County History. Fort Vancouver, Washington Historical Society. 1981. Includes items on Shaw, McCarty, Williams, Brant, Downing, Ranck, Hidden, Henrichsen, Padden, Blackburn, Gaither, Messenger, Lieser, Cowan, Fletcher, Secrist, Mills, Irwin, Back, Bell, McMaster, Aagaard, Funk, Dorman, Gridley, Damphoffer, Rowley, Kalahan, Langsdorf.

Clark County Pioneers and Histories. From the Columbian Newspaper. Scrapbook compiled and donated by Colleen Bennett. About 400 names are indexed. Lots of local history in this.

Davis, Marguerite Norris and Cecil Tulley. The Building of a Community, Multnomah. Portland, OR: Alpha Litho. 1976. Presented by Richard Grafton. A Study of a community development during pioneer period, Multnomah County, Oregon.

Dieterle, Diane. Computerized Surname Magazine. Vol I, #1. Atlanta: Genealogical Center Library. 1981. Presented by Rose Marie Harshman. About 3700 surnames alphabetically are coded to submitters list.

Filby, P. William and Mary K. Meyer. Passenger and Immigration Lists Index. Detroit: Gale Research Co. 1981. A guide to published arrival records of about 500,000 passengers who came to the US and Canada in the 17th, 18th, 19th centuries. In the three large volumes names are alphabetically listed, giving port of entry, year, sometimes age, and source from which the data came. References include various emigrant lists, naturalization lists, and U.S. W.P.A. Index to Records of Alien Declaration of Intention and/or Oaths of Allegiance.

Foote, Stella Adelyne. Letters From Buffalo Bill. Billings, MT: Foote Pub. Co. 1954. Presented by Evelyn Maloney. Biography based on 100 letters written to his sister.

Gabble J.R. Who's Where In Your Genealogical Records; A Filing and Finding System. Idaho Falls, ID. 1964.

Gould, Helen Weaver. LaPorte Scrapbook. LaPorte, CA. 1972. Presented by Donald R. Chenette. This is a collection of newspaper, magazine, and printed articles combined to present historical events of the community from its beginning to present.

- Guide to Genealogical Material in the Multnomah County Library. Portland, OR. Compiled in 1957. Presented by Jennie Wood. 100 page listing.
- History of the Columbian Newspaper of Vancouver, Washington. Founded in 1890.
- Holbrook, Jay Mack. Vermont's First Settlers. Oxford, MA: Research Institute. 1976. Presented by Evelyn Webster Maloney. Contains 6000 alphabetical listings of land grants. 1763-1803.
- Johanson, Carl-Erik. Cradled in Sweden. Logan, Utah: Everton Publishers. 1972. Intended for researchers of Swedish records which are available on microfilm in the genealogical library of Salt Lake City. Gives details about names, places, archives, records in Sweden.
- Kirkham, E. Kay. Simplified Genealogy for Americans. Salt Lake: Deseret Book Co. 1968. Presented by Colleen Bennett. Intended for beginners in research it should be a real help with many topics covered.
- Lockley, Fred. Voices of the Oregon Territory. Conversations with Bullwhackers, Muleskinners, Pioneers, Prospectors, '49ers, Indian Fighters, Trappers. Eugene, OR: Rainy Day Press. 1981. Presented by Richard Grafton. Contains many pioneer stories. Indexed.
- Mills, Randall. Railroads Down the Valleys. Palo Alto, CA: Pacific Books. 1950. Presented by Richard Grafton. This history of short line railroads in Oregon and Washington has maps, photographs, and tales. Indexed.
- Nebraska 1886 Douglas County Voter Registration List. Published by the Greater Omaha Genealogical Society. 1981. Gives names and addresses. Indexed.
- Nebraska Maps Showing County Boundaries 1854-1925. By Sylvia Nimmo. 1978. Presented by E. June Andrews.
- Otis, Amis. Genealogical Notes of Barnstable Families. Baltimore: Genealogical Pub. Co. 1979. Presented by Gertrude Hamblen, Mildred Finley, Jean Holroyd, Maxine Inman, E. June Andrews. Originally published in 1888, this is a genealogical history of Barnstable, Mass. with biographies. Over 6000 names indexed.
- Pannell, J. P. M. Man the Builder. New York: Crescent Books. 1964. Presented by Kitty Oman. Chapters on roads, canals, railways, harbors, water supply, bridges, world view. Illustrated, indexed.
- Portland Genealogical Forum Holdings on Canada. Compiled by Ellen Collins.
- Satterwhie, Susan Jane Dooly. The Life of Susan Jane Dooly. Presented by Judy Voorhees. The autobiography starts in Missouri in 1858, continued in Kansas, then Washington.
- Scheel, Eugene M. The Guide to Loudoun, A Survey of the Architecture and History of a Virginia County. Leesburg, VA: Potomac Press. 1975. Presented by Lucille Hull. Includes maps and 13 walking tours of towns and villages.
- Somerville Mollie. Women and the American Revolution. Published by the DAR. 1974. Stories of twelve women with bibliography.

Van Ness, John R. and Christine M. Spanish and Mexican Land Grants in New Mexico and Colorado. Boulder: Center for Land Grant Studies. 1980. Historical articles. Illustrated, indexed.

Wickham, Mrs. Gertrude van Rensselaer, Editor. Pioneer Women of the Western Reserve. Published by the Woman's Department of Cleveland Centennial Commission. 1896. Reproduced by Ashtabula County Genealogical Society, Jefferson, OH. Five parts are now published in two volumes. The Cleveland Women who planned this series had found that local histories wrote about men but not about women. Arranged by locality. See Vol II for indexes.

Index to Pioneer Women. Pamphlet index refers to a book in the Fort Vancouver Historical Library which was published by the Clark County Washington Daughters of Pioneers. Over 500 names.

#### ITEMS FOR THE VERTICAL FILE:

Barker Genealogy. Compiled by James Parshall. From Ephraim Barker who came to Connecticut in 1750s. Published 1897.

Bartlet Family. Presented by Gerry Gilman.

Bumpus, Betty and Anita Cheek Milner. Research Material from Seminar May 1981.

French Huguenots. Pamphlet by Nancy Roelker.

Kentucky. Four maps.

Martin Family. Early tracing of name including John Martin, founder of Swansea, MA. Presented by Gerry Gilman.

Noland Family, Stephen-Daniel Line. Presented by Gerry Gilman.

Three Marriage Certificates, 1901. Thos Hill-Edna Miller, Noel Lehman-Lotta Boylan, Leo Dewelt-Lennie Keelan. Presented by Diane Hurley.

#### HOWARD BURRELL

Howard Burrell of Camas, Washington has made a 100-page genealogical record for his granddaughter, Dana. He had a small trunk filled with old family photographs from small tintypes to parlor photographs in ornate frames. The trunk also contained information on the family ancestry. Being an experienced amateur photographer, he made copy negatives so he could make photographs of uniform size. With typewritten labels he composed an 80-page album. He followed this with narrative stories of several family branches and a foldout chart to show how they all fit together. He indexed it all.

Lines go back to GEORGE BURRELL, born 1795, England, then Illinois; ABRAHAM BROWN, born 1806, lived in Iowa; JOHN BURK, in Iowa in the 1850s; THOMAS TUCKER, born 1810 in Kentucky; ANDREW ZUMWALT, who came to Maryland from Germany in 1737; HIRAM JACKSON, who crossed the plains in 1862 from Illinois to Drain, Oregon; MARTIN MILLER, who came to Lebanon, Oregon from Illinois by wagon train in 1862; GEORGE ZINSERLING, born 1851 in Germany; BARTHOLOMEW SCHECHLA, born 1847 in Prussia; JOSEPH KISMALSKI born 1849 in Poland.

Mr. Burrell loaned his compilation to the LDS Genealogical Library in Salt Lake City, and is now available there on microfilm.



## BIBLE RECORDS

I was a Bible at the flea market and copied it. It had no front fly page, so I found no date on the Bible. It had a few pages for photographs. In the center was the "Family Record" pages.

Name	Date of Birth	Date of Death
Father - W C Needry	April 2nd 1821	July 9th 1870
Mother - Julia A Killingsworth	October 14th 1824	January 26th 1905
Children:		
Laura Luella Needry	August 23rd 1854	September 19, 1890
Mary Slocum	February 17th 1844	November 1st 1912
Harriet A Barr	February 9, 1848	
Julliett Needry	February 14, 1857	February 28, 1857
Edward H Slocum	June 1844	May 6th 1904
Emma Moore	February 12, 1871	December 27, 1902
Roy E Phillips	March 10, 1884	
Bill G Phillips	May 26, 1866	
Ruben Phillips	February 1861	
Ida Canutt	August 3, 1868	
Julia Strevy	February 1865	

\* February was always spelled Febuary.

## BIOGRAPHICAL SKETCH

John Killingsworth, who died at his home in Dayton, Washington, Jan 25, 1890, was born Nov 1, 1818, in Knox County, Tennessee. From 1843 to 1853, he lived in Greene County, Missouri, where he married his first wife, Miss Eliza Shields, who accompanied him to Lane County, Oregon, in 1853. Here he spent twenty-eight years of his life, during which time he lost the wife of his youth, and in 1875, he married Mrs. J. A. Nedry, who is left at an advanced age - a widow indeed - to mourn her loss.

In 1881, he moved to Whitman County, Washington Territory, and in 1884, made his last change, locating in Dayton.

In faith and life, a Christian from almost his youth, he has been a quiet, honorable, worthy man. Indeed, love and peace was his most marked characteristic. His only son, William Killingsworth, of Portland, informed the writer that he never saw his father exhibit violent temper in his life.

The aged couple had each three children by former marriages, all of whom remain worthy members of society, and tenderly attached to each other.

Funeral services were held at the Christian Church, and his remains were borne by the tender hands of his brethren and associate officers, with whom he has been active in Christian work for the past eight years. He rests in peace.

Neal Cheetham

BRING IN YOUR BIBLE RECORDS: THEY MAY HELP SOMEONE ELSE. THANKS.

## GILLETT BIBLE

The/ Holy Bible/Containing/ the/ Old and New Testament/ Translated out of the  
Original Tongues; And with the Former/ Translations Dilegently Compared and  
Revised/ By his Majesty's Special Command./ Appointed to be read in Churches/  
London:/ British and Foreign Bible Society (torn)? / Instituted in London in the  
Year 1804: / 146, Queen Victoria Street/ Printed by Eyre and Spottswood (torn?) /  
Fly leaf missing.

Married Sept. 3, 1867

Next page

Ezekiel Gillett Borned May 2, 1848 (Printed on Marin - Died May 7, 1932)

Louisa Gillett Borned May 9, 1849 (January 31, 1934)

Albert Gillett Bornd Sept. 31, 1869

Ida A Gillett Bornd July 9, 1871

Sarah A Gillett Bornd Jan 1, 1870

James Gillett Bornd Jan 9, 1873

George S Gillett Bornd Aug 3, 1878

Lillie Gillett Born Feb 25, 1880

Fred Gillett Born F 2, 1882

Lizzie Gillett Bornd June 25, 1884

Lettie Gillett Bornd July 14, 1886

Pearl Gillett Bornd March 7, 1891

- Loose in the Bible -

## Baptismal Certificate

This certifies the Mr. E. Gillett in humble submission to the Divine Command  
and as evidence of his faith in the teaching and example of our Savior Jesus  
Christ was buried with his Lord in Christian Baptism of Halfway this 1 day of  
July 1908/.

Christian Minister      Leon Meyers

## NEW MEMBERS

Lower Columbia Genealogical Society P. O. Box 472, Longview, WA 98632

Marianne Safransky 1403 S. E. 105th Ave, Vancouver, WA 98664

Marilyn Dahlquist 2912 N. E. 127th Ave, Vancouver, WA 98662

## CHELATCHIE CEMETERY

Chelatchie Cemetery was begun in 1892. It's location is 4½ miles N.E. of Amboy, Washington on Hwy. 503. It was recorded in August 1980 by Donna Larson and typed by Delilah Knight.

The Maiden names in ( ) were provided by caretaker Mary Campbell and do not appear on the stones.

<u>NAME</u>	<u>NAME</u>	<u>LOT NO.</u>
ADAMS, James Sr. (no name on marker)	Died 1923	77
ALLEN, Baby (Son of Percy)	(No date)	27
ALLEN, Elva (no stone)	Deid 1940	98
ALLEN, Mary Emaline	1860 - 1932	27
ALLEN, Miles Lee (no stone)	(Grandchild of Miles) (no date)	27
ALLEN, Miles Standish	1850 - 1921	27
ALLEN, Percy (Son of Miles)	(no stone) 1902 - 1952	27
ALLEN, Vienettie L. Beloved Dau. of M. S. & Mary E. Allen	1893 - 1908	27
ANDERSON, _____ Mr. (Inez's husband)	(no stone - no date)	77
ANDERSON, Inez P. (maiden Gregory - no stone)	1886 - 1954	77
AUSTIN, Estella B. (maiden name Mc Kay)	At Rest 1863 - 1942	72
AUSTIN, MINOT	At Rest 1853 - 1925	72
BAGGETT, Calvin C.	1895 - 1980	73
BAGGETT, Esther A. Mother	1896 - 1977	73
BAKER, Adaline (maiden Carlson)	(no stone) Died 1935	49
BAKER, Baby (no stone - died 1935)		49
BARNETT, Ray baby (no stone - died 1910)		79
BERNHARDT, Richard D.	1895 - 1964	54
BOWES, Charles E. Son	1889 - 1900	61
BLAIR, Burt (no stone)	1875 - 1952	31
BLAIR, Elizabeth (no stone - no dates)		81
BLAIR, Enos M.	1882 - 1936	62
BLAIR, George (no stone - died 1935)		62
BLAIR, TRESSIE	Died 1963	62
BLAIR, Rhoda (Dau of Bert & Elie)	(no stone) 1913 - 1918	81
BOWES, Edward Father	1850 - 1899	61
BOWES, Thomas A. Son	1896 - 1909	61
CAHILL, Kenneth Son of Wm. & Rebecca	Born 13 Mar 1891 Died 3 Nov 1892	53
CAHILL, William	(2 stones; one says simply "Kenneth")	
CAHILL, William	Born 4 Nov 1837 Died 9 Aug 1900	
Verse:		
Amiable and beloved husband		
Father and brother: farewell.		
Not on this perishable stone		
but in the book of life and in		
the hearts and minds of men		
is thy true worth recorded.		
(two stones, one says simply "Father" )		
CAMPBELL, Lloyd M.	1906 - 1979	72
CAMPBELL, Mary L. (maiden Farwell)	1910 -	72
CARLSON, Baby (no stone - no date)		49
CARLSON, Pearl Mae (dau of Art)	(no stone) 1930	49
COONS, Jacquelen, baby (no stone)	1939	98
COONS, Lawaence, baby (no stone)	1935	98

NAME	LOT NO.
COX, Pauline Loving Wife & Mother 1918 - 1975	45
CURTICE, Alva B. Til We Meet Again Jan.1906 Oct. 1975	59
CURTICE, Benjamin A. 1866 - 1950	59
CURTICE, Charles baby (no stone)? 1904	59
CURTICE, Lina Ulery In Memory of - Wife of B. A. Curtice Born in Multnomah Co. OR 22 June 1868 Died 28 Sept. 1898	59
DAGUE, Webster (no stone) 1937	99
DEHAVEN, BABY Boy 1922	57
DOWNING, Twin boys (no stone) 1926	93
DRAKE, Kathleen B. (Maiden HAM) 1924 - 1974	26
DRAKE, Willard E. 1923 -	26
EATON, Anna Daughter 1910	16
EATON, Edna L. 1892 - 1978	16
EATON, Gene Son 1915 - 1918	16
EATON, Joseph 1886 - 1936	16
FARWELL, Charles B. Father 1832 - 1946	72
FARWELL, Debra M. Gone But Not Forgotten - Daughter 5 Nov. 1956 24 Aug. 1964	71
FARWELL, Frances M. (known as Ada - maiden Bradley) Mother 1888 - 1959	72
FARWELL, Marion B. Son 1937 - 1942	71
FARWELL, Marvin J. Gone But Not Forgotten - Father 25 July 1936 24 Aug. 1964	71
FIEGE, Robert (no stone, wooden marker was burned in fire - no date)	17
FRACH, Regal R. (no stone) 1954 - 1969 Between 97 & 102	102
FRASIER, Dollie J. (10 days old) Born 17 Jan. 1925 Died 28 Jan. 1925	95
FRASIER, Earl L. 1889 - 1943	95
FRASIER, Ervin E. June 1942	95
FRASIER, Ida E. (maiden HENDRICKSON) 1898 - 1939	95
FRASIER, Leonard E. 26 June 1928	95
GALLWAY, Jennie Blair (no stone)	62
GERBER, Wm. F. In Memory Of - Born 5 Feb. 1851 Died 4 July 1917	6
GREGORY, Charles L. 1858 - 1939	30
GREGORY, Daniel 1892 - 1940	77
GREGORY, Daniel W. Born 6 May 1827 Died 8 April 1897	80
GREGORY, Ella R. 1877 - 1940	73
GREGORY, Elvina Born 7 March 1829 Died 29 Dec. 1899	80
GREGORY, Hiram I. 1860 - 1949	79
GREGORY, John W. 1864 - 1944	73
GREGORY, Martha E. 1868 - 1942	80
GREGORY, Phoebe E. 1864 - 1939	79
HAM, Francis H. Father 1887 - 1974 Alley between 41 & 26	26
HAM, Ruth Eva Mother 1898 - 1974 Alley between 41 & 26	26
HANBY, Leona (maiden HUNTER) (no stone) 1917 - 1975	59
HANLEY, Beckie E. 1900 - 1920	39
HANLEY, Cora 1869 - 1957	39
HANLEY, Etta L. (maiden RAISEY) 1897 - 1977	39
HANLEY, Grover J. 1890 - 1967	39
HANLEY, John 1862 - 1937	39
HANLEY, John C. 1888 - 1961	39
HANLEY, Linda Ruth 2 Oct. 1946 7 Apr. 1947	41
HENDRICKSON, Frederick D. 1871 - 1950	96

<u>NAME</u>	<u>LOT NO.</u>
HENDRICKSON, Inez M. (daughter - Fred) 1912 - 1937	96
HENDRICKSON, Irene V. (daughter - Fred) 1915 - 1925	96
HENDRICKSON, John (no stone ?) 1909 - 1968	96
HENDRICKSON, Mary His Wife - At Rest 28 Sept. 1838 14 Jan. 1915	96
HENDRICKSON, Mattie B. (maiden Walrig) 1873 - 1934	96
HENDRICKSON, Peter 25 Mar. 1837 24 Apr. 1918	96
HENDRICKSON, Peter F. (son - Fred) 1900 - 1919	96
HICKEY, Margaret J. Mother 1872 - 1942	7
HUFFMAN, J. R. Father 1859 - 1905	28
HUNTER, Florence R. (maiden CURTIS) 1891 - 1970	59
HUNTER, George A. 1923 - 1928	59
HUNTER, Judson W. 1887 - 1966	59
HUTCHENS, Eligah C. (spelled with G) 1847 - 1914 (two stones, one had carved, side-by-side for Eligah)	97
HUTCHENS, Eliza J. 1855 - 1939 (Two stones, one hand carved, side-by-side for Eliza)	97
HUTCHINSON, George (no stone) 1874 - 1958	105
INDERGARD, Oscar H. 1888 - 1979	40
INDERGARD, Selma R. 1889 - 1977	40
KOPLIN, Artie H. Born 16 Aug. 1899 Died 4 June 1918	40
KRUKRA, Charlotte (no stone - no dates)	94
KRUKRA, Robert (no stone - no dates)	94
LAMB, James Roy (no stone) 1881 - 1949	104
MC ADAMS, John (no stone) 1923	17
MC CARTY, Nettie M. Mother 1873 - 1960 (There are two stones with her name, one joint with her husband and a separate one beside it.)	41
MC CARTY, Clark S. Father 1860 - 1942	41
MC KEE, Archie G. 1869 - 1938	6
MC KEE, Della (maiden HUTCHINS) (no stone ?) 1978	97
MC KEE, Elvira Mother Born 26 April 1836 Died 7 July 1914	6
MC KEE, Martha H. E. She Rests in Heaven - Born 1 Feb. 1868 Died 22 Apr. 1894	6
MANWELL, Benjamin Born 11 Sept. 1843 Died 26 May 1881	75
MANWELL, Charles T. 1967 - 1974	160
MANWELL, Edward (no stones - no dates)	76
MANWELL, Fern John 1965 - 1965	160
MANWELL, Francis M. 1862 - 1944	74
MANWELL, George (no stone - no dates)	75
MANWELL, Lehn E. (no stone) 1913 - 1963	74
MANWELL, Lena M. 1873 - 1942	74
MANWELL, Mae C. 1905 - 1964	75
MANWELL, Peter F. 1900 - 1962	74
MANWELL, Sylvia Anna 1919 - 1980	?
MANWELL, Thomas Ira (no stone) 1898 - 1961	74
MANWELL, Thomas L. Born 18 June 1864 Died 10 July 1898	73
MANWELL, William (no stone) 1857 - 1923	76
MANWELL, William H. Born 10 Sept. ____ Died 1 Oct. 1872	75
MOON, Earl E. 1893 - 1954	116
MOON, Hulda M. (maiden HENDRICKSON) 1896 - 1972	116
MOON, Kingsley F. 1869 - 1954	116



<u>NAME</u>	<u>LOT NO.</u>
MOON, Maude C. (maiden WITHERS) 1872 - 1954	116
MOORE, Charles E. Father 1881 - 1958	18
MOORE, Infant Oct. 1935	18
MOORE, Maria A. Wife of S. E. Moore - Born 4 Nov. 1827 Aged 20 years	18
MOORE, Rosa Alice (maiden WINDLE) Mother 1880 - 1945	18
MOORE, Samuel E. Aged 85 years Born 28 Dec. 1812	18
MOORE, Willis 1920 - 1920	18
OLSTAD, Charles E. 1903 -	7
OLSTAD, Della F. Born Dec. 31, 1896 Died Feb. 1, 1905	29
OLSTAD, Minnie A. Mother 1863 - 1929	29
OLSTAD, Nels O. Father 1873 - 1912	29
OLSTAD, Opal I. (maiden HIEKY) 1895 - 1963	7
OLSTAD, Violet Born 15 Dec. 1898 Died 19 Dec. 1898	29
OLSTEAD, Donald G. 1938 - 1980	29
PATTERSON, Charles F., Washington TEC 5 U. S. Army World War II 26 April 1899 18 Feb. 1970	61
PAULSON, Mary (maiden GREGORY) (no stone?) Died 1963	79
ROYSE, Sylvia A. Mother 1897 - 1972	127
ROYSE, Thomas P. Father 1885 - 1953	127
SILVIS, Roy Z. In Thee Have I Put MY Trust - 23 Dec. 1898 21 Oct. 1976	43
STEPHENS, Nora L. (married 2nd BENNETT) Mother 17 May 1880 10 May 1969	
BENNETT, Nora L. (see STEPHENS) (maiden HUTCHINS) (no stone 1880 - 1969) This woman listed as Nora Bennett in cemetery records but Nora Stephen on her gravestone.	97
SWINGLE, Herman Died 25 Nov. 1908	11
THOMAS, Helen M. 1878 - 1963	117
THOMAS, Jerry Lewis Dearly Beloved 1941 - 1976	7
THOMAS, Phillip V. 1871 - 1954	117
ULERY, David 1831 - 1911	60
ULERY, John (no stone - no dates)	60
ULERY, Martha J. His Wife 1835 - 1910	60
WAGGENER, Mark Ellis In God's Care - Son 1961 - 1979	26
WHITE, Infant Mar. 1934	16
WINDLE, Charles Our Baby Sept. 1904	57
WINDLE, Frank G. 8 Sept. 1881 21 Jan. 1962	60
WINDLE, John 1853 - 1934	57
WINDLE, Lottie M. (maiden EATON) 4 Sept. 1885 16 July 1934	60
WINDLE, Mary (maiden ULERY) 1862 - 1944	57
WYERS, James F. 1888 - 1949	126
WYERS, Laura (maiden RUSSELL) (no stone?) 1895 - 1979	126

## WORDEN FAMILY PERIODICAL

If you have WORDEN in your family tree, you may be interested in the WORDEN FAMILY PERIODICAL. It is issued four times a year - winter, spring, summer and fall. The cost is \$4.00 per year. Queries are free to subscribers. If interested write to:

Mrs. Pat Worden  
1201 Glendale Street  
Midland, Michigan 48640

## JOHNSON LETTERS

These letters are continued from previous editions of the Trail Breaker. The spelling and punctuation are taken just as they are written in the originals.

(The following letter is without an envelope)

Oliver Ind  
Feb. 19, 1900

Dear Cousing Bert,

Will now try to answer your letter I recieved last Saturday, and was very glad to hear from you and to know that you want \_\_\_\_ (this line is on the fold of the paper, now worn and unreadable) No I am not going to school any this winter on account of I don't like our teacher we came near having a scrap last winter and I thought I would not go any this year. You asked me who was my girl why didn't you tell me your girls name. mine is name Pitcher her father was killed by lightning last July the 29th day. I have been going with her some over three months and I like her all O.K. I have gone with her longer than I ever did a girl before in my life. Have you people got any Small Pox out where you are. we have had it out here and they still have it in Mt. Vernon. one of my cousins has had it but he is well now. I was vaccinated and did not take the Small Pox, but I sure had an awful sore arm. No I did not go to the Philipines, but I am going to the Regulars this fall and if I can't get in there then I am going to Oregon. Chas. Hayes has just returned home from Ore. he has purchased a farm of 90 acres out there. he got into trouble with a girl out here and she swore a kid to him, and he will have his trial the 26 of this month. That is pretty tough for a preacher isnt it. I was 18 years old the 5 day of this month. the day I was 18 years old I weighted 158 lbs. and am 5-9 high.

Mamma burned her hand this eve with hot water and she says it hurts her awful bad too. Say Bert you must have your picture made with your uniform on and send me one of them and when I get in the Army I will have some made and send you one or maby before I go. we have had one snow this year and it is just now going away Our folks are all well at present.

Well I will close hoping to hear from you soon and often I remain your Cousin Bert Willis to Mr. Bert Hughes

I wish you success in your school studies, Good Bye From Bert to Bert.

(The following letter is enclosed in an envelope addressed: Mr. James L. Johnson, Manson, Iowa. The return address: Albert Mitchell, Corwith, Iowa. Postmark: Corwith Iowa Aug 7 1912.....The letterhead on this letter is rather fancy - printed in red and dark green. FARM LANDS..ALBERT MITCHELL INVESTMENTS, Corwith, Iowa.. Telephone No 78..Tenants secured for non-residents, rents collected and estates managed....I buy and sell farms. Northern Iowa leads in corn, oats, timothy, clover, hogs, cattle)

Augst 7th 1912.

Mr. James L. Johnson  
Manson Iowa

Dear Sir;

Your letter Rec'd Now Mr. Johnson I am telling you off very easy. When I only am asking you my expence of \$34.00 to(?) Ills(?). Now I will Tell you you have knocked me out of my commisions of selling this farm. I had a buyer for this place when you were carrying those contracts around, and even after they were

signed up I gave you 2 days. Just to be fare with you, the other man went away and went elsewhere. the farm has since been sold by other parties. and through your Backing out after a fare bargain had been made. I have only asked you for my Expences while I ought to ask you for the commission also which I have lost through you. Now pleas dont delay in this matter. If you wish to get out for \$34.00, If your son comes up pretty soon I can give him a good bargain on a farm to Rent but must act at once.

Yours truly,  
Albert Mitchell

(The following letter is enclosed in a letter addressed: Mr. James L. Johnson, Manson Iowa. The return address: Nixon Township High School, Weldon, Illinois, R.H.J....The letterhead on the letter: WELDON PUBLIC SCHOOLS, Roy H. Johnson, Supt., M. K. Summers, President, P. M. Smallwood, Clerk, Chas. A. Gale, Director, Lillian Robinson, Grammar Department, Nelle Benson, Second Intermediate, Lou Danison, Supervisor of Music, Margaret Isenhour, First Intermediate, Dora Despain Primary)

Weldon, Illinois  
Dec. 10, 1916

Jim: I recieved your letter of the 2nd inst. with notice of increase of apportionment enclosed and while I was very glad to hear for you, I certainly was sorely disappointed to learn that I am again to be bled for another \$100. It seems that it is utterly impossible for me to save enough money to keep up the expenses on that place. It certainly has been a sad business for me. Nothing but a place to spend my money and to get no returns.

Now Jim the law under which our Township High School was operating has been declared unconstitutional by the supreme court of Ill. and I have not collected one cent of pay as yet this year. I have now \$16 in the bank to keep my family on until March and it may be that I shall be unable to collect it then. I think that you can plainly see my condition.

Now when our rent falls due on the 1st of Jan. you collect all of it, take out \$100 of my \$250 for yourself to repay you what you paid for me on the increased assessment, and keep the other \$150 until the 1st of March and if you will then pay our interest which is \$500 I shall send you the \$100 together with my half of the taxes as soon after the 1st of March as I can get it together. It it should so happen that I am beaten out of my salary, I shall try to borrow enough to repay you and ask you to sell the place jsut as soon as possible.

I received a bill last eve. from Renter for lumber etc for the door the darn fool bot a glass door for that old house. I shall not pay them before the 1st of March, if he gets the money before that he will probably let me know. Did you ever hear any more from your buyers for the place and if so what did they say about \$100 per A.?

I was glad to learn that you had a good crop of corn.

The producer is certainly in the swim now but the salaried man is about to starve to death and things look worse.

The great opportunity for the farmer is at hand while the war lasts.

Yours,  
Roy

(These letters will be concluded in the next issue)

\* \* \* \* \*

## SURNAME FILE

(An alphabetical list of the surnames submitted to the Member's Surname File located in the CCGS Library)

- ANGELL Geraldine 1915-\_\_\_\_, IL, CA, WA m James GILMAN; G. Nelson 1892-1950, MO IL, CA, m Lulu MARTIN; John W. 1837-1892 NY, MO, m Helen WILLIAMS; Nelson I 1810-\_\_\_\_ NY, m Jane LASHER; Isreal 1775-1821 RI, NY m Hannah BROWN; Isreal (Col.) 1740-1832 RI, m Martha ANGELL; Oliver 1717-1799 RI, m Naomi SMITH; Hope 1685-1759 RI, m Lydia OLNEY; Martha 1747-1793 RI, m Isreal ANGELL; Stephen 1705-1772 RI, m Martha OLNEY; John 1677-1744 RI, m Mary STANLEY; John 1644-1720 RI, m Ruth FIELD; Thomas 1616-1694 Eng, RI, m Alice ASHTON; James \_\_\_\_-1630 Eng, m \_\_\_\_ HONEYCHURCH; William \_\_\_\_-1629 Eng, m \_\_\_\_ HALSEY.  
Geraldine Gilman 15411 E. Mill Plain, C14, Vancouver, WA 98664
- ANLAUF Franz b 1826 Prusia, Ger, d 1918 OR, m Agnes SUTHAN; Hermman b 1853 Saxony, Ger, d 1928 CA, m in OR Theresa KNEBEL.  
Mrs. Lorie Okel 18625 N.E. August Ave, B ttle Ground, WA 98604
- ANNO Sarah b ca 1790, m Richard RITTER.  
Donna Larson Rt 1, Box 446 Amboy, WA 98601
- ANTWERP Annatje Van 1718-1750 NY, m Ludavicus GROAT.  
Lorena Lash 1401 Chinook St, W, The Dalles, OR 97058
- APPEL St Clair Co, IL  
Pat Lieb 617 N.E. 83rd St, Vancouver, WA 98665
- APPLEBEE Mary E. b 1887 MA, m Lewis E. ALDEN; George Wm b 1860 NH, m Mary J. BOMFREY; William H. b 1831 NH, m Susan MILLER in NH.  
Carolyn Comer 314 Omaha Way, Vancouver, WA 98661
- APPLEGATE May 1868-1913 CO, m John FENWICK Jr.; \_\_\_\_ IL.  
Vivian Davis 12119 N.E. 28th St, Vancouver, WA 98662
- APPLEGATE KY ca 1800, OR 1845.  
Jo Landers 3110 "Z" St, Vancouver, WA 98661
- APPLETON Mary \_\_\_\_-1629 Eng, MA m Robert ROYCE; Thomas 1538-1603 Eng, m Mary ISAAC; John Eng.  
Geraldine Gilman \*\* See ANGELL.
- ARLEDGE Alexander R. 1832-1927 IL, m Julia A. PETERS; L. H. KY, VA, m Jane \_\_\_\_  
B. L. Prill 3707 O St, Vancouver, WA 98663
- ARMISTEAD Anthony of Eng, m Frances THOMPSON; William 1610-bef 1660 Eng, VA Col. John - VA: Judith b VA, d 1699, m Robert "King" CARTER.  
Kitty R. Oman 8701 N.E. Pierce Dr, Vancouver, WA 98662
- ARMS IN, IL  
W. J. Jenkins 1208 Ogden Ave, Vancouver, WA 98661
- ARMSTRONG William b 1789 PA, m Sabrina TAYLOR; Robert H. b 1836 KY, m Alice LEEPER; Nancy Moody b 1894 TX, m William Ethan GRAHAM  
Jan Walker 3902 E. 16th St, Vancouver, WA 98661
- ARMSTRONG Isabella b abt 1710 MA, m Daniel NEEDHAM.  
Betty J. Holwege 6224-N. Kerby, Portland, OR 97217
- ARMSTRONG KY, 1820; IL, 1830.  
Jo Landers \*\* APPEGATE.
- ARN (AREND, AHREND) Elizabeth J. b 1859 MI, d 1938 KS, m 1877 KS to Charles J. WILHELM; Jno b 1830 Switz, d 1907 OK, m 1856 MI to Catherine KLINGENSMITH (KLINGELSCHMIDT).  
Doris L. Lewis 1142 E. Main, Battle Ground, WA 98604
- ARNOLD Joanna 1617-1692 Eng, RI, m Zacharia RHODES; William Eng, RI, m Christian PEAKE.  
Geraldine Gilman \*\* ANGELL.

\*\* Address is under another name in this section.

- ARNOLD Jean Rae b 1920 WA, m Calvin HOUGH; Alvy Martin b 1892 WA m Anna JOY; Frederick Wm 1864-1934 MI, PA, KS, MT, WA, m Selma MARTINSON; F. W. Eng, MI, m Harriet AYRES.  
Jean Hough(deceased) 2005 E. 6th St, Vancouver, WA 98661
- ASHENFELTER Mary d 1852 PA, m John HOOVER (HUBER).  
Judy Worthington 9608 N. E. Hazel Dell Ave, Vancouver, WA 98665
- ASHTON Alice 1617-1694 Eng, RI m Thomas ANGELL; Mary 1605-1678 Eng, RI m Thomas OLNEY; John Eng, m Alice HONEYCHURCH.  
Geraldine Gilman \*\* ANGELL.
- ATHERTON 1657 MA, 1713 CT.  
Mildred Finley 8205 N. E. 9th St, Vancouver, WA 98664
- ATKINS NY (Stueben Co.)  
Miss Patricia Stephens 9014 N. W. Westgate Court, Vancouver WA 98665
- ATKINSON Theodore 1615-1701 Eng, MA; John ca 1640-1664 MA; Rebecca ca 1684-ca 1770.  
Kitty Oman \*\* ARMISTEAD
- ATWELL 1800 KY.  
Lucille K. Nelson 8720 N. E. 37th Ave, Vancouver, WA
- AUDLEY Agnes Eng, m Mark WILLIAMS.  
Geraldine Gilman \*\* ANGELL
- AUGENSTEIN Margaretha m Hans DROSCHE; Joh. Friederich.  
Joan Hlousek 301 S. E. 119th Ave, Vancouver WA 98664
- AUSTIN Annes (Agnes) m Edmund LITTLEFIELD; Richard m Anes (Amis) \_\_\_\_\_.  
Mrs John J. Bell 904 W. 21st St, #9, Vancouver, WA 98660
- AUSTIN Elizabeth b 1596 Eng, d 1676 NH, m Henry TIBBETTS.  
Frances Harris 8710 Middle Way, Vancouver, WA 98664
- AUSTIN VA; KY, NC, IL 1800's.  
Jo Landers \*\* APPLGATE
- AUTREY (AUTRY) Dock Henry b ca 1857 TN; Jasper; Commadore Autrey b 1877 TN, d 1960; Dock Henry b 1897 NC.  
Sandra I. Autrey 3210 Old Lewis River Rd, Woodland, WA 98674
- AUTREY Cornelius Powers b 1822 AL, d 1896TX, m 1843 AL to Frances Mae SANDERSON; Martha Ann b 1851 AL, d 1914 TX, m 1867 TX to Robert Charles Boyd CHAMBERS.  
Mrs Robert Chambers 58814 N. E. Washougal River Rd, Washougal, WA 98671
- AYERS Edith Gertrude b 1904 WA, m Raymond GROAT; Marvin William 1867-1904 IL, WA m Florence WILLIAMS; John Stephen 1836-1915 KY, KS, m Lucinda ROGERS; Samuel Hale d 1848 VA, MO, m Lucinda BANDURANT.  
Lorena Lash \*\* ANTWERP
- AYRES Harriet b Eng, m F. W. ARNOLD.  
Jean Hough \*\* ARNOLD
- AYRES Jane b 1811 TN, d 1835 TX, m 1846 to John Henry CHAMBERS.  
Mrs Robert Chambers \*\* AUTREY
- AYERS IL, NC, TN, KY 1800's.  
Jo Landers \*\*
- BABCOCK MA.  
Doris M. Gressitt 20613 N. E. 183rd Ave, Battle Ground, WA 98604
- BACHELDER NH.  
Evelyn W. Maloney 2722 E. McLoughlin Blvd, Vancouver, WA 98661
- BACKUS Tillamook Co, OR; Yakima Co, WA.  
Kim Sauer 11221 N. E. 192nd Ave, Brush Prairie, WA 98606
- BACON Stanstead Co, Quebec, Can; CT, MA  
Doris M. Gressitt \*\* BABCOCK
- BAILEY Susan Jane b 1849, m John Richard SWOPES.  
Gwendolyn Rose 22825 N. E. 92nd Ave, Battle Ground, WA 98604



# Ancestor Chart of member Gleria J. Holverson

Continued from Winter 1981 issue:

- 39. DEAN, Nancy Pamela Ann, b 18 Dec 1805 S.C.; d. 1886, Houston Co., Tx.
- 42. CLAYTON, Henry W.
- 43. RAYFORD, Ann.
- 44. SIMS, (Capt.) John Millage b. Ireland (?); d. Georgia (?).
- 46. RHODES (RODE), John b. 1785/86, NC (?).
- 48. McMURRY, William b. ca 1725, N. Ireland; m. before 1752 Ireland or Virginia d. before 1798, Botetourt Co., VA.
- 49. -----, Mary or Agnes; d. after 1772, Botetourt Co., VA.
- 52. RIGGS, Zadoc b. ca 1753, Morris Co, NY; d. 1846 Missouri.
- 53. -----, Sarah ?
- 54. BETTY, -----.
- 55. CAMPBELL, Margaret.
- 56. MURPHY, John Sr., b. 12 Jun 1752, Halifax Co., Va.; m. 8 Feb 1774; d. 14 Aug 1818, Warren Co, Ky.
- 57. COOKE, Rachel b. 17 May 1653, Culpepper Co., VA; d. 3 Feb 1832, Warren Co., Ky.
- 58. FERGUSON, James.
- 59. McDOUGAL, Mary (?).
- 60. DOUGHTY, Daniel b. 16 Aug 1765; m. 5 Feb 1787; d. before 1831 Warren Co, Ky.
- 61. HOLCOMB, Susannah.
- 62. WRIGHT, Jacob. d. S.C. (?).
- 63. Waters, Miss -----.
- 68. NARD, Jeremiah.
- 76. TOWNSEND, Thomas b. ca 1765, S.C.; m. Jan 1795, SC; d. 18 Oct 1828 Jefferson Co, FL.
- 77. STAPLETON, Elizabeth of Marlboro Co, SC; d. Ga.
- 104. RIGGS, Timothy, b. ca 1723, nr Newark, NJ; mar. Morris Co, NY; d. Surrey Co, NC?.
- 112. MURPHY, Rev. William, b. 1732 Spotsylvania Co, VA; m (1) 1750 Martha Hodge m (2) bef Jul 1767, Granger, Ta Sarah Barton; d. Oct 1799 Barren Co, Ky.
- 113. HODGE(S), Martha b. ca 1730/33; d. ca 1761.
- 114. COOKE, (Sgt) William b ca 1720/25, Va; m. Virginia; d. 1780/81 Franklin Co, Ky.
- 115. GREENE, Margaret d. 1798, Franklin Co, Ky.
- 120. DOUGHTY, Jeremiah b. ca 1740 NJ?; m (1) -----; m (2) 29 Aug 1811, Warren Co, Ky.
- 121. -----, Sarah. (2) Susannah Stovall.
- 152. TOWNSEND, Light b. Va?, Pittsylvania Co(?).
- 153. -----, Delilah (traditional).
- 208. RIGGS, Samuel b. ca 1681 nr Newark, NJ; d. 1770.
- 224. MURPHY, William b. No. Ireland; md. Ireland; d. Spotsylvania Co, Va (?).
- 225. -----, "Eleanor". Md (2) Gideon Smith.
- 228. COOKE, William I, b. ca 1700, England.
- 229. GRIFFIN, Anne (?).
- 417. RIGGS, Edward b. ca 1636 Roxbury, Mass; md 14 Jun 1667 Roxbury, Mass; d. after 1700 in Mass.
- 418. -----, Mary.
- 832. RIGGS, Edward b. ca 1615, England; md 5 Apr 1635, Brighton, Mass; d. 1668 Newark, N.J.
- 833. ROOSA, Elizabeth, b. England or Mass.
- 1664. RIGGS, Edward b. ca 1590, England; md. ca 1612/13 England; d. 1672 Mass.
- 1665. -----, Elizabeth b. England; d. Aug/Oct 1635, Roxbury, Mass.

Ancestor Chart of member Doris MAC KELLAR Gressitt,  
20613 N. E. 183rd Ave., Battle Ground, Wa 98604.

1. MAC KELLAR, Doris Free, b 12 Feb 1923; m 18 May 1946; res Pa, SC, West Coast, md John Gressitt.
2. MAC KELLAR, William Alan b. 10 Jun 1902; md 8 Mar 1922 Ardmore, Pa; d. 31 Aug 1960, Res. Pa, SC.
3. SPEERS, Mary Stewart b. 28 Aug 1901.
4. MAC KELLAR, Herbert b. 24 Apr 1874; md Pa; d. 3 Jun 1937, r Philadelphia, Pa.
5. FREE, Mabel Colehower b 8 Jul 1881, Philadelphia, Pa; d. 22 Jan 1936.
6. SPEERS, Samuel b 5 Apr 1872, md. Glasgow, Scotland; d. Sep 1949; r Scotland, Pa.
7. BLACK, Sara Ann b 27 Sep 1878; d 9 Aug 1943.
8. McKELLAR, Charles md 19 Oct 1867, Clerkenwell, Co, Mid., Eng; res Scotland.
9. HOLFORD, Alice.
10. FREE, William Henry b 1846; md Pa; d. 1906; r. Pa.
11. COLEHOWER, Rachel b 1850; d 1924.
12. SPEERS, James d. 6 Mar; r. Ireland, Scotland.
13. STEWART, Mary d. 21 Sep 1914.
14. BLACK, James res Scotland.
15. GUTHRIE, Nancy.
16. McKELLAR, John md Dundee, res Scotland.
17. ROBINSON, Margaret.
18. HOLFORD, John res England.
22. COLEHOWER, Henry Garner b 1824, md 18 Dec 1845; d. 15 Nov 1856, res Pa.
23. JONES, Eliza b. 16 Apr. 1824; d. 24 Feb 1885.
32. McKELLAR, John

Ancestor Chart of John Gressitt, submitted by member  
Doris MAC KELLAR Gressitt

1. GRESSITT, John b. 8 Jul 1922, Pa; md 18 May 1946 Pa; Doris Free MacKellar.
2. GRESSITT, John Lyell b. 21 April 1887; md 15 Oct 1919 R.I.; d. 9 Feb 1965 Pa.
3. GARDNER, Louisa May b 23 Jan 1888 NY.
4. GRESSITT, John Mordecai b 3 Feb 1852 Va; m 12 Jan 1882; d. 25 May 1928 Md.
5. LYELL, Ida Augusta b 28 Jul 1856 Va; d 17 Oct 1933 Md.
6. GARDNER, Frank (Rev) b 16 Apr 1856 NY; m 1 Sep 1884 P. Q. Canada; d 9 Mar 1922 R. I.
7. BUCKLAND, Jane Celia b 17 Jan 1866 P. Q. Canada; d 15 Mar 1961 R. I.
8. GRESSITT, Mordecai B. res Va; md 22 Mar 1843 Va.
9. MUSE, Mary S. b 30 Nov 1826 Va; d Nov 1866.
10. LYELL, Samuel M. res Va; m 9 Jul 1833 Va.
11. GARLAND, Felleicia Ann.
12. GARDNER, Andrew J. b 1 Dec 1827 NJ; m 22 Aug 1853; d 7 Jun 1873 NY.
13. GEER, Mary Elizabeth b 28 Nov 1830 NY; d 7 Jan 1907 NJ.
14. BUCKLAND, Norman C. b 10 Apr 1840 P.Q. Canada; m 3 May 1865 P.Q. Canada; d. 31 Jul 1871 P. Q. Canada.
15. BACON, Helen Rosalie b 17 Mar 1845 P.Q; d 3 May 1932 R.I.
18. MUSE, Henry d 26 Dec 1836.
19. CLARK, Anne b 1801; d 7 May 1882, res Va.
20. LYELL, John.
22. GARLAND, Vincent, Jr.; m 4 Jun 1808, res Va.
23. JACKSON, Betsey.
24. GARDNER, Timothy Peck b 26 Dec 1784 NJ; md 29 Sep 1807; d 5 Jul 1855 NY; res NJ and NY.
25. PEER, Jane b 26 Dec 1787 NJ; d 14 Feb 1855 NJ.
26. GEER, Ebenezer b 28 Mar 1783 CT; m 13 Feb 1820; d 6 May 1860 NY, r Ct; NY.

27. MARSHALL, Elathea b 23 Oct 1790 ; d 10 Jun 1885.
28. BUCKLAND, Wm. Ashbel b 9 Feb 1804; d 31 Jan 1886, r Vt, P.Q. Canada.
29. HEATH, Clarissa b 16 Nov 1808, d 22 Oct 1890.
30. BACON, Daniel Sweatland b 22 May 1811; d 4 Oct 1889, r P. Q. Canada.
31. MCGAFFEY, Louisa Locke b 18 Jun 1818, P.Q. Canada; d 8 Apr 1894, P.Q. Canada.
38. CLARK, Spencer or William.
39. OWEN, Nancy.
40. LYELL, John.
44. GARLAND, Vincent.
45. -----, Elizabeth.
48. GARDNER, David b 24 Jan 1743 NJ; m 7 Jan 1766; d 20 Nov 1818 NJ.
49. PECK, Abigail b 18 Feb 1744 NJ; d 2 Mar 1834 NJ.
50. PEER, John r NJ.
52. GEER, Abel b 20 Jan 1735; m 5 Feb 1766 Ct; d 4 Aug 1816.
53. FITCH, Esther, b ca 1733 Ct; d Apr 1825.
54. MARSHALL, Nathaniel b 18 Dec 1772; d 27 Dec 1847 NY.
55. BOWEN, Mary.
56. BUCKLAND, Walter b 12 Dec 1769 Ct; m 11 Jul 1790; d 7 Apr 1833 P.Q. Canada.
57. SNOW, Elizabeth b May 1769 Ct; d 28 Apr 1852 P.Q. Canada.
58. HEATH, John (Capt.) b 15 Apr 1771 NH; d 20 Jan 1846 P.Q. Canada.
59. MOSHER, Margaret b 20 Jan 1771 Ct; d 20 Jan 1857 P.Q. Canada.
60. BACON, Daniel Jr. b 1773; d 1813 P. Q. Canada.
61. SWEATLAND, Mary b 1774; d 1 May 1834 Canada.
62. MCGAFFEY, William b 21 Nov 1789; d 12 Sep 1855 P.Q. Canada.
63. QUIMBY, Mary b 1799; d 5 Jun 1881 Vt.
78. OWEN, Christopher.
80. LYELL, Jehnathan.
88. GARLAND, William d. 1766, res Virginia.
96. GARDNER, Gerahom.
98. PECK, Timothy b 1709; d 27 Oct 1797, r NJ.
99. MORRIS, Phebe b ca 1704; d 1757 NJ.
104. GEER, William b 4 Jan 1713; m 10 Dec 1733; d 5 Feb 1772; of Ct.
105. (1) -----, Esther.
112. BUCKLAND Alexander b ca 1739 Ct; d 1815.
113. SMITH, Sarah b ca 1738 Ct; d 19 Jan 1823.
114. SNOW, Nathaniel (Capt) r Tolland Co, Ct.
118. MOSHER, Michael b 5 Jun 1732 Ct; d 25 Sept 1823 P.Q. Canada.
119. PIERCE, Zilphia b 19 Jun 1746, Ct; d. 4 Mar 1830 P.Q. Canada.
120. BACON, Daniel, Sr., b NH; d P. Q. Canada.
121. JONES, Esther, d. P. Q. Canada.
122. SWEATLAND, Jeel b 13 May 1745 Ct; m 26 Sept 1771.
123. JAYNES, Mary b 1745 Ct.
124. MCGAFFEY, Jehn b 21 Nov 1761 NH; d 1857 P. Q. Canada.
125. TRIPP, Belle.
126. QUIMBY, John b 1769 NH; d 3 Mar 1860 P. Q. Canada.
127. MOORE, Mary b 1774; d 26 Nov. 1838.
156. OWEN, Augustine r Urbanna, Va.
160. LYELL, Jehn r in 1708 - took ship "Susanna" to Carolina or Virginia.
192. GARDNER, John b 1651, d Feb 1720.
193. WARD, Abigail b 4 Jun 1658 Ct; d 1706.
196. PECK, Joseph, Jr; b 9 Oct 1675 Ct; d 1746.
197. BALL, Lydia d 1742.
208. GEER, Daniel b 1673; d 2 Oct 1749.
224. BUCKLAND Jonathan b 1716.
225. BURNHAM, Sybil.

244. SWEATLAND, Johnathan b 1707 Mass; m 7 Nov 1732; d 22 Sep 1769 Ct.  
245. PUMMERY, Hepseba.  
246. JAMES, Elisha b 1715.  
247. DIMOCK, Mary (widow).  
248. McGAFFEY, John b 6 Mar 1728; d Aug 1810 Vt.  
249. McCLARY, Jane.  
320. LYELL, Walter of Dysart.  
321. HAMILTON, Margaret of Borland.  
386. WARD, John.  
387. -----, Sarah.  
392. PECK, Joseph b 5 Sep 1647; m 28 Nov 1672; d 1720.  
393. ALLING, Sarah.  
394. BALL, Edward.  
395. BLATCHLEY, Abigail.  
416. GEER, George b 1621; m 17 Feb 1658; d 1726, r ENG, CT.  
417. ALLYN, Sarah b ca 1640; d ca 1723.  
448. BUCKLAND, William b 1650; d 12 Dec 1725; r Ct.  
449. HILLS, Elizabeth b 1669 Mass.  
488. SWETLAND, Joseph b 5 Nov 1683; m 13 Feb 1704; d 6 Sep 1749; r Mass.  
489. BABCOCK, Mercy.  
492. JAMES, Benjamin b 30 Sep 1672; d Ct.  
493. -----, Hannah.  
496. McGAFFEY, Neil b 3 Jan 1685; m 4 Nov 1725; d 1737, r Ireland, US after 1730.  
497. McCLARY, Margaret.  
640. LYELL, James.  
641. HAY, Jean.  
773. -----, Joyce (widow) b Rutland Co, ENG; d 1640 Ct.  
784. PECK, Henry d Nov 1651; r Ct.  
785. -----, Joan.  
786. ALLING, Roger d 27 Sep 1674; r New Haven 1639.  
787. NASH, Mary b Eng; d 16 Aug 1683 New Haven.  
790. Blatchly, Thomas d ca 1674 Boston, Mass; r New Haven 1643.  
791. -----, Susanna.  
832. GEER, Jonathan of County Devon, Eng.  
834. ALLYN, Robert d 1683 Ct; of Salem 1637.  
896. BUCKLAND, William b ca 1628; d 13 May 1691 Ct.  
898. HILLS, Gershom b 27 Jul 1639; m 11 Nov 1662; r Malden, Mass.  
899. CHADWICK, Elizabeth b 1 Apr 1648.  
976. SWETLAND, William of Salem, Mass; 1676.  
977. -----, Agnes.  
984. JAMES, William b 1610 Essex, ENG; d 20 Sep 1690 Mass; m (1) Mary.  
985. BROUGHTON, Hannah (BASCOT) - widow- second wife.  
992. McGAFFEY, John.  
993. McCRILLIS, Margaret b Londonderry, Ireland; d 14 Mar 1682.  
1280. LYELL, Alexander of Balmaleadie.  
1281. CARNEGIE, Christian of Kinnaird.  
1574. NASH, Thomas b ENG; d 12 May 1658; r New Haven 1643.  
1575. BAKER, Margary d 11 Feb 1655.  
1792. BUCKLAND, William b Weymouth, ENG; d 1 Sep 1679 CT; r Plymouth, Mass 1635, of East Hartford, CT.  
1793. BOSWORTH, Mary.  
1796. HILLS, Joseph b 1602 Malden, ENG; d 5 Feb 1687 Ct.  
1797. (1) DUNSTER, Rose d 24 Mar 1650.  
1798. CHADWICK, John b ca 1601 ENG; d 1681.  
1799. -----, Joan d 11 Jul 1674.  
1970. BASCOM, Thomas b Dorchester, ENG; d May 1682, Mass.

1971. -----, Avis d 1676.  
 1984. McGAFFEY, Neil.  
 1985. MILLER, Marion.  
 1986. McCRILLIS, Andrew r Londonderry, Ireland.  
 2560. LYELL, William.  
 2561. FALLOE, ----- of Craiginstown.  
 3150. BAKER, Nicholas b ENG; d 11 Feb 1656.  
 3151. HODGETTS, Mary.  
 2586. BOSWORTH, Edward.  
 3592. HILLS, George.  
 3968. McGAFFEY, John.  
 3967. BAXTOR, Margaret.  
 5120. LYELL, James of Baldnagno and Belmaleedie.  
 5121. FALCONER, ----- of Halkerton.  
 6300. BAKER, John.  
 6301. MADISTARD, Margery.  
 10240. LYELL, James of Baldnagno.  
 20480. LYELL, William.  
 20481. DeRAMOGNEY, Helen.  
 40960. LYELL, Henry.  
 40961. LYLE, Agnes of Middlepennyland.  
 81920. LYELL, Henry I of Murthill, r ca 1375.  
 163840. LYELL, John.  
 163841. RAMSEY, Catherine.  
 327680. DeLYELL, John.  
 327681. FORRESTER, -----.  
 655360. DeLYELL, John b deBlado.  
 1310720. DeLILE, Alexander de b Comte de; d Perth; r ca 1260.  
 2621440. DeLISLE, Baldwin.

Ancestor Chart of member Richard N. Grafton  
 401 N.W. 8th Street, Vancouver, Wa 98665

1. GRAFTON, Richard Norman b 29 Dec 1924, Portland, Or.
2. GRAFTON, Rodney Vernon.
3. PARKER, Dorothy Belle.
4. GRAFTON, Harry Nathaniel b 7 Sep 1867 Lima, Ohio; m 29 Nov 1893; d 20 Aug 1914, Portland, OR.
5. GRAY, May Alice (Alice May?)
6. PARKER, Samuel Franklin b 1853 Salem, Marion Co, OR; m. 22 Jan 1898; d. 1936 Milwaukie, Clackamas Co, OR.
7. SUNDERMEYER, Anna "Annie" b. Apr 1866 Etlah, Missouri; d Woodburn, Marion Co, OR.
8. GRAFTON, Salem b 16 Oct 1808 Dublin, Maryland; m 1860 (2nd mar) ; d 11 Jan 1884 Kenton, OH.
9. DAVENPORT, Mrs. Susan CROSS b 14 Oct 1838 Westmoreland Co., OH; d Nov 23 1875 New Albany, OH.
10. GRAY, Franklin Benton b 18 Sep 1840, Peoria, Il; m 18 Dec 1871, Portland, OR; d 18 Oct 1925, Salem, Marion Co, OR.
11. NICHOLS, Margaret Jane (Ennis) b 10 Mar 1842 Maryland; d 30 Jan 1923 Russellville, Multnomah Co, Or.
12. PARKER, Samuel b 1799 Franklin Co Va (W.Va); m Nov 1846 (2nd wife); d 1886 Aumsville, Marion Co, OR.
13. SPEARS, Rosetta (English) b 1817, Tenn; d 1888 Aumsville, Marion Co, OR.
14. SUNDERMEYER, Franklin d 1884, Missouri.
15. ----- (Schowe?), Willimina d before 1876, MO.

16. GRAFTON, Nathaniel b 1760 Maryland.
20. GRAY, Neely.
21. SILL, Delilah Jane
22. NICHOLS, N.

Ancestor Chart of member Doris LOVELL Lewis  
1142 E. Main, Battle Ground, Wa 98604

1. LOVELL, Doris L. b 10 Dec 1939, Shattuck, OK; m. 15 Feb 1964 Pierre SD to Robert Darwin Lewis.
2. LOVELL, James Earl b 5 Apr 1912, Beaver Co, Ok; m 29 Jul 1933 Beaver Co, OK.
3. HAMMOCK, Blanche Elizabeth b 22 Nov 1916, Ellis Co, OK.
4. LOVELL, James Millard b 17 Jun 1884 Sullivan Co, MO; m 25 Nov 1909 OK; d. 11 May 1947 Clinton, OK.
5. DENNIS, Kathryn Jeanette b 9 Sep 1889 Milan, MO; d 16 Mar 1978 Shattuck, OK.
6. HAMMOCK, Charles Edgar b 14 Oct 1875 Windom, KS; m 23 Dec 1896 Lyons, KS; d 31 July 1963 Shattuck, OK.
7. WILHELM, Laura Belle b 7 Jul 1878 Salina, KS; d 24 May 1957 Woodward OK.
8. LOVELL, James Israel b 1854; d 1936. Bur Gage, OK.
9. WEST, Martha Roanna b 1861; d 1944. Bur. Gage, OK
10. DENNIS, John b. Ohio; m 17 May 1874.
11. BLACK, Susan.
12. HAMMOCK, LEWIS b 28 Mar 1846 Ind; m 4 Mar 1866 Wayne Co, Iowa; d 24 Oct 1928 Chaney, OK.
13. DEAN, Francina b 3 Dec 1848; d 5 Aug 1906 McPherson, Kans.
14. WILHELM, Charles Joseph b 5 Oct 1845 Germany; m 30 Apr 1877 Salina, Kans; d. 27 Jan 1896 Windom, Kans.
15. ARN, Elizabeth b 12 Dec 1859 Hillsdale Co, Mich; d Mar 1938 Windom, Kans.
16. LOVELL, David.
17. MEANS, Matilda.
18. WEST, Alexander
19. MEANS, Martha.
24. HAMMOCK, George.
25. MILLER, Elizabeth.
30. ARN, John.
31. KLINGENSMITH, Catherine.

Ancestor Chart of member Shirley BRINK Rask  
1912 "E" Street, Vancouver, Wa 98663

1. BRINK, Shirley b 17 Jan 1911, Spokane, WA; m 26 Aug 1932, Seattle, WA G. Harry Rask.
2. BRINK, Harry Sherman, b 10 Dec 1873 Springfield, OR; m 15 Dec 1896 Farmington, WA., d 15 Dec 1944 Spokane, WA.
3. McFARLAND, Bessie Eulalia b 5 Jun 1874, Elma, WA; d 4 Nov 1944, Spokane, WA.
4. BRINK, Levi b 10 Nov 1835, Richland, OH; m. 31 Mar 1864 Marietta, IL; d 9 Dec 1909 Farmington, WA.
5. HARRIS, Matilda b 27 August 1840, Fulton Co, IL; d 8 Feb 1929, Spokane, WA.
6. McFARLAND, Wm. O. J. b 1833 Missouri; m. 10 May 1870, Elma, WA; d 16 Oct 1880 Grays Harbor, WA.
7. SLOVER, Susanna Maria b 10 Oct 1854, Oregon City, OR; d 13 Jun 1937 Montesano WA.
8. BRINK, Harry Sherman.
9. GOLDSMITH, Mary.
10. HARRIS, Thomas b 25 Oct 1808 Licking Co, OH; d. 19 May 1887 Farmington, WA; m 31 Mar 1831, Fulton Co, IL.
11. SINNETT, Rachel b 17 Jan 1815, VA; d 10 Oct 1893 Farmington WA.

To be continued.....

Q U E R I E S

Queries are accepted free from members and non-members alike and will be run in each Trail Breaker as space permits. In receipt of an answer to your queries, please show your appreciation with a note of how the information helped you and/or a 20¢ stamp. I will convert your queries using the following abbreviations along with the abbreviations listed in the 1982 Directory for the Clark County Genealogical Society:

anc - ancestor	dau - daughter	m - married
b - born	desc - descendant	mor - mother
bap - baptized	exg - exchange	post - postage
betw - between	fa - father	PQ - Province of Quebec
bro - brother	fam - family	pts - parents
bur - buried	gen - genealogy	rec - record
ca - circa (approx.)	grgrfa - great grandfather etc.	res - resided
cem - cemetery	info - information	sib - sibling
Co - County	LC - Lower Canada	sis - sister
d - died	UC - Upper Canada	unkwn - unknown

\*\*\*\*\*

## YOUNGS

I would appreciate any info on Abram (Abraham) Youngs, b ca 1788 U.S. and his wife Susannah b ca 1790 U.S. By 1826 they lived near Simcoe, ONT. Children: Nancy, Thomas, John W. were b in CAN. Possible older children are Bennett b NY, David b U.S., and Abram O. Youngs b CAN.

RITTER  
ANNO

Would like any info on the fam of Richard Ritter, b 4 Jan 1798 (probably KY) m Sarah Anno. Their dau Harriet Ritter was b in Mason Co KY. Will return post.

ADDLEMAN  
COX  
HAYES

I need pts and first husband of Mrs. Lucinda (Addleman) Cox b 20 Sep 1835 IN, m Charles J. Hayes 1868 in LaCrescent, MN. Can share info on Hayes fam of Greene and Chenango Co, NY.

Donna Larson - Rt. 1 Box 446 - Amboy, WA 98601

\*\*\*\*\*

WILSON  
LYNN

Would like info on John Simeon Wilson, b 12 Mar 1783 where? In KY? He m Nancy Lynn 10 Apr 1808 in Madison Co, KY. They had 11 children. The fam moved to Morgan Co, IN 1827-1835 then Fulton Co, IL 1836-1853; some went to Decatur Co, IA. My grgrfa was John Patrick Wilson, m Sarah Ann Stanger in Fulton Co, IL, 1840. Sarah b NC or SC on 1 Sept 1818.

## STANGER

PALMQUIST  
SWENDSON  
PALMBLAD

Want info on Carl August Palmquist b 1831 (where in Sweden) m Gustava Swendson. Their children: John August b 1860, Augusta S. (m John Palmblad), Emil b 1871 in Pottawatomie Co, KS. All lived and bur near Gresham, OR.

MC CARTY  
COLLINS  
MC MANNUS  
ROONEY

Looking for info on the following: Abbie McCarty b 31 July 1824 near Tralee, IRE, m Morris Collins. Fam moved to Ontario, CAN in 1847 then to MI in 1879. My grfa Patrick Collins m. Catherine Jane McMannus, dau of John McMannus and Mary Ann Rooney, 1873 in Ontario, CAN. I know where all the above people mentioned were bur except John McMannus and Mary Ann Rooney. Can exg most Wilsons. Post returned.

Hazel Ketterling - 2613 N.E. Whitman Ave. - Vancouver, WA 98662

\*\*\*\*\*



ALLPHIN GRAY Who were the pts, sis, bro of Mattie (Allphin) Gray? She was b 25 June 1875, Corvallis, OR, m William Franklin Gray 24 Dec 1879, Corvallis, OR, d 27 Feb 1966, McMinneville, OR.

SLAGEL/SCHLEGEL/HARRISON Would like info on either husband of Ida May Eldora (Gray) (Slagel/Schlegel) Harrison; b 15 Jan 1881/82 in OR d 22 May 1967 Portland, OR. 1st m William Slagel/Schlegel 24 Dec 1902, he d before Feb 1912. 2nd m Harry Harrison on 3 Feb 1912; he was b 3 Sept 1883 and d 20 Dec 1967.

GRAY MILLER Bessie Francis (Gray) Miller: b 9 July 1884 in Multnomah Co OR, d after 1970, where bur and when. She m Waldo Miller 17 June 1906. Need info on him also.

GRAY DALY Where and when did Priscilla May (Gray) Daly, b 22 Oct 1839 in Knoxville, IL d? She m William Daly 17 Dec 1857 in Portland, OR, they had 4 children, what were the names? Would like more info on Wm Daly who d Portland, OR 11 June 1914.

NICHOLLS INNES Prof. Wm. T. Nicholls: Early youth in Pike Co, IL, studied music in Chicago under Fredrick Innes. Became Director of Albany, OR High School bank in 1923. He d Sept 1933 in Albany, OR. Need info on both Innes and Nicholls.

All post will be refunded promptly.

Richard N. Grafton - 401 N.W. 85th St. - Vancouver, WA 98665

\*\*\*\*\*

COLLINS MARSH ADAMS I am missing at least two generations betw John Collins, b 1766 in Enfield, Hartford Co, CT and d 1826 at Chardon Geauga Co, OH (m Fanny Marsh) and Reverend Nathaniel Collins b 1677 Medfield, Norfolk, MA d 1759 at Enfield, m Alice Adams.

MARTIN DUNHAM PYATT BONHAM Ephraim Martin b 1808 Piscataway, NJ; d ca 1787, m Eunice Dunham. She was b 1715 d ca 1737. Was her fa Jonathan Dunham, mor Joan Pyatt and grpts Edmund Dunham and Mary Bonham? Need particulars.

Geraldine F. Gilman - 15411 E. Mill Plain, C14 - Vancouver, WA 98664

\*\*\*\*\*

ROBISON MC MILLEN MILLIGAN SMITH Need pts and sib of John Robison, b July 1799 Franklin Co, PA d 27 Aug 1870 Jackson Co, OR, m Ross Co, OH to Susan Milligan dau of Hugh and Ellen (McMillen) Milligan. The only info I have is John's fa name is James. James' fa is Andrew and his mor is Margaret Smith, dau of James and Jennet Smith. I need dates of all of the above.

MORELAND ROBISON Need info on Thomas Moreland b ca 1825 in KY, d July 1903 Seattle, WA, m Ellen or Margaret \_\_\_\_\_. Had dau named Elizabeth b Nevada Co, CA July 1855. Elizabeth (Lizzie) m Milan Robison June 1888 McCoy, Polk Co, OR

WEDGWOOD KELLY Looking for pts and sib of Amaziah Wedgwood b March 1804 in ME, d Grand Rapids, MI 1900, m Elizabeth Kelly. He moved to OH in 1850, then to MI in 1854.

ELLIS SCHOONOVER Interested in info about pts of Persis Ellis (Jesse & Sarah (Schoonover/Ellis). Persis b Apr 1847 North Hampton, OH and m 1866 Grandville, MI. Jesse b Summit Co, OH and Sarah b 1830 somewhere in NY. Will exg any info I have gladly.

Cheryl Robison - 2317 N.E. 112th Ave. - Vancouver, WA 98664

\*\*\*\*\*

## I N D E X

The San Diego Sewer Records are alphabetical and are not indexed here.

Aagaard	21	Bandurant	33	Chambers	33	Ellis	41
Adams	26, 41	Barker	18, 23	Chaston	18	Ennis	6
Addleman	40	Barnett	26	Cheetham	24	Ercke	11
Alden	32	Barr	24	Chenette	21	Falconer	38
Allen	26	Bartlet	23	Clark	35, 36	Falloe	38
Alling	37	Bartlett	9	Clayton	34	Farwell	26, 27
Allphin	41	Barton	34	Colehower	35	Fenwick	32
Allyn	37	Bascom	37	Collins	21, 22	Ferguson	34
Altizer	11	Baughner	10		40, 41	Fiege	27
Anderson	26	Baxter	38	Comer	32	Field	32
Andrews	4, 18	Bell	21, 33	Cooke	34	Filby	21
	19, 22	Bennett	19, 21	Coons	26	Finley	22, 33
Angell	32, 33		22, 29	Cowan	21	Fitch	36
Anlauf	32	Benson	31	Cox	27, 40	Fletcher	21
Anno	32, 40	Bernhardt	26	Crouse	11	Foote	21
Antwerp	32	Betty	34	Crutchley	8	Foreman	18, 20
Appel	32	Black	35, 39	Cunningham	11	Frach	27
Applebee	32	Blackburn	21	Curtice	27	Frasier	27
Applegate	32	Blair	26	Curtis	28	Free	35
Appleton	32	Blatchly/Blatchley		Dague	27	Funk	21
Arledge	32		37	Dahlquist	25	Gabble	21
Armistead	32	Bomfrey	32	Daly	41	Gaither	21
Arms	32	Bonham	41	Damphoffer	21	Gale	31
Armstrong	7, 32	Bort	11	Danison	31	Gallway	27
Arn	39	Bosworth	37, 38	Davenport	38	Gardner	8, 9, 35, 36
Arn (Arend, Ahrend)		Bowen	36	Davis	4, 21, 32	Garland	35, 36
	32	Bowes	26	Dean	34, 39	Geer	35, 36, 37
Arnold	32, 33	Boylan	23	DeHaven	27	Gerber	27
Ashenfelter	33	Bozarth	7	Delbeck	10	Gessen	8
Ashton	32, 33	Buckland	35, 36, 37	Delisle/DeLile	38	Gillett	25
Atherton	33	Bumpus	23	DeLyell	38	Gilman	23, 32, 33
Atkins	33	Burk	23	Dennis	39	Goldsmith	39
Atkinson	33	Burnham	36	DeRamogney	38	Goracke	18, 19, 20
Atwell	33	Burrell	23	Despain	31	Gould	21
Audley	33	Bradley	27	Dewelt	23	Grafton	21, 22, 38
Auer	6	Brant	21	Dieterle	21		39, 41
Augenstein	33	Bratton	6	Dimock	37	Graham	32
Austin	26, 33	Bredfeld	8	Dobler	10	Gray	38, 39, 41
Autrey (Autry)	33	Brink	39	Dooly	22	Greene	8, 34
Ayers/Ayres	33	Bronson	11	Dorman	21	Gregory	26, 27, 29
		Broughton	37	Doughty	34	Gressitt	33, 35
Babcock	33, 37	Brown	7, 23, 32	Downing	21, 27	Greve	7
Bachelor	33			Doyle	6	Gridley	21
Back	21	Cahill	26	Drake	27	Griffin	34
Backman	7	Campbell	26, 34	Droscher	33	Groat	32, 33
Backus	33	Cannon	11	Dunham	41	Guthrie	35
Bacon	33, 35, 36	Canutt	24	Dunlap	6		
Baggett	26	Carlson	26	Dunster	37	Halsey	32
Bahti	21	Carnegie	37	Dyer	11	Ham	27
Bailey	10, 33	Carroll	6	Eaton	27, 29	Hamblen	22
Baker	26, 37, 38	Carter	32			Hamilton	37
Ball	36, 37	Chadwick	37				

Hammock	39	Jaynes	36	Marshall	36	Olney	32, 33
Hanby	27	Jenkins	32	Martin	23, 32, 41	Olstad/Aostead	29
Hanley	27	Johnson	6, 9, 18	Martinson	33	Oman	22, 32, 33
Harshman	20, 21		22, 30, 31	Mather	8	Otis	22
Harris	7, 11, 18, 33, 39	Jones	35, 36	Means	39	Otwell	11
		Joy	33	Messenger	21	Owen	36
Harrison	41	Kalahan	21	Metz	9	Padden	21
Harvey	4	Kanaciths	7	Meyer	21, 25	Paesohel	9
Haskin	19	Kane	6, 7	Miller	6, 7, 8, 23, 38, 39, 41	Page	7
Hay	37	Keelan	23	Milligan	41	Palmblad	40
Haycraft	18	Kelly	41	Mills	21, 22	Palmquist	40
Hayes	30, 40	Ketler	10	Milner	23	Pannell	22
Hazen	10	Ketterling	40	Mitchell	30, 31	Parker	38
Heath	36	Killingsworth	24	Moody	32	Parshall	23
Hellen	10	Kinder	6	Moon	28, 29	Patterson	29
Hendrickson	27, 28	Kirkham	22	Moore	24, 29, 36	Paulson	29
Henrichsen	21	Kismalski	23	Moreland	41	Peake	32
Hensley	8	Klingelschmidt	32	Morris	36	Peck	36, 37
Hickey	28	Klingensmith	32, 39	Morrison	11	Pedesen	9, 10
Hidden	21	Knebel	32	Mosher	36	Peer	35, 36
Hieky	29	Knight	26	Murphy	34	Peters	32
Hill	23	Koplin	28	Murray	11	Peterson	7
Hills	37, 38	Krukra	28	Muse	35	Phillips	24
Hlousek	33	Kuhn	20	McAdams	28	Pierce	36
Hodge(s)	34	Kulper	9, 10	McCarty	21, 28, 40	Pitcher	30
Hodgetts	38	Kunitz	18	McClary	37	Pitsford	6
Holbrook	22	Lacy	19	McCrary	5	Porter	19
Holcomb	34	Lamb	28	McCrillis	37, 38	Price	19
Holford	35	Landers	32, 33	McDougal	34	Prill	32
Hollingsworth	7	Langsdorf	21	McFarland	39	Pummery	37
Holroyd	22	Larson	26, 32, 40	McGaffey	36, 37, 38	Pyatt	41
Holverson	19, 34	Lash	32, 33	McKay	26	Quimby	36
Holwege	32	Lasher	32	McKee	28	Rabold	19
Honeychurch	32, 33	Laurent	10, 11	McKellar/KacKellar	35	Raisey	27
Hoover (Huber)	33	Lawrence	9			Ramsey	20, 38
Hough	33	Leeper	32	McMannus	40	Ranck	21
Houghton	7, 8	Lehman	23	McMaster	21	Rask	39
Huffman	28	Lewis	32, 39	McMillen	41	Rayford	34
Hull	22	Lieb	32	McMurry	34	Reid	9, 11
Hunter	6, 27, 28	Lieser	21			Reynolds	20
Hurley	23	Lisham	6	Nard	34	Rhodes	32
Hutchens	28	Littlefield	33	Nash	37	Rhodes (Rode)	34
Hutchins	28, 29	Lockley	22	Nedry	24	Riddle	9
Hutchinson	28	Loring	4	Needham	32	Riggs	34
		Lovell	39	Needry	24	Ritter	32, 40
Indergard	28	Lyell	35, 36, 37, 38	Nelson	33	Robison	20, 31, 35, 41
Inman	22	Lyle	38	Neswal	10	Roelker	23
Innes	41	Lynn	40	Nichols	38, 39	Rogers	18, 33
Irwin	21	Madistard	38	Nicholls	41	Rooney	40
Isaac	32	Maloney	21, 22, 33	Nicolaysen	19	Roosa	34
Isenhour	31	Manily	9	Nimmo	22	Rose	33
		Manjou	7	Noland	23	Rowley	21
Jackson	23, 35	Manwell	10, 28	O'Brien	6	Royce	32
James	10	Marsh	41	Okel	32	Royse	29
Janes	37						
Jaussi	18						

Ruhr	21	Snow	36	Thomas	29	West	39
Russell	29	Somerville	22	Thompson	9, 32	White	29
Safransky	25	Spears	38	Thurner	20	Wickham	23
Sanderson	33	Speers	35	Tibbetts	33	Wilhelm	32, 39
Satterwhie	22	Spurrell	11	Tominus	7	William	7
Sauer	33	Stanger	40	Townsend	34	Williams	11, 21, 32, 33
Schechla	23	Stanley	32	Tracy	19	Willis	30
Scheel	22	Stapleton	34	Tripp	36	Wilson	10, 40
Schoonover	41	Stephens	29, 33	Tucker	23	Windle	29
Schowe	38	Stephenson	20	Tulley	21	Withers	29
Secrist	21	Stewart	35	Ulery	29	Wood	22
Seveson	7	Stovall	34	Umlatts	8	Wool	4
Shaw	21	Stowiee	8	VanAirsdale	8	Worden	29
Shepherd	20	Strevy	24	Van Ness	23	Worthington	33
Shields	24	Stubbs	24	Vohigh	7	Wright	9, 34
Sill	39	Summers	31	Voorhees	22	Wyers	29
Silvis	29	Sundermeyer	38	Waggener	29	Youngs	40
Sims	34	Suthan	32	Walker	32	Zinserling	23
Sinnett	39	Sweatland	36, 37	Walrig	28	Zumwalt	23
Slagel/Schlegel	41	Swendson	40	Ward	4, 20, 36, 37		
Slocum	24	Swetland	37	Wastradowski	21		
Slover	39	Swingle	29	Wedgwood	41		
Smallwood	31	Swopes	33	Welch	9		
Smith	9, 20, 32	Tapan	7	Wells	19		
	34, 36, 41	Taylor	6, 11, 32				

### NEW COMMUNITY SPONSOR

### OXFORD ATHLETIC CLUB

7588 Delaware Lane  
Vancouver, Washington 98664

21 YEARS IN VANCOUVER.

## Tax Records: A Common Source With An Uncommon Value



THE FREE-BORN BRITON ON A PERSPECTIVE OF TAXATION.  
Courtesy of the British Museum

You can use tax records  
in the same way you use  
census records...

IF YOU KNOW HOW.

Samples, suggestions  
and PROOF await you in  
this publication, for  
more than 65 different  
direct taxes and 20 in-  
direct taxes. And they  
all left records for you  
to search!

Order Your Copy: \$ 5.00 (\$ 5.50 post pd)

Name \_\_\_\_\_

Address \_\_\_\_\_

Family History World  
19 W. South Temple  
Salt Lake City, Utah 84101  
(801) 532-3327 or 295-1059  
quantity discounts available



VIRGINIA BOOK COMPANY  
BERRYVILLE, VIRGINIA 22611

We are presently interested in purchasing (1) books, pamphlets, broadsides and maps concerning Virginia or Virginians; (2) letters and diaries concerning Virginia, or written by Virginians or from Virginia; and (3) oil paintings, water colors, drawings, prints, lithographs and photographs of Virginia persons or places, or done by Virginians.

## Journal of the West

An Illustrated Quarterly of  
WESTERN HISTORY & CULTURE

P.O. Box 1009, 1531 Yuma  
Manhattan, Kansas 66502



**YE OLDE GENEALOGIE SHOPPE**  
INDIANAPOLIS, INDIANA 46239

Write for a  
**FREE Mini**  
Catalog  
while supply  
lasts!

9605 Vandergriff Road  
Post Office Box 39128  
Indianapolis, IN 46239

## FAMILY PEDIGREE CHART

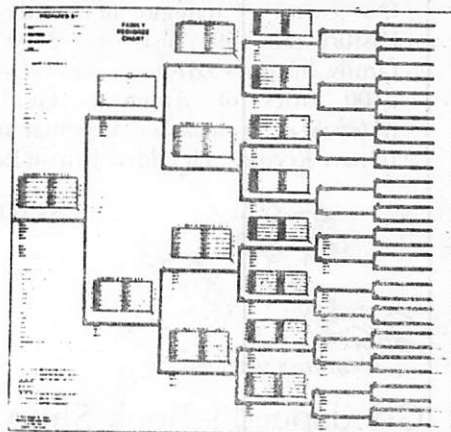

**CHET & GERI**

## YOUNG EXPLORATIONS

1901 Morgan Avenue  
Claremont, CA 91711

C. C. G. S. IS THE SUPPLIER  
FOR THESE UNIQUE CHARTS FOR  
THIS AREA. 22½" x 24",  
FOLDED AND PUNCHED TO FIT  
A STANDARD 3 RING BINDER.  
SPACE FOR BROTHERS AND  
SISTERS FOR FIRST FOUR GEN-  
ERATIONS. IF YOU LIVE  
OUT OF OUR AREA, "YOUNG  
EXPLORATIONS" WILL BE  
HAPPY TO ACCOMODATE YOUR  
MAIL ORDERS.



**GENEALOGICAL BOOKS IN PRINT**  
6818 Lois Drive  
Springfield, VA 22150

**Publisher - Genealogical & Local  
History Books In Print**

**Supplier - Genealogical forms & Books**

Write for brochure

**The Everton Publishers, Inc.**  
**P.O. Box 368, Logan, UT 84321**

7th Edition **HANDY BOOK**  
now available

## TUTTLE ANTIQUARIAN BOOKS, INC.

P.O. BOX 541  
(28 SOUTH MAIN STREET)  
RUTLAND, VERMONT 05701



### GENEALOGY AND LOCAL HISTORY

Catalog No. 1  
230 pages

Price  
\$4.00

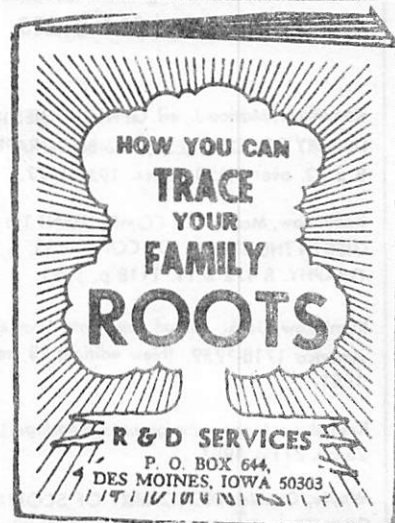

**"ROOTS" BOOKLETS: \$4.95 each**  
Quantity prices for schools,  
clubs, etc....dozen \$21.00  
**BOOKLET PRICES POSTAGE PAID**

Our current Catalogue of Family and Local History (No. 591) lists over 2300 individual family histories (*Abbey - Zabriskie*) and over 2100 titles of American Local Histories (*Alabama - Wisconsin*). Colonial and Revolutionary Records, Heraldry, British Records, etc.



\$3.00 post paid

*Anything that's a book,*

Goodspeed's Book Shop, Inc.  
7 Beacon Street, Boston, Mass. 02108

### THE AUGUSTAN SOCIETY, INC.

Post Office Box P  
Torrance, California 90507



### MAGNA CARTA BOOK CO.

5502 Magnolia Ave.  
Baltimore, Md. 21215

Kaminkow, Marion J., ed. *GENEALOGIES IN THE LIBRARY OF CONGRESS, A BIBLIOGRAPHY*, 3 vols. 9 x 12. over 2,150 pages. 1972-1977. \$175.00

Kaminkow, Marion J. *A COMPLEMENT TO GENEALOGIES IN THE LIBRARY OF CONGRESS, A BIBLIOGRAPHY*. 8 1/2 x 11. 1118 p. 1981. \$ 83.50

Kaminkow, Jack. *List of emigrants from England to America 1718-1759*. (New edition) 23 cm. 292 p. 1981 \$ 20.00

Kaminkow, Marion. *Emigrants in Bondage*. (2d printing) 23 cm. 211 p. 1981. \$ 15.00

Whyte, Donald. *DICTIONARY OF SCOTTISH EMIGRANTS to THE U.S.A.* (2d printing) 23 cm. 504 p. 1981. \$ 22.50

# KM

ENTERPRISES

351 N. Seranado St., Orange, Cal. 92669

*Research Material Specialists*

IRELAND ENGLAND WALES  
SCOTLAND FRANCE MAPS

## BOOKCRAFT

BOX 25777

SALT LAKE CITY, UTAH 84125

WRITE FOR BROCHURE

### NEWSPAPER INDEXES: A Location and Subject Guide for Researchers

Volume I 210 pages Volume II 203 pages  
by Anita Cheek Milner

AVAILABLE FROM

### SCARECROW PRESS, INC.

P. O. BOX 656

METUCHEN, NEW JERSEY 08840

\*\*\*\*\*



WRITE FOR CATALOG

## Heritage Book

3602 MAUREEN, SUITE 100, BOWIE, MD 20707



# CLARK COUNTY GENEALOGICAL SOCIETY COMMUNITY SPONSORS

\*\*\*\*\*

MINNEHAHA BEAUTY SALON  
5817 N.E. St. Johns Blvd.  
Vancouver, Washington  
98661

8 YEARS IN VANCOUVER

LEUTJEN INSURANCE AGENCY  
316 E. Mill Plain Blvd.  
Vancouver, Washington  
98660

21 YEARS IN VANCOUVER

\*\*\*\*\*

HARSHMAN CONSTRUCTION COMPANY  
2818 N.E. Littler Way  
Vancouver, Washington  
98662

4 YEARS IN VANCOUVER

TOTEM POLE RESTAURANT & LOUNGE  
7720 Highway 99  
Vancouver, Washington  
98665

52 YEARS IN VANCOUVER

\*\*\*\*\*

EMIL FRIES PIANO HOSPITAL  
2510 E. Evergreen Blvd.  
Vancouver, Washington  
693-1511

32 YEARS IN VANCOUVER

NEW YORK LIFE INSURANCE  
MAUREEN WALTERS - AGENT  
1401 "C" Street  
Vancouver, Washington 98660

20 YEARS IN VANCOUVER

\*\*\*\*\*

ATKINSON, MILLAR & INGALLS  
Insurance Agents and Brokers  
210 West 13th Street  
Vancouver, Washington 98660

71 YEARS IN VANCOUVER

BEACOCK'S VANCOUVER MUSIC  
Instruments, Lessons, Repair  
6405 East Mill Plain Blvd.  
Vancouver, Washington 98661

5 YEARS IN VANCOUVER

\*\*\*\*\*

ROYAL OAKS COUNTRY CLUB  
8917 N.E. 4th Plain  
Vancouver, Washington  
98662

36 YEARS IN VANCOUVER

EARLY CLARK COUNTY, WASHINGTON

LAND RECORDS

\*\*\*\*\*

DON BIGGS & ASSOCIATES  
INSURANCE  
835 Broadway, P.O. Box 189  
Vancouver, Washington 98666

Extracted from early ownership County  
maps. Relates if DLC or Homestead, claim  
number, township and range. Some with  
other information.

\*\*\*\*\*

THUNDERBIRD/RED LION MOTOR INNS  
THROUGHOUT THE WEST

23 YEARS IN BUSINESS LOCALLY

These early pioneers were primarily from  
the mid-west and from eastern states.

8x11, 39 pages, cardstock  
\$5.00 plus 50¢ postage  
and handling

\*\*\*\*\*

CLARK COUNTY GENEALOGICAL SOCIETY

People can be divided into three groups:  
Those who make things happen,  
Those who watch things happen  
And those who wonder what happened..

P.O. BOX 2728 - 1511 Main Street

Vancouver, Washington  
98668

\*

\*

\*

\*



CLARK COUNTY GENEALOGICAL SOCIETY  
Library - 1511 Main Street  
P. O. Box 2728  
Vancouver, Washington 98660

Non-Profit Org.  
U. S. Postage  
PAID  
Vancouver, WA  
Permit No. 934

RETURN POSTAGE GUARANTEED

Amer.-Can. Genea. Soc.  
P.O. Box 668  
Manchester, N.H. 03105