

# Saskatchewan GENEALOGICAL SOCIETY

VOLUME 31 NUMBER 1

MARCH 2000

## BULLETIN

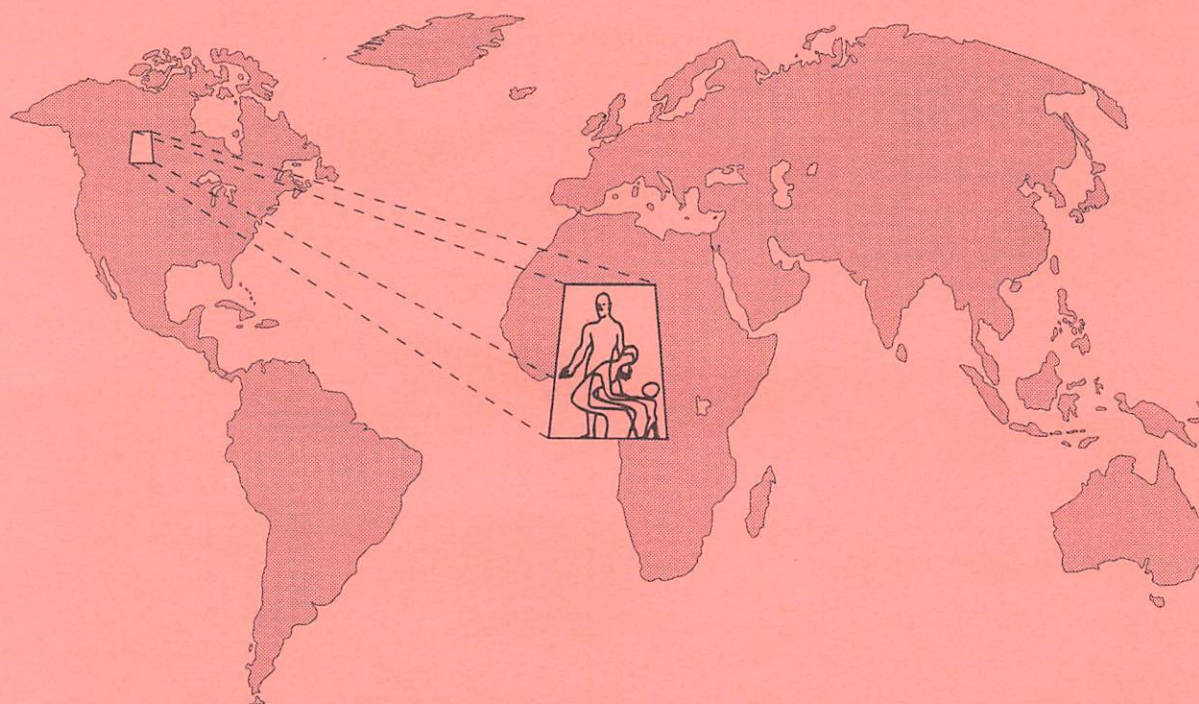

Helping you research your family history around the world



# SASKATCHEWAN GENEALOGICAL SOCIETY INC.

SGS Library & Office  
PO Box 1894  
Regina, Saskatchewan  
S4P 3E1

2nd floor, 1870 Lorne Street  
Regina, Saskatchewan  
Telephone: (306) 780-9207  
Fax: (306) 781-6021

## Summer

Monday - Friday  
9:30am - 4:30pm

## Library & Office Hours

## Winter

Tuesday to Saturday  
9:30am - 4:30pm  
Closed Saturdays of long weekends

SGS Web Site: <http://www.saskgenealogy.com>

*Correspondence should be accompanied by a self-addressed stamped envelope.*

2000

## BOARD OF DIRECTORS

**PRESIDENT:** Arlene Frolick, 14 Davis Place, Regina, S4S 4R1 #586-0262

**PAST-PRES:** Janis Bohlken,  
c/o PO Box 1894, Regina, S4P 3E1  
#789-2767

**VICE-PRES:** Blanche Fleming,  
626 Moffet Drive, Weyburn, S4H 2M7  
#842-2593

## DIRECTORS

John Meen, Box 164, Moosomin, S0G 3N0 #435-2363

Wanda Young, 501-537 4<sup>th</sup> Avenue N,  
Saskatoon, S7K 2M6 #242-6554

Rocky Sample, Box 128, Pangman, S0C 2C0 #442-4314

Nancy Lyons, 3530 Victoria Avenue,  
Regina, S4T 1M1, #586-0775

## SGS STAFF

Executive Director: Marge Thomas  
SGS Librarian: Laura Hanowski  
Executive Assistant: Lisa Warren

## SGS VOLUNTEER CO-ORDINATORS

Cemetery: Linda Neely  
SRI: Bill Boll  
Family History Fair: Gord Krismer

**Mission Statement:** The SGS is a volunteer provincial heritage organization whose purpose is to promote and develop the study, research, and preservation of Genealogy and Family History.

**The objectives and goals of Saskatchewan Genealogical Society Inc. (SGS) shall be as outlined in the Society Bylaws (1997).**

1. Education - Provide encouragement and instruction in scientific and ethical research methods.
2. Preservation, Conservation and Collection - Preserve, conserve and collect materials relevant to the study of genealogy and family history.
3. Resources - Develop and maintain SGS's human and financial resources.
4. Promotion - Promote and foster the study of genealogy and family history.

Membership is for the current calendar year at \$33.00 per family, \$30.00 for senior citizens.

Donations to the SGS may be used  
as a charitable tax deduction.

Other organizations are invited to exchange  
their publications with the *Bulletin*.

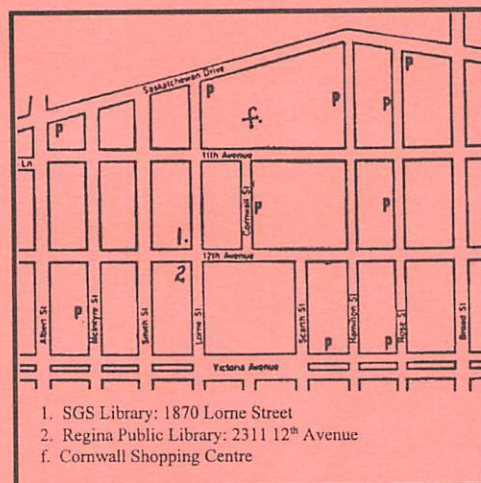

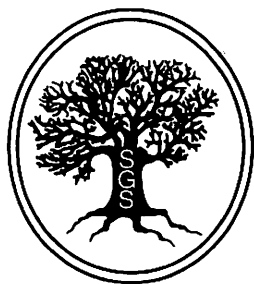

The Bulletin  
*Journal of the*  
**Saskatchewan**  
**Genealogical Society Inc.**

Publications Mail Registration No. 09800

ISSN 0048 9182

Volume 31 Number 1  
March 2000

## Contents

The **BULLETIN** is published quarterly. All submitted material will be considered for publication, however the Editor has the option of editing, reserving or rejecting any submission. Manuscripts must be fully referenced and carry the writers signature. Please advise the Editor if the material has previously appeared in another publication.

The *Bulletin* accepts paid advertisements. Book reviews are done gratis on donated books to be printed at the Editor's judgement.

Neither the Editor or SGS are responsible for errors of fact, nor the opinions expressed by the contributors to the *Bulletin*.

Queries of reasonable length are published gratis for members and subscribers. Non-members may submit queries up to 60 words in length for a fee of five (\$5.00) dollars.

Articles published in the *Bulletin* may be reprinted freely, except for copyright material from another source. A credit line and a copy of the publication containing the material is requested. Disk copy of article is greatly appreciated, and will be returned after publishing.

Membership is for the current calendar year at \$33.00 per family, \$30.00 for senior citizens. Subscription price for *non-members* is \$33.00 for the current calendar year or \$10 per issue.

President's Letter .....	2
Editor's Note .....	2
The Shiloh People – A Black Settlement in Saskatchewan, Part 2 .....	3
News and Notes .....	9
Useful Web Sites .....	13
Immigration Records .....	17
Times Have Not Changed All That Much .....	20
SGS Library Additions .....	i
SGS News .....	iii
Surfing The Net .....	iii
1999 Fundraising Campaign .....	iv
Notice of Annual Meeting .....	v
Notice of Changes to Constitution of SGS .....	vi
The Naughty List .....	vi
Book Reviews .....	viii
The Naming of "The Lost - Horse Hills" .....	21
The 1935 Federal Electoral Roll - Disley, Stony Beach & Keystown .....	23
Birth Briefs .....	27
Looking For Ancestors .....	28
Cemetery Program .....	29
Computer Corner .....	30
SGS Financial Statement, December 31, 1999 .....	32
SGS Bulletin Board .....	35
SGS Family History Fair .....	36
Millennium Past - Millennium Future .....	36
Announcements .....	37
Queries .....	38
Advertising .....	39
SGS Branches: Contacts & Meetings .....	40

*Deadline for the next issue of the Bulletin is April 15th, 2000. Materials received after this date will be held over until the next issue.*

# President's Letter

**BY ARLENE FROLICK**

SGS President

On behalf of SGS's membership, I would like to extend a thank-you to the four members of the Board who retired at the end of 1999: Marie Svedahl, who joined SGS in 1979, has played a huge role in various areas of the organization, served on many committees, and is a past president. Bev Weston has been on the Board for 6 years; Terry Ford for 4 and Neil Southam for 2 years. Those who sit on the Board are accountable for all actions taken on behalf of SGS. It is an important role and not always an easy task. Thanks again from all of us, and we know you'll still continue to lend a helping hand when needed.

I would be amiss if I didn't also welcome two new members to the Board: Nancy Lyons and Rocky Sample. They along with Janis Bohlken, Blanche Fleming, John Meen, Wanda Young and I look forward to serving you in 2000.

We are now three months into a New Decade, a New Year and a New Millennium -- and everything continues to run smoothly! This is an exciting time. The 'hobby' of genealogy has become much more -- it's on the cutting edge of being a huge business. Technology has forced many organizations to keep up with the times. SGS is no exception. Our webpage (look for the address elsewhere in the Bulletin) is visited often. Our membership is increasing, our workshops are well attended. Let's keep up the good work!

Genealogy can evolve into more than just looking up names and dates. There's a whole heritage to those names and dates - a legacy that our ancestors left, a sometimes invisible thread that gives us (most of us?) an interest or perhaps even an obligation to find all we can about our past. Heritage is like a family; it should be cherished and respected, but not be taken for granted. It doesn't give us any rights, nor makes us any better or worse than what we are. Heritage is our past - not to brag about, nor be ashamed of. It's like a shadow. It follows you, but it is not YOU.

# Editor's Notes

**BY MARGE THOMAS**

Executive Director

In this issue, there is information regarding the Family History Fair, the Annual General Meeting and the upcoming SGS Annual Seminar. Take the time to read the information and plan on attending these events. Genealogical events provide you with the opportunity to network with others who are researching the same areas and an opportunity to learn research techniques.

There is no *Surfing the Net* in this issue since we have an article from Garth Ulrich on his favourite web sites.

Thank you to everyone who sent in articles. Please keep them coming.

++++

... *Presidents Reports continued*

You'll likely be hearing quite a bit more about heritage this year. SGS's Saskatchewan Heritage Record Directory (SHRD) is a new program dedicated to locating and listing early documents. We need to preserve the records that make up our past in Saskatchewan, and we're looking for volunteers to gather information on records in all communities.

Mark your calendar for April 8 to attend the Family History Fair being held in Regina, and April 29 for the Annual General Meeting held in Saskatoon.

I feel very proud of SGS and its many volunteers. And I'm looking forward to my term as President.

++++



# The Shiloh People

## A Black Settlement in Saskatchewan (Part 2)

BY ARLENE FROLICK

*Part 1 is in Volume 30, Number 4, December 1999 issue of SGS's BULLETIN (page 133). It briefly outlined the reasons why African American families fled the southern states of USA to Oklahoma Indian Territory, Texas and Missouri and then relocated to a tiny settlement north of Maidstone, Saskatchewan. More than 30 families, plus the married sons of the original settlers, filed for homesteads in that area from 1908 to 1912.*

The windswept land of possibilities was undoubtedly a welcome sight to the eyes of the new settlers after their long and bittersweet journey. They were home at last and prepared for a new way of life on the Saskatchewan prairies as they applied for homesteads, built houses, and cleared the land readying it so that they could qualify for that very important Land Patent.

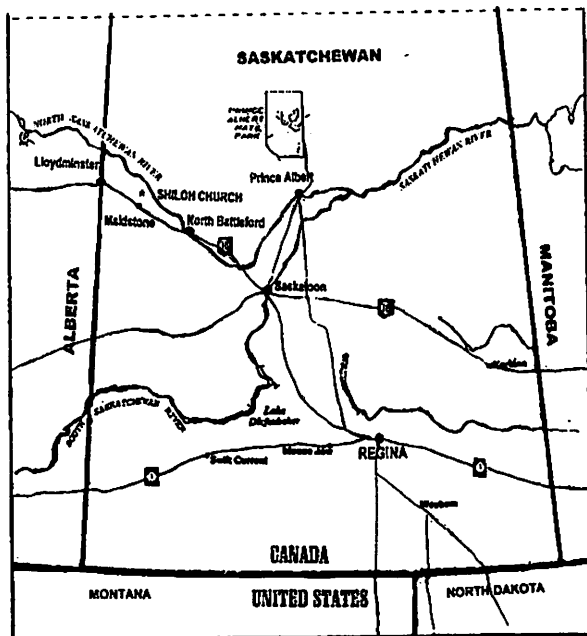

Today Shiloh Church, an enduring symbol of those settlers, sits empty and silent on land situated just north of the small prairie town of Maidstone.

It is the only church in the province that was erected by African American pioneers and was used until the 1940's. Spruce trees that were dug up from the "mouth of the Gully" - a boreal forest a few miles away - more than 70 years ago and replanted in the churchyard have grown tall and offer shade to the forlorn looking tiny building and white wooden crosses that dot the nearby graveyard.

In 1971, Saskatchewan celebrated "Homecoming '71", a provincially funded program designed to increase tourism. Funds were made available to businesses, communities and municipalities, and special events were promoted to bring former residents back to Saskatchewan. A group of people from five surrounding Maidstone districts formed a committee that was one of 759 eligible applicants to receive a government grant for the Homecoming '71 Program. That committee, the Maidstone-Waseca Districts Committee, took on as one of its projects the restoration of Shiloh Church and cleanup of the Cemetery grounds. Work began in April 1971 with a July target date for a reunion and celebration.

The first task for the volunteers was to clear the very overgrown grounds of badger bush, wild rose bushes, small willows, weeds and wild underbrush. Fencing was repaired or replaced, and a new chain link fence and two gates were added. After 30 years of neglect, the little churchyard was starting to take shape and the volunteers were fuelled with enthusiasm over their project. They organized work bees, brought lunch and had many enjoyable picnics, as the work progressed.

Volunteers, some of them on their knees, carefully searched at the bases of the spruce trees and trembling aspen for evidence of graves. They found stones laid in a pattern which appeared to be

marking the head and foot of graves. After carefully and methodically noting each depression in the ground, they located 48 gravesites. The stone formations are believed to have marked the graves of 18 to 20 children.

Repairs to the church began. The outside walls were braced with steel road grader blades to insure a sturdy structure. Floor boards were carefully removed, and after all the beams underneath were braced, the boards were replaced one by one. The old roof was removed and replaced with a new shingle roof. Inside, the hand-hewn pews were left intact but the few holes in the square-log walls were filled. Two original doors remain - the entrance door and another at the front of the church leading to the churchyard and Cemetery.

The graves were marked by white wooden crosses built in the Sheltered Workshop in North Battleford, and placed in the ground by volunteers. After a few years, these crosses were replaced with white painted pressure treated posts that were constructed and erected by caring neighbours. After nearly 700 volunteer hours of labor, the project was completed and ready for an old-fashioned "welcome home" ceremony. Former residents were invited to once again visit the church of their childhood.

The homecoming celebration was held on July 4, 1971, a day that began with fresh rain, followed by clearing clouds and warm sunshine that spread across the Shiloh Church and its yard and Cemetery. It was a glorious day for renewing acquaintances, meeting old friends and school chums of both black and white folk.

**Murray Mayes** of North Battleford was Master of Ceremonies. He expressed gratitude and appreciation to all those responsible for the restoration project. Steve Ratuszniak, chairman of Homecoming '71, welcomed the over 500 guests who filled the church and spilled into its yard. Among the guests were about 85 descendants of the original settlers.

Brother Herrick Holt of the Church at Sharon, North Battleford, and Brother Arthur G. Wagar, Lloydminster, were guest speakers. Many others, including **Leander Lane Jr.**, thanked the Committee, and reminisced about long forgotten memories of their childhood. The formal ceremony included the beautiful singing voices of descendants heard in solos, trios and quartets singing hymns and other spiritual songs. Shiloh Church stood proud that day.

A memorial monument, which unfortunately was not ready for the July 4 celebration, was unveiled and dedicated on August 15, 1971. The marker erected by the "Maidstone-Waseca Districts Homecoming '71 Committee in Co-operation with the Department of Natural Resources" reads:

#### **SHILOH BAPTIST CHURCH**

IN 1910 MATTIE MAYES, MATRIARCH WHO WAS BORN INTO SLAVERY, AND ABOUT 40 MEMBERS OF THE MAYES FAMILY EMIGRATED FROM OKLAHOMA AND SETTLED IN THE MAIDSTONE DISTRICT. THEY WERE JOINED LATER BY OTHER FAMILIES AND AN EXTENSIVE SETTLEMENT WAS SOON ESTABLISHED.

IN 1916, A DEED WAS OBTAINED FOR SHILOH BAPTIST CHURCH AND CEMETERY. THE CHURCH HAD BEEN BUILT EARLIER AND SERVED THE COMMUNITY UNTIL THE SETTLEMENT WAS ABANDONED IN THE 1940'S. DURING THAT TIME 48 OF THEIR LOVED ONES WERE LAID TO REST IN THIS CHURCH YARD. MATTIE PASSED AWAY AFTER HER 100<sup>TH</sup> BIRTHDAY AND WAS BURIED NEAR EDMONTON.

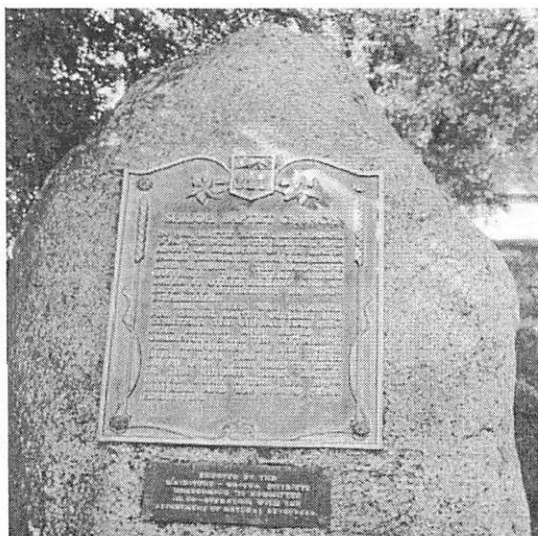

On December 4, 1991, The Rural Municipality of Eldon No. 471, Bylaw No. 114, designated the property known as Shiloh Baptist Church and Cemetery on Part of NE Quarter of Section 12, Township 50, Range 23, West of 3rd Meridian as being a site of historical value. It is a well deserved honor.



#### Meaning of the word "Shiloh"

Peloubet's *Bible Dictionary*: Shiloh (a place of rest) was a city of Ephraim, north of Jerusalem. It was one of the earliest and most sacred of the Hebrew sanctuaries.

The local history book *North of the Gully* states: "We have not been able to establish for certain how 'Shiloh' got its name, but believe that this group of bible readers (in the Eldon School District, north of Maidstone, Saskatchewan) got the name from this source: It is written in the Bible that when the Israelites, who were slaves, fled from Egypt to the promised land in Palestine, their journey took several years. On their journey they found a place to rest in central Palestine. This place was called Shiloh. When translated from Hebrew, it means 'resting place' or 'sanctuary'. Perhaps this is what this group of pioneer people hoped to find when they settled in Eldon - a Shiloh to call their own."

#### Shiloh Cemetery

Unfortunately, the original register of those 48 persons buried beneath the towering trees in Shiloh Cemetery has not been located and is feared to be lost. It is only fitting that every effort be made to recreate those records as accurately as possible. This is a daunting task.

Since 1971, two more persons were buried in the Cemetery - **George Harvey Mayes** in 1975 and his wife **Lucille** in 1987.

The actual or approximate date of birth (b), the place born, and the actual or approximate date of death (d) has been collected from many sources -- census records, newspaper articles or obituaries, homestead and land title records, and in conversation with some descendants of the Shiloh people. Following is a list of names and dates of those persons buried in Shiloh Cemetery:

**Bailey, Alfred** - b July 1858 Tennessee,  
d June 3, 1929, age 71

**Bailey, Mrs. Alfred (Cora Jefferson)** -  
b January 1868 Texas, d unknown

**Beane (baby)** - (daughter of William Beane and  
Eddie Mae Cooper) - b and d unknown

**Cotton, Anderson** - b 1847 Texas,  
d April 30, 1915, age 68

**Cotton, Mrs. Anderson (Violet)** - b 1849,  
d unknown

**Crawford, Mrs. William (Isabella Bird)** - b 1878  
North Carolina, d ca 1924

**Gaston, Samuel Marshall Sr.** - b August 8, 1867  
Texas, d June 5, 1935, age 68

**Gaston, Ruth** (dau) - b April 1896 Texas,  
d 1915, age 19

**Gaston, Hattie** (dau) - b May 1900 Texas,  
d 1916, age 16

**Harper, Anderson N.** - b March 1861 Kentucky,  
d January 18, 1924, age 63

**Harper, Mrs. Anderson N. (Lizzie)** - b Jun 1872  
Tennessee, d 1908, age 36

**Hill, Mrs. (Al) M.** - b 1855, d before 1914

**Jones, Johnnie** (dau of Lucille 'Love' Jones) -  
b ca 1914 Sask., d ca 1918, age 4

**Lane, Mrs. Clayton (Lucille 'Love' Jones)** -  
b ca 1894 Alabama, d ca 1924/5

**Lane, female** (infant dau of Clayton and Love) -  
b and d ca 1924/5

**Lane, Julius Caesar "Cecil"** - b August 1849  
Georgia, d May 20, 1913, age 63  
- first person to be buried in Shiloh Cemetery

**Lane, Mrs. Chester (Merle Mayes)** - b 1890  
Oklahoma Indian Terr., d unknown

**Whitaker, Mrs. (Leora Lane** dau of Chester and  
Merle) - b August 1914 Sask, d in childbirth,  
date unknown

**Whitaker, baby daughter** of Leora Whitaker -  
b and d unknown

**Lewis, Abraham** - b 1869 Tennessee,  
d after 1923

**Lewis, Mrs. Abraham (Queenie)** - b 1871  
Tennessee, d January 31, 1922, age 50



**Mayes, Wyatt Allan** - b March 2, 1851 Georgia,  
d December 29, 1929, age 78

**Mayes, Mrs. Wyatt ( Betty Robinson)** -  
b August 1862 Tennessee, d December 23,  
1920, age 58

**Mayes, Willie** (son of Wyatt and Betty) - b 1905  
Oklahoma Indian Terr., d unknown

**Mayes, Mrs. Hank (Emily Lee)** - b unknown,  
d ca 1941-2

**Mayes, Joseph** (husband of **Martha Jane**  
**'Mattie' Warner**) - b January 1856 Georgia,  
d 1916, age 60

**Mayes, Allan** (son of Joseph and Mattie) - b 1886  
Texas, d bef 1916

**Mayes, Minnie** (dau of Allan Mayes and Julia  
Grant) - b and d unknown

**Mayes, George Harvey** (son of Joseph and Mattie)  
b November 20, 1893 Oklahoma Indian Terr.,  
d October 12, 1975, age 82

**Mayes, Mrs. George Harvey (Lucille Crawford)**  
b November 1, 1898 North Carolina,  
d April 16, 1987, age 88

**Mayes, Otis** (son of George Harvey and Lucille) -  
b July 11, 1926 Sask., d December 9, 1945 in a  
train crash near Jacobs, ON, age 19



**Mayes, Roy** (son of Virgil and Beechie) - b April 17, 1910 Sask., d after 1935

**Mayes, John** (son of Joseph and Mattie) - b 1899 Oklahoma Indian Terr., d February 1, 1945, age 45

**Mayes, Buddy** (son of John and Julie Matthews) - b ca 1937/9 Sask., d ca 1940/41

**Mayes, Helenea** (dau of Edward and Myzzy Mayes) - b ca 1929, d ca 1932, age 3

**Perteet, Andrew D.** - b 1861 Arkansas, d 1918 flu epidemic, age 57

**Perteet, Robert** (son of Andrew Perteet) - b 1888 Arkansas, d 1918 flu epidemic, age 30

**Smith, Tom** (son of Rufus Saddler Smith and Drucilla Threatt) - b 1904 Oklahoma Indian Terr., d ca 1915, age 11

This list of burials is far from complete. Records are nonexistent or impossible to find in order to determine how many deaths occurred as a result of infant mortality or stillbirth, or that were caused by the 1918 flu pandemic, and who would be buried in Shiloh Cemetery.

There are some early homesteaders that COULD be buried in the Cemetery, although they may have moved out of the area. They are listed here for reference only, and perhaps to jog someone's memory. Their approximate year of birth is listed in brackets beside each person's name.

**Anderson, George** (1881)  
and **Mrs. Anderson** (1890)

**Beely, Wyatte** (1872)  
and **Mrs. Beely** (1873)

**Boyd, Samuel M.** (1869)

**Boyd, John Dee** (1885)

**Farmer, Archie** (1862)

**Forester, Lewis** (1853)  
and **Mrs. Agnes Forester** (1862)

A fitting final chapter to this story would be to fill in all the missing names and dates. If anyone can provide more information or corrections to the above list, please write to:

Saskatchewan Genealogical Society  
PO Box 1894  
Regina SK S4P 3E1

One of the members of the 1971 organizing committee for Homecoming '71 has allowed me to quote her: "As a child, I remember **Granny Mayes** walking through the Cemetery every chance she got. She knew each and everyone buried there. Having been a mid-wife, she had a personal relationship with almost everyone ... here as well as the homes of many, many residents both black and white in the communities."

**Martha Jane "Mattie" (Warner) Mayes** died on January 20, 1953, and is buried in Beechmount Cemetery, Edmonton, Alberta.

## Bibliography

### CANADA:

Shepard, R. Bruce. *Deemed Unsuitable*. Umbrella Press, Toronto 1997

Shepard, R. Bruce. *The Little "White" Schoolhouse: Racism in a Saskatchewan Rural School*. Saskatchewan History Volume XXXIX, Autumn 1986, Saskatchewan Archives Board, Saskatoon, Saskatchewan

Winks, Robin W. *The Blacks in Canada: a History*, 2nd Edition. McGill-Queen's University Press 1997

*North of the Gully* compiled by History Book Committee, Maidstone, Saskatchewan 1981

*South of the Gully* published by South of the Gully History Committee 1981, Meridian Printing (1979) Ltd., Lloydminster, Alberta

*Lashburn and District History* compiled by Lashburn and District History Book Committee, 1983. Turner-Warwick Printers Inc., North Battleford, Saskatchewan

*Rural Municipality of Eldon No. 471* Maidstone, Saskatchewan Bylaw No. 114 adopted December 4, 1991

*Saskatchewan Archives Board* (Regina)  
Homestead Files  
Oral History Collection

*Saskatchewan Genealogical Society Cemetery Program*

*Saskatchewan Land Titles Office* (North Battleford)  
Certificates of Title

*Regina Public Library microfilm collection*  
Manitoba Border Crossings (by trains) 1908 to 1918

#### Newspapers:

Fort William, Ontario - *The Daily Times-Journal*  
Lashburn, Saskatchewan - *The Lashburn Comet*  
Maidstone, Saskatchewan - *The Maidstone Mirror*  
North Battleford, Saskatchewan - *News Optimist*  
Toronto, Ontario - *The Globe and Mail*  
Toronto, Ontario - *National Post*

#### UNITED STATES:

*The Encyclopedia Americana* c.1994, by Grolier Incorporated, Danbury, Conn.

*The World Book Encyclopedia* c.1999, by World Book, Inc., Field Enterprises Educational Corporation, Chicago

Peloubet, F.N. *Peloubet's Bible Dictionary* The John C. Winston Company, Philadelphia PA 1947

*Twelfth Census of the United States Taken in the Year 1900* - Indian Territory, Missouri, Oklahoma, Tennessee, Texas

*Thirteenth Census of the United States Taken in the Year 1910* - Oklahoma

++++



# News & Notes

BY ALICE ACHTER AND RAE CHAMBERLAIN

*These Bulletins/Journals are in SGS Collection.*

**Saskatchewan History, Vol.51, No.1, Spring 1999.**

- The Peoples of Saskatchewan In Pictures: The First Nations
- "Little Saskatoon": An Experiment in Land Settlement during the Great Depression
- Indigenous Voices "The Old Men of the Reserves"
- History In The Community, Reflections on the Heritage Endeavour

**The New Zealand Genealogist, Vol.30, No.258, July/August 1999.**

- Family research on the Internet comes of age on LDS site

**Black Hills Nuggets, Vol.XXXII, No.3, August 1999.**

- Early-Day Black Hills Transportation Routes
- People Of The Western Road. A story about the Crouch Line Railroad.
- Behrens' Funeral Home. An index to J.H. Behrens' Mortuary Records, Book 3, 1921-29.
- Cemeteries Of The Black Hills. The first of a new series of articles about cemeteries in the Black Hills area with Mount Moriah Cemetery, Deadwood, South Dakota featured.

**The Greenwood Tree, Journal of The Somerset & Dorset Family History Society, Vol.24, No.3, August 1999.**

- Dorset's 'Gretna Green'
- Inquest Reports extracted from The Taunton Courier of 1827

**Seattle Genealogical Society Bulletin, Vol.48, No.4, Summer 1999.**

- In The Civil War Aftermath

**Cumbria Family History Society, No.92, August 1999.**

- Records of the Manor of Beetham 10th June 1776

**Ancestor, Quarterly Journal of the Genealogical Society of Victoria Inc., Vol.24, No.6, Winter 1999.**

- Ireland Research Trip Tips
- 1881 Census Project Reported 'mistakes'
- Restoration Of Faded Photographs By Copying Under UV Light

**Family History News and Digest, Vol.12, No.2, September 1999.**

- The Year 2000 Problem and Family History Societies

**Australian Family Tree Connections, July 1999.**

- Getting Started - Letters: A Key to Your Genealogical Past

**National Genealogical Society Quarterly, Vol.87, No.2, June 1999.**

- Editors' Corner - Problems in Eden: Privacy and Copyright on the Web
- Genealogical Research in Missouri
- Too Many Possibilities and Not Enough Records: Finding Parents for Naomi (Sears) Rider of Dutchess County, New York

**The Essex Family Historian, No.93, August 1999.**

- Facts About The GRO Indexes

**Family Tree Magazine, Vol.15, No.9, July 1999.**

- Old Occupations - The Higgler
- The English church courts and their records
- The 1881 British Census on CD-ROM

**Branch Notes - Waterloo-Wellington Branch of OGS, Vol XXVII, No.3, August 1999.**

- Waterloo Presbytery Local Church Records at the United Church Archives
- Bruce Presbytery Local Church Records at the United Church Archives
- A New Irish Source: Are Your Folks From County Wicklow?
- Guelph Mercury References

**Perth County Profiles, Vol.17, No.3, August 1999.**

- Grand Trunk Railway List of Employees, 1889
- 1864 Assessment Roll for Taxes, Township of Elma continued

**Abbotsford Genealogical Society Newsletter, Vol.IV, No. 4, August 1999.**

- Obituaries from the Abbotsford Newspapers, Mar.31, 1999 to July 24, 1999

**The Bulletin - Kawartha Branch of OGS, Vol.24, No.3, August 1999.**

- Register of Baptisms Springville (Presbyterian) United Church, N . M o n a g h a n T w p . , Peterborough County - Oct. 10, 1858 to Mar.3, 1867



**Kindred Spirits - Whitby-Oshawa Branch of OGS, Vol.XVIII, No.3, Summer 1999.**

- Wesleyan Methodist Baptisms 1840-1880 from the Old Counties of Durham and Ontario

**London Leaf - Newsletter of the London & Middlesex County Branch of OGS, Vol.26, No.3, August 1999.**

- Licenses Issued by the Town of London 1856
- Extracts From the "General Register of the Gaol in London for the County of Middlesex, 1875-1880"

**The Tracer - Oxford Branch of OGS, August 1999.**

- "Oxford-On-The-Thames". Some facts about the early history of the County of Oxford with several names listed.
- Wills of Oxford County 1804-1841

**Lambton Lifeline, Vol.16, No.3, September 1999.**

- Remembrance Web Sites
- Translation on the Net
- Dutch State Archives
- Canadian Provincial Archives
- Quebec Database Online

**Galizien German Descendants, No.19, July 1999.**

- Hohenbach - The Former Settlements of Joseph II in the Weichsel-San Triangle
- The Austrian Census for Galicia

**Generations - Journal of the New Brunswick Genealogical Society, Vol.21, No.3, Fall 1999.**

- The Reluctant Loyalists. Deals with the Anglican Missionaries who came to New Brunswick from Connecticut.
- Grand Manan Marriages Part 2
- Epitaphs to Smile Over!

**German Genealogical Digest, Vol.15, No.1, Spring 1999.**

- Surnames, Sources & Places - German Sources on the Internet
- Microfilm & Book Update
- Prussian Military Records, Part II

**News & Views - Leeds & Grenville Branch of OGS, August/September 1999.**

- Genealogy Sources, Scotland, Ulster, USA

**The Bukovina Society of the Americas Newsletter, Vol.9, No.3, September 1999.**

- The Zipser Settlement of Jakobeni

**Avotaynu - The International Review of Jewish Genealogy, Vol.XV, No.2, Summer 1999.**

- Using The Mormon Family History Catalog On the Internet for Jewish Genealogy
- Mobility of Jewish Families from Alsace-Lorraine at the End of the 19th Century
- Primary Source Material for German-Jewish Genealogy at the Central Archives for the History of the Jewish People
- Hamburg Emigration Lists Are Being Computerized

**German Genealogical Digest, Vol.15, No.2, Summer 1999.**

- Surnames, Sources & Places - New Sources For German Family History Research
- Residents of Munster in 1749/1750
- Deciphering German Handwriting in German Documents - Part 4
- German Marriage Records Indexes - Brandenburg and Hannover

**The British Columbia Genealogist, Vol.28, No.3, September 1999.**

- Matric Class at King Edward High School, Prince George 1921
- Scottish-Irish Interrelations

**Sussex Family History Society, Vol.22, No.3, September 1999.**

- Proposed Extension of The Surrey Iron Railway 1801. Names of those whose land would be lost to make way for the railway.
- Westminster/General Lying-in Hospital 1767-1971 History & Records Part II

**Journal of the American Historical Society of Germans from Russia, Vol.22, No.1, Spring 1999.**

- Life In The Agricultural Communities of Germans Living in Russia
- Archives of the Former Autonomous Soviet Socialist Republic of Germans on the Volga in Engels: A Golden Source of Information About the Genealogy and History of German Colonists, 1767-1941
- The Germans in the Soviet Union at the Outbreak of the Second World War North Central North Dakota Genealogical Record, No.80, September 1999
- Notes from Evelyn Zablony. Notes regarding research for Norway, Kansas, Illinois, Iowa, US adoption records, coal miners and county maps.
- Annette on the Net. Suggestions for using the Family Search web site and the ND naturalization records index.
- Standard Atlas for McHenry County, ND 1910 - an index of land owners in Twp. 154 N., Range 80 W.

**Relatively Speaking - Alberta Genealogical Society, Vol.27, No.3, August 1999.**

- Clarifying Confusion in English Ancestral Research

**Sussex Family Historian, Vol.13, No.7, September 1999.**

- Sussex Census Database
- Sussex Militia Deserters 1820-1821

**NGS Newsletter, Volume 25, No.5, September/October 1999.**

- Reading Early American Handwriting.
- Mexican Border Crossing Records, Part 3

**The Dakota Homestead Historical Newsletter, Vol.28, No.3, September 1999.**

- Language Equivalents
- Military Records in The National Archives
- The Dakota Territorial Census of 1885 - County of Buford continued.

**Liverpool Family Historian, Vol.21, No.2, June 1999.**

- Court Dwelling Houses and Their Consequence On The Inhabitants

**P.E.I. Genealogical Society, Inc. Newsletter, Vol.23, No.3, September 1999.**

- P.E.I. Archives and Records Office, Supreme Court Fonds Part 5
- The Establishment of the Church of Scotland, Charlottetown with a list of subscribers
- Prince of Wales College and Normal School, Charlottetown, P.E.I. graduates 1885-1924
- Early Baptisms of St. Johns Church, Belfast (Part Two)
- Departed Friends "The Maple Leaf", September 1928

**Heritage Quest, Vol.15, No.4, July/August 1999.**

- The focus of this issue is "Overcoming Brick Walls" in doing genealogical research

**Metropolitan, London & Middlesex Family History Society, Volume 22, No.1, October 1999.**

- Finding A Foundling
- Family and Friends 'at the Bank'

**The Banyan Tree, East Yorkshire Family History Society, No.80, October 1999.**

- Spotlight on Market Weighton
- An Evacuee's Story
- An Evacuee's nostalgic Return

**Oxfordshire Family Historian, Volume 13, No.2, August 1999.**

- Equity Records - An Under Used Source
- Holy Trinity School, St. Ebbes Log Book

**Tasmanian Ancestry, Genealogical Society of Tasmania Inc., Vol. 20, No.2, Sept 1999.**

- Our Fading, Fuzzy Photographic History

**The New England Historical and Genealogical Register, Vol.153, July 1999.**

- Genealogical Bibliography of Middlesex County, Massachusetts, Testors 1649-1660
- Notarial Records Concerning New England In Rotterdam Municipal Archives

**The Greenwood Tree, The Somerset and Dorset Family History Society, Vol.24, No.4, November 1999.**

- Freeman of the Town (City) of Wells
- Spotlight on Winfrith Newbu(e)rg

**Australian Family Tree Connections, September 1999.**

- Personal Ancestral File (PAF) 4.0

**Cumbria Family History Society, No.93, November 1999.**

- Glossary of Uncommon and Dialect Words In Cumbrian Probate Inventories

**The Newfoundland Ancestor, Vol.15, No.3, Fall 1999**

- Arnold's Cove A Community History
- Newfoundland Strays

**Western Ancestor, Western Australian Genealogical Society Inc., Vol.7, No.11, September 1999**

- Finding Families in Photographs

**BRANTches - Brant County Branch of OGS, Vol.19, No.3, September 1999.**

- Vital Statistics from the Brantford Evening Telegram, 1889
- First Assessment Roll - Town of Brantford 4 Sept. 1847

**Family Tree Magazine, Vol.15, No.7, May 1999.**

- RAAF POW's - accessing records through the Red Cross
- Some non-London Records at the London Metropolitan Archives
- The West Indies: St. Kitts

**Rodziny - Journal of the Polish Society of America, August 1999.**

- The Grand Duchy of Poznan
- German and Polish Names of Selected Towns in Posen
- Canadian Immigration Policy Towards Poles, 1896-1939, Part II Family Tree Magazine, Vol.15, No. 12, October 1999
- Grave Thoughts - cemeteries in the London area.

**The Treehouse - Campbell River Genealogy Club, Vol.12, No.3, September 1999.**

- WWI Draft Registration Cards at National Archives and Records Administration, USA.

**Galizien German Descendants, Newsletter, No.20, October 1999.**

- Beckersdorf
- Immanuel Evangelical Lutheran Church in Landestreu, Saskatchewan 1895-1970
- Contacting Polish Archives to do research

**The Loyalist Gazette, Vol.XXXVII, No.2, Fall 1999.**

- Kingston: from Fort to Settlement: 1683-1784

**Treasure State Lines - Great Falls Genealogy Society, Vol.24, No.3, 1999.**

- Marriage Licenses Issued by the State of Montana, County of Chouteau, City of Fort Benton 1920
- The Spanish-American War, Company L 2nd Battalion - Montana (Nominal list of participants)
- Danish Archives
- News About Obtaining Death Certificates in Montana

**Perth County Profiles, Vol.17, No.4, November 1999.**

- Perth County Teachers Who Served in the Great War 1914-1918
- Military Research. Addresses and web sites are listed
- 1907 Collector's Roll for Taxes, Township of Downie

**Bulletin of the Polish Genealogical Society of America, Summer 1999.**

- Genealogy in Cyberspace (West Prussia plus other sites for research in Poland)

**International Society for British Genealogy and Family History Newsletter, Vol.21, No.3, July-September 1999.**

- Some Notes on Using Census Records

**North Central North Dakota Genealogical Record, Issue No.81, December 1999.**

- Emphasis in this issue is on Ward County, North Dakota - some land records and Federal census records abstracted
- Military Newspapers - the State Historical Society of Wisconsin is the central depositor.

**P.E.I. Genealogical Society Inc. Newsletter, Vol.23, No.4, November 1999.**

- P.E.I. Archives and Records Office - Beyond the Master Index
- The Establishment of the Church of Scotland, Charlottetown 1825

**Australian Family Tree Connections, October 1999.**

- Tracing Maltese Ancestry
- Genealogy - a complaint or a cure?

**Generations - Manitoba Genealogical Society, Vol.24, No.3, September 1999.**

- Jean's Lists and Indexes. A good source if researching in the Dauphin area.

**The Bulletin - Kawartha Branch of OGS, Vol.24, No.4, November 1999.**

- Register of Baptisms, Springville (Presbyterian) United Church, North Monaghan Twp., Peterborough County 1855-1868

**Toronto Tree - Toronto Branch of OGS, Vol.30, No.6, November/December 1999.**

- Libraries On The Internet

**Heritage Review - Germans From Russia Heritage Society, Vol.29, No.3, September 1999.**

- In Commemoration of the 125th Anniversary of Zion Lutheran Church, Odessa Township, Yankton County, Dakota Territory
- Karamurat
- Emigrants From Krasna, Bessarabia 1814-1940
- History of the Lichtental Community 1834-1909
- Obituaries From the Dakota Freie Presse, 1903-1947 continued

**The Colorado Genealogist - The Colorado Genealogical Society, Vol.60, No.3, August 1999.**

- National Veterans Cemeteries with addresses of State Veteran's Cemeteries
- Urraca Cemetery, Alamosa County
- Colorado Veterans' Grave Registrations 1862-1949

**Tree Tracer - Prince George Genealogical Society, Vol.20, No.3, September 1999.**

- Status of Parents in Marriage Records. The adjective "feu" before a man's name or "feue" before a woman's name means "the late".

**East European Genealogist, Vol.7, No.4, Summer 1999.**

- Metrical books in the Ukrainian Parishes of Halychyna in the First Half of the 18th Century
- Archive Addresses, Oblasts and Raions in Ukraine

++++



# Useful Web Sites

BY GARTH ULRICH

Garth, who is a members of SGS, has supplied a list of useful web site addresses that he has come across while doing his genealogy.

## Researching in Canada

Saskatchewan Genealogical Society  
<http://www.saskgenealogy.com/>

Canada GenWeb  
<http://www.rootsweb.com/~canwgw/cngenwebe.html>

Saskatchewan GenWeb  
<http://www.rootsweb.com/~cansk/Saskatchewan/>

Communilink (provides email address and web sites for cities, towns, rural municipalities in Saskatchewan)  
<http://www.communilink.sk.ca/addresses.htm>

Saskyellowpages residential listings  
<http://www.mysask.com/search/whitesearch.shtml>

Saskatoon Star Phoenix online  
<http://www.saskstar.sk.ca/>

Dominion Land Grants  
<http://www.archives.ca>

Glenbow Archives-CPR Land Records  
<http://www.glenbow.org/lasearch/cpr.htm>

Saskatchewan GIS Locator (allows you to plug in land descriptions, etc. to find location)  
[http://banshee.sasknet.sk.ca/cgi-bin/app\\_munic/app\\_munic.cgi](http://banshee.sasknet.sk.ca/cgi-bin/app_munic/app_munic.cgi)

Canada Postal Codes  
<http://www.canadapost.ca/>

University of Saskatchewan-Searchable Library Database  
<http://sundog.usask.ca/search/>

National Archives of Canada  
<http://www.archives.ca/>

inGeneas Canadian Genealogy  
<http://www.ingeneas.com/>

Saskatchewan Genealogical Tips  
<http://homepages.rootsweb.com/~canada/sask.htm>  
\*many good resources and links here

British Columbia Archives  
<http://www.bcarchives.gov.bc.ca/index.htm>

Saskatoon Public Library-Reference After Dark  
<http://www.publib.saskatoon.sk.ca/radpage.html>

Saskatchewan City and Town Maps  
<http://www.becquet.com/director/maps/index.htm>

## Researching in Norway

Ancestors From Norway  
<http://homepages.rootsweb.com/~norway/index.html>

1801 Census  
<http://www.uib.no/hi/1801page.html>

Digital Arkivet  
<http://www.hist.uib.no/arkivverket/index-en.htm>

How To Use The Norwegian Databases at the Digitalarkivet Web site  
<http://www.rootsweb.com/~wgnorway/databases.htm>

Seek Farm/Place 1801

<http://www.uib.no/hi/seekgard.htm>

Folketeljing 1801 for Kvar av Kommunane

<http://www.hist.uib.no/1801komm/>

Norway GenWeb

<http://rootsweb.com/~wgnorway/>

Emigrants From Kristiana, Kristiansand and Stavanger Harbours

<http://www.hist.uib.no/arkivverket/dnuEng.htm>

Norwegian Kommunes-Alphabetical List

[http://www.ki.kommorg.no/kominfo/k&f\\_alfa.html](http://www.ki.kommorg.no/kominfo/k&f_alfa.html)

Map of Fylke

<http://www.cport.com/~catmandu/XXX.html>

\*Where I have XXX replace with the name of the fylke that you are interested in, ie. Oppland, Buskerud, etc.

Norway (General Information)

<http://www.geocities.com/~inforonway/>

Valdres Samband

<http://www.geocities.com/~valdressamband/>

Vesterheim Genealogical Centre and Naeseth Library

<http://www.vesterheim.org/genealogy/index.htm>

Norwegian-American Dictionary

<http://home.sol.no/~ojorgens/files/word.htm>

Norwegian Emigrant Muiseum

<http://www.hamarnett.no/emigrantmuseum/>

Medieval Scandinavia

<http://home.ringnett.no/bjornstad/misc/content.html>

Slektshistoriske Kilder 1500-1900

<http://home.sol.no/~asjonass/kiler/index.htm>

Fylke-Specific Queries by Rootsweb

<http://cgi.rootsweb.com/~genbbs.cgi/Norway/XXX>

\*Where I have XXX replace with the name of the fylke that you are interested in, ie. Oppland, Buskerud, etc.

Kommuner Cross Reference

<http://www.j51.com/~risholmr/kommune.html>

Nes, Hallingdal Church Records Online

<http://home.sol.no/~steinv/kirke.htm>

Matrikkelutkastet av 1950 (Land/Tax Register of 1950)

<http://www.dokpro.uio.no/cgi-bin/stad/matr50>

Norway List

<http://www.cport.com/~catmandu/NorwayList.htm>

Norway List-Lookups

<http://www.cport.com/~catmandu/lookups.htm>

Norway Lookups

<http://www.rootsweb.com/~wgnorway/lookups.html>

Timeline of Norwegian History

<http://home.eunet.no/~jeri/timeline.html>

Digitalarkivet: Norwegians Living in Minnesota According to 1880 Census

[http://www.hist.uib.no/cgi-win/webcens.exe?nar\\_kivverket/us/minn/1880](http://www.hist.uib.no/cgi-win/webcens.exe?nar_kivverket/us/minn/1880)

\*The following states can also be searched by replacing the letters 'minn' for the code that follows each state in brackets: Dakota (dako), Illinois (illi), Iowa (iowa), Kansas (kans), Michigan (mich), Nebraska(nebr) and wisconsin (wisc).

Emigration from Ullensaker, Norway

<http://home.sol.no/~holum/gen/Ullweb1.htm>

Vestopplands Slektshistorielag

<http://home.lakenet.no/vshl/index.htm>

Who Has the Answer?

<http://www.lawzone.com/half-nor/answer.htm>

Map of Valdres

<http://home.c2i.net/w-206924?valdreskart.htm>

Norwegian Online Information Service

<http://norway.org/>

Norwegian Genealogy Resources

<http://members.xoom.com/follesdal/na2.html>

Norskland

<http://www.norskland.com/>

The Solem, Swiggum and Austheim Ship Index

<http://www.museumsnett.no/mka/ssa/>

Sigdal Emmigrants List 1839-1920

<http://www.netutah.com/akre/sigutvan.htm>

Researching in Austria

Lower Austria GenWeb

<http://www.rootsweb.com/~autnoe/>

German Form Letters

<http://www2.genealogy.net/gene/www/ghlp/muster.html>

Hamburg Emigration Lists

<http://www.hamburg.de/LinkToYourRoots/english/welcome.htm>

?

[http://www.krone.at/family/stammbaum\\_total.html](http://www.krone.at/family/stammbaum_total.html)

German Sample Letters To A Church

<http://www2.genealogy.net/gene/ghlp/let-pas.html#german>

Institute for Family History Research

<http://ihff.nwy.at/index.htm/>

Lower Austria Provincial Archives

<http://www.noel.gv.at/service/K/k2/index.htm>

Austria Internet Links

[http://www.spacestar.net/users/hapander/bb\\_url11.htm#austlinks](http://www.spacestar.net/users/hapander/bb_url11.htm#austlinks)

Austria Genealogy

<http://www.rootsweb.com/~autwgw/agsfr.htm>

Researching in Sweden

American Swedish Institute

<http://www.americanswedishinst.org/>

Swedish Icons

<http://w1.318.telia.com/~u31802832/icons/ico-sweden.html>

Foersamlingarna Kommunvis

<http://www.rsv.se/folkbokforing/forsamlinger/kommunvis.htm/>

Swedish Finn Historical Society

<http://home1.gte.net/SFHS/index.htm>

Landsarkivet i Goteborg

<http://www.ra.se/gla/>

Anno 1890. Folkrakningen 1890 (census?)

<http://www.foark.umu.se/folk/>

SVAR

<http://www.svar.ra.se/>

Swedish Genealogy Homepage

<http://swedishgenealogy.homepage.com>

Map of Sweden showing Landskap and Lan

<http://www.familysearch.org/sg/MSweden.html>

National Atlas of Sweden

[http://www.sna.se/gazetteer\\_advanced.html](http://www.sna.se/gazetteer_advanced.html)

Svenska Kyrkan

<http://www.svkyrkan.se/stift/stift.htm>



Swedish Genealogical Societies  
<http://www.genealogi.se/links3.htm>

Swedish-English Wordlist  
<http://www.geocities.com/Athens/Forum/1284/ordbok.html>

Sweden GenWeb  
<http://www.rootsweb.com/~wgsweden/>

Swedish Genealogical Research-Frequently Asked Questions  
<http://www.cadvision.com/johansss/faqs/>

Ragunda Emmigrant Center  
<http://welcome.to/REC>

Swedish Research outline  
<http://www.familysearch.org/sg/Sweden.html>

Swenson Swedish Immigration Centre  
<http://www.augustana.edu/administration/SWENSON/index.htm>

Swedish-English/English-Swedish Dictionary  
<http://www-lexicon.nada.kth.se/skolverket/swe-eng.html>

Swedish Language Basics for Genealogists  
<http://genweb.net/~turner/dict.html>

Swedish Genealogical Word List  
<http://www.familysearch.org/sg/WLSweden.html>

Swedish Church Records Online  
<http://www.genline.se/eindex.htm>

Parish records  
<http://sd.datatorget.educ.goteborg.se/cdata/regionfo.php3?lang=english>

Swedish Emigration  
<http://www.genealogi.se/emigrant.htm>

## Miscellaneous

Rootsweb Guide To Tracing Family Trees  
<http://www.rootsweb.com/~rwguide/>

FamilySearch Internet Genealogy Service  
<http://www.familysearch.org/>

Ocean Liner Memorabilia Catalogs Online  
<http://www.oceanliner.com/catalogs.htm>

Rootsweb Mailing List Threaded Archive Search  
<http://archiver.rootsweb.com/search.htm/>

Genealogy CD Lookups  
<http://genweb.net/~gen-cds/cdlist.htm/>

PAF 4.0  
<http://www.familysearch.org/OtherResources/paf4/>

Random Acts of Genealogical Kindness  
<http://raogk.rootsweb.com/>

Surname Helper: Search For a Surname  
<http://surhelp.rootsweb.com/schrall.html>

Links to Postal Codes Worldwide  
<http://www.infobook.bc.ca/Postal%20Code%20Directory.htm>

GeneaView  
<http://www.geneaview.addr.com/>

Everton's Genealogical Helper  
<http://www.everton.com/>

Maps  
<http://maps.expedia.com/quickmaps.asp?Tab=2&Region=244&ff=1>

Obituary Daily Times  
<http://www.rootsweb.com/~obituary/>

*See June 2000 Issue for more web site addresses  
by Garth Ulrich.       ++++*

# Immigration Records

BY LOUISE PETSCHULAT

Certified Saskatchewan Researcher of SGS

*Louise presented this lecture at SGS Seminar, October 1999 in Moose Jaw. Printed with permission.*

## SHIP PASSENGER LISTS

Passenger lists, or ship's manifests, are lists of people who came to Canada on a ship that docked at a Canadian port. The information given may be the ship's name, date and port of arrival, possibly the date and port of departure, person's name, age, sex, occupation, where they were from and their destination. Sometimes they show if someone died at sea, or was denied entry into Canada. Sometimes they indicate if they were a member of a specific ethnic immigration group; or if the passage was paid by someone else.

These lists were important to immigration groups at the time to keep track of immigrants who might be bringing contagious diseases. They were also a requirement for ship's captains as they were meant primarily to protect the passengers from disasters and disease. Later, they helped in the maintenance of uniform sanitation, nourishment, shelter and space for the passengers. They provided the Government with statistics on numbers of specific ethnic groups, and a tally for paying immigration agents per head for the people whom they had recruited.

In later years, the original ship's list was often used by the immigrant as his one record to show how long he had been in Canada so he could obtain his Naturalization or Citizenship papers. They may also be the only official documentation for proof of age.

When one searches a passenger list, one should be aware that:

- a name may be spelled as it sounded to a purser
- a person may have later changed the spelling of his name
- ages may be incorrect
- countries of origin may not be specific
- destinations may not be specific

If one knows the name of the ship, the *Ship Notification of Arrival* lists may be checked on mfm T-5460 for eastern ports; and T-4876/T-4877 for Vancouver and Victoria. If one knows the port of entry, the National Archives has a list of which mfm numbers cover specific months and years.

There are four types of Immigration records: (found at the National Archives of Canada)

- 1) Ships passenger lists.
- 2) Land border entry lists.
- 3) Certain special records of child (juvenile) immigration.
- 4) Chinese immigration records 1869-1950.

## Passenger Lists pre 1865

Ship passenger lists were not required by the British government, nor by its colonies. From 1803, the British government did require a ship's captain to list all passengers at his port of departure, and in 1817 from his port of disembarkation; but these were not officially preserved. Most passengers at this time, who were coming to Canada, were from Great Britain, with those from other origins also leaving via Britain. There are a few resources which may be used, and they are listed in Brenda Merriman's book *Genealogy In Ontario: Searching The Records*, pages 136-140.

### **Passenger Lists 1865-1922**

Records were kept at the designated Canadian ports. The lists have been microfilmed and the original documents were destroyed.

### **Passenger Lists 1922-1935**

From 1919-1924, there are individual forms for each person on the passenger list, and much more detail is given; for instance, a physical description, their assets and health. From 1925-1935, they again used modified passenger lists. There are indexes for the records after 1920. Other information given is: immigrant's place of birth, name and address of a relative, friend or employer to whom they were destined, and the name and address of the nearest relative in the country from whence they came.

To access these records, one must write to the Genealogical Unit of the National Archives. One must include as much information as possible; such as: names of those in the family, year of entry; possibly, name of ship and destination and origin.

### **Passenger Lists After 1935**

These remain in the custody of the Department of Citizenship and Immigration in Ottawa. Beginning June 1952, they returned to individual forms and these are indexed alphabetically. In order to receive a copy of one's immigration record after 1935, one must submit a Personal Information Request form (available at Public libraries and Federal Government offices) and \$5.00 registration fee. A certified copy is \$30.00. If for a relative, one must send proof of relationship and proof of death of that person (if deceased more than 20 years ago). If for oneself, the search is free.

### **THE HAMBURG PASSENGER LISTS**

During periods of great emigration, German authorities kept a record of each person who left a German port. Shipping companies were required to record: passengers' names, hometown, age, other family members and occupations. The Bremen lists were destroyed in the World War Two bombing, but the Hamburg lists are available. Those who

embarked on a ship which sailed directly to North America are found on the "direct" lists; and those who sailed first to England, and then left from Liverpool, are found on the "indirect" lists. These are available for the years 1850- 1934. The Family History Library has a Finding Aid to help one find the correct reel. The reels may then be ordered from their library. SGS has a copy of the Finding Aid: *The Hamburg Passenger Lists, Series C, No. 30, 1976*. USA: The Church of Jesus Christ of Jesus Christ of Latter-day Saints, 1977. SGS also has an index to 1910.

### **CANADIAN BORDER CROSSING RECORDS**

These are lists of persons crossing the Canadian-American border at designated Border Crossings. The records are only available on microfilm. They contain: name, age, sex, country of birth, country of citizenship, occupation, place of residence in the USA, destination, value of goods, mode of travel and comments. They also list those who were rejected, and may also note the reason for the rejection.

These are arranged by province-port-year and month of arrival from west to east. Therefore, it is useful to know this data before searching. Not everyone crossed at official ports, so they would not be recorded. Also, the early records were mainly for those who crossed by train. The Finding Aid for ports-dates and reel numbers is on the National Archives web page at <<http://www.archives.ca>>. There is also a Shelf list on pages 134 to 153 in *Ships' Passenger Lists and Border Entry Lists in NAC, RG 76 (Records of the Immigration Branch): Microfilm Finding Aid* published in Ottawa in 1986 by NAC. A reference copy may be obtained through interlibrary loan; or they are available at the Public Library in Regina, the Saskatchewan Archives Board in Regina, and the Saskatchewan Genealogical Society Library.

### **SASKATCHEWAN BORDER CROSSING RECORDS**

Big Muddy                      Sept 1913-Aug 1917 T-5462



Big Muddy	Sept 1917-Dec 1918	T-5462
East Poplar River	Oct 1917-	T-5495
East Poplar River	Sept 1917-	T-5462
East Poplar River	Sept 1918-Dec 1918	T-5496
Marienthal	July 1913-Aug 1918	T-5485
Marienthal	July 1917-	T-5496
North Portal	Dec 1909-Mar 1910	T-5489
North Portal	Apr 1910-Jan 1911	T-5490
North Portal	Feb 1911-Nov 1911	T-5491
North Portal	Nov 1911-Jan 1913	T-5492
North Portal	Feb 1913-Mar 1914	T-5493
North Portal	Mar 1914-Apr 1917	T-5494
North Portal	May 1917-Dec 1918	T-5495
Northgate	Jan 1914-Dec 1918	T-5487
Radville	July 1917-	T-5496
West Poplar River	Dec 1917-	T-5496
West Poplar River	May 1918-July 1918	T-5462
West Poplar River	Aug 1918-Dec 1918	T-5496
Willow Creek	Sept 1917-Dec 1918	T-5502
Wood Mountain	May 1915-Nov 1917	T-5502

### Border Crossing Records 1908-1918

The records of border entries from the USA begin from April 1908. These are available on microfilm from: National Archives of Canada (by inter-library loan), Saskatchewan Archives, Regina Public Library (to the end of 1908). They are not indexed so it is best if one knows the port and date of crossing. It will also help if one knows the place of departure and arrival.

### Border Crossing Records 1919-1935

Individual forms were used for 1919-1924. In 1925, border entry lists were reinstated. The indexes are arranged in quasi-alphabetical order. These records contain more information than previously: immigrant's place of birth, name and address of the relative, friend or employer to whom they were destined, and the name and address of the relative from whence they came. The staff at the Genealogical Unit of the National Archives will do a search, if given sufficient information; such as, identifying details and port of entry or year of entry.

### Border Crossing Records After 1935

These are under control of Citizenship and Immigration (*see Passenger Lists After 1935 information*).

### OTHER SOURCES and helpful information

1. The NAC has a list of the ships that left Great Britain and arrived in Canada. It gives the dates of departure and arrival. Microfilm # T-5460.
2. The *Morton Allan Directory of European Passenger Steamship Arrivals*, Baltimore, Maryland: Genealogical Publishing Co., 1980 (originally published in 1931) is a book containing the names of shipping lines, listed by year, then month and day and American port of all the ships that arrived in the USA (at official ports) from 1890 to 1930.
3. The book *Ships of our Ancestors* by Michael J Anuta, Michigan: Ships of our Ancestors, Inc, 1983, is a collection of prints and photos of the ships which carried immigrants to North America. It gives a Bibliography of resources and some addresses.
4. P William Filby published useful bibliographies; two examples are: *Passenger and Immigration Lists Bibliography 1538-1900: Being a Guide to Published Lists of Arrivals in the US and Canada*, Detroit: Gale Research, 1981. *Passenger and Immigration Lists Bibliography...First Supplement*, Detroit: Gale Research, 1984.
5. The *Quebec Gazette*, on microfilm, may be borrowed from the National Archives of Canada through interlibrary loan. It often recorded the ships docked in harbour and reported on special occurrences. Sometimes, it listed the people in the Quarantine stations.
6. Ethnic Group records. These often contain passenger lists. Many records can be found at the Saskatchewan Archives.
7. Genealogy publications often list a particular ship's list; or an specific group of immigrants.

++++

# Times Have Not Changed All That Much

BY SUSAN R. LEITCH

Almost two hundred years ago, genealogists were already wishing that they had more family records from which to study.

The following poem was recently forwarded to me by my newly discovered fifth cousin, John Wilson of Welland, ON. Mary Magdalen (Secord) Dunn who is making the plea is the great-niece of Laura (Ingersoll) Secord who is renowned for her 20-mile hike in Niagara during the War of 1812. Using a milk bucket for a decoy, she walked through the bush and succeeded in warning the British troops of an impending American attack. Mary (Secord) Dunn is also my great-great-aunt so I hope she is up there smiling because there are at least two of her relatives who value "the few records she was able to get together" and are attempting to leave as much for those a hundred years in the future--documented too!

"Where! Where will be the birds that sing,  
A hundred years to come?  
The flowers that now in beauty spring,  
A hundred years to come  
The rosy lips, the lofty brow,  
The heart that beats so gaily now?  
Oh, where will be love's beaming eye

Joy's pleasant smile, and sorrow's sigh,  
A hundred years to come.

We all within our graves shall sleep  
A hundred years to come  
No living soul for us will weep  
A hundred years to come  
But other men our lands will till  
And others then, our streets will fill  
While other birds will sing as gay  
And bright the sun shine as today,  
A hundred years to come."

Author Unknown

Note at bottom of page: "These verses are copied in this book January 25, 1903. A hundred years from now I shall be forgotten, but I hope some member of the Secord family will value the few records I have been able to get together. Oh, if some of my ancestors had left me as much a hundred years ago."

Clovelly, Queenston Road,  
Mary Magdalen (Secord) Dunn

++++

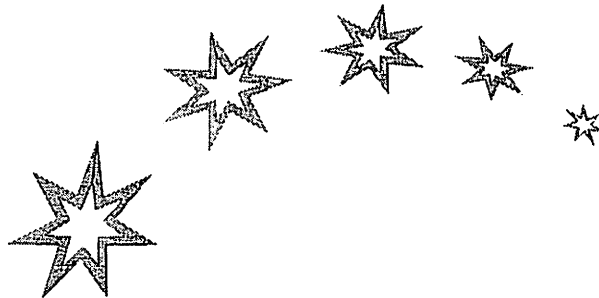

# SGS Library

## *Additions*

BY LAURA HANOWSKI

Librarian

### **Canada**

- The Anglican Church and the World of Western Canada 1820 - 1970. (Book).

### **Canada, British Columbia, Prince George**

- History of Prince George. (Book). Donated by Beth White.

### **Canada: Manitoba, Archie, Miniota**

- Index to the 1901 Census of Manitoba Rural Municipality of Archie and Miniota. (Book).

### **Canada: Manitoba, Blanchard, Saskatchewan**

- Index to the 1901 Census of Manitoba Rural Municipality of Blanchard and Saskatchewan. (Book).

### **Canada: Manitoba, Clanwilliam, Harrison**

- Index to the 1901 Census of Manitoba Rural Municipality of Clanwilliam and Harrison. (Book).

### **Canada: Manitoba, Dauphin**

- Dauphin Valley Spans the Years. (Book). Donated by Beth White.

### **Canada: Manitoba, Ellice, Birtle**

- Index to the 1901 Census of Manitoba Rural Municipality of Ellice and Birtle and the Town of Birtle. (Book).

### **Canada: Manitoba, Hamiota**

- Index to the 1901 Census of Manitoba Rural Municipality of Hamiota. (Book).

### **Canada: Manitoba, Langford**

- Index to the 1901 Census of Manitoba Rural Municipality of Langford. (Book).

### **Canada: Manitoba, Lansdowne**

- Index to the 1901 Census of Manitoba Rural Municipality of Lansdowne. (Book).

### **Canada: Manitoba, Neepawa**

- Index to 1901 Census of Manitoba Rural Municipality of Neepawa. (Book).

### **Canada: Manitoba, Odanah, Minnedosa**

- Index to 1901 Census of Manitoba Rural Municipality of Odanah and the Town of Minnedosa. (Book).

### **Canada: Manitoba, Rosedale**

- Index to 1901 Census of Manitoba Rural Municipality of Rosedale. (Book).

### **Canada: Manitoba, Rossburn, Unorganized Territories**

- Index to 1901 Census of Manitoba Rural Municipality of Rossburn and Unorganized Territories. (Book).

### **Canada: Manitoba, Russell, Silver Creek**

- Index to 1901 Census of Manitoba Rural Municipality of Russell and Silver Creek. (Book).

### **Canada: Manitoba, Shoal Lake, Strathclair**

- Index to the 1901 Census of Manitoba Rural Municipality of Shoal Lake and Strathclair. (Book).

### **Canada: Ontario**

- Bureau of Archives Report 1920. (Book). Donated by Beth White.
- Sesquicentennial of the Amish Mennonites of Ontario 150 years. (Book). Donated by Beth White.

**Canada: Ontario, Brant Co.**

- Brant County. A History 1784 - 1945. (Book). Donated by Rita Chernoff.

**Canada: Ontario, Lanark Co., Beckwith Twp**

- Beckwith: Irish and Scottish Identities in a Canadian Community. (Book). Donated by Frank McLeod.

**Canada: Ontario, Thunder Bay district, Thunder Bay**

- The Thunder Bay Historical Society Eighteenth and Nineteenth Annual Reports. Papers of 1926-27 and 1927-28. (Book). Donated by Beth White.

**Canada: Saskatchewan**

- Atlas of Saskatchewan. (Book). *Do Not Mail*.
- Saskatchewan Genealogical Society Bulletin Volume 29-30, 1998-1999. (Periodical).
- Adanac: The Story of Adanac. (Book). Donated by D. Jean Broadfoot.
- Echoes of the Stake. Carnduff and District. (Book). Donated by South East Branch SGS.
- Forest Hall: Prairie Wool and Pussy Willows Forest Hall, Highworth, Metropole, Mount Hope, Ranger, Whitewood. (Book). Donated by William Sonnenberg.
- Golden Prairie: Golden Prairie Reflections. (Book). Donated by William Sonnenberg.
- Fifty Golden Years 1903 - 1953
- Muenster: A Brief History of the Order of St. Benedict in the Abbacy Nullius of St. Peter Muenster, Saskatchewan. (Book). Donated by Kay Niedermayer.
- Pleasant Valley: Pleasant Valley Memories 1883-1980. (Book). Donated by Bernice Lawrence.
- Regina: Regina Cemetery Walking Tour. (Book).
- Regina: Golden Jubilee Little Flower Parish, Regina, Saskatchewan 1930 - 1980. (Book). Donated by Kay Niedermayer.
- Regina: Golden Jubilee Sacred Heart Parish, Regina, Saskatchewan, Canada 1927-1977. (Book). Donated by Kay Niedermayer.

- Saskatoon: 1928 - 1978 Golden Jubilee of St. Joseph's Church, Saskatoon. (Book). Donated by Kay Niedermayer.
- Theodore: Theodore and District History. (Book). Donated by Bernice Lawrence.

**Europe**

- Society for German Genealogy to Eastern Europe Volume 1, No. 1, December 1998+. (Periodical).

**Europe: Banat, Georgshausen**

- Verlorene Heimat Georgshausen. (Book). Donated by Zichydorf Village Association.

**Europe: Bohemia**

- Dictionary of Bohemian Parishes in the Czech Republic. (Book).
- Register of Vital Statistics in the Czech State Archives Pertaining to Bohemia: Litomerice (Leitmeritz); Pizen(Pilsen); Trebon (Wittingau). (Book).
- Register of Vital Statistics in the Czech State Archives Pertaining to Bohemiz: Prague; Prague District; Zamrsk. (Book).

**Europe: Bukovina/Galicia**

- Gazetteer of the Former Galicia and Bukovina. (Book). *Reference Only*.

**Family Histories**

- Lyster: Lyster Pioneers of Lower Canada and the West. (Book).
- Ottenbreit/Hornung: Family History of Anton & Elizabeth Hornung Ottenbreit 1917-1994. (Book). Donated by Evelyn Vielvoye.
- Rutherford/Thomson/Scott: Porridge and Old Clothes. (Book). Donated by Beth White.
- Yerxa: The Yerxa Family in America c. 1651 to 1986. (Book). Donated by Charlotte Ayers.

**Genealogy**

- Association of Professional Genealogists (APG) Quarterly 1997, 1998, 1999 +. (Periodical).
- Dates and Calendars For the Genealogist. (Book).



# SGS NEWS

## FROM THE OFFICE ...

**BY MARGE THOMAS**

Executive Director

It is anticipated that during the next five years, interest in family history will continue to escalate. This will place greater demands on our staff and volunteers along with higher program access.

Since this is the beginning of a new century and Saskatchewan will soon be celebrating our centennial in 2005, emphasis has been placed on preserving the heritage of Saskatchewan. This in turn has increased the awareness that everyone should collect his or her story.

Thanks to an increase in funding for 2000 from Saskatchewan Lotteries Trust Fund, SGS will meet these challenges by:

- ▶ Hiring a part-time staff to assist in the library and provide continuity for our programming
- ▶ Publish a new Saskatchewan Research Guide-later this year
- ▶ The Family History Fair "**Preserving Family History Beyond 2000**" will return April 8

Plan to attend the Annual General Meeting in Saskatoon April 29.

If you have any questions, e-mail me at [margethomas.sgs@cableregina.com](mailto:margethomas.sgs@cableregina.com) or call 780-9207.

++++



## SURFING THE NET ...

**By Marge Thomas**

Executive Director

SGS site [www.saskgenealogy.com](http://www.saskgenealogy.com)

SGS site developed and maintained by Advance Genealogy Systems <http://www.advanceplus.com>

Since Garth Ulrich has sent an article on web sites, SGS will have no *Surfing the Web* this issue. See page 13.

++++

## Library Assistant

SGS requires a genealogist to assist family historians in the SGS Library in Regina. This is a paid position and is part-time (1/4 - 1/3) to assist during holidays and peak time.

---

The successful candidate will:

- Have basic knowledge of genealogical research techniques
- Have basic knowledge of Saskatchewan/Canadian record sources
- Be willing to take courses to learn research techniques for United States, United Kingdom and Europe
- Be required to take Saskatchewan Certification courses
- Perform library duties

For further information contact: Marge Thomas, Executive Director (306)780-9207 or e-mail: [margethomas.sgs@cableregina.com](mailto:margethomas.sgs@cableregina.com)  
Closing date for competition March 31, 2000.



## Fundraising Campaign

*The following is a list of people who have donated money from November 7, 1999 - December 31, 1999.*

### ***Friends (\$10-49)***

Mrs. Joyce Anaka  
Mrs. Noreen Annett  
Kathryn Arnold  
Hazel Berger  
Marguerite Black  
Bruce Blount  
John W. Campbell  
Elsie Cantelon  
Thora Casey  
Verna Collard  
Madge Crawford  
Mrs. Lily E. Currie  
Mabel Curry  
Frances deMontreuil  
Darrol Driver  
Mrs. Connie Duncan  
Joyce E. Fischer  
M. L. (Mel) Friesen  
Harold Galenzoski  
Raymond Gill  
James A Heal  
James R. Hill  
Vera I. Holmes  
Mr. & Mrs Ken Johnson  
Connie Jones  
Betty Lalonde  
John Marsch  
Ruth Maw  
Mrs. Joan G. Munholland  
Agnes A. Noble  
Arleen Pearson  
Vincent W. & Emily Rempel  
C. Gordon Rook  
Della Sanders  
Lyle Sather  
John & Betty Smith  
Margaret Stark  
Sharon Theriault  
Margaret Thompson  
David J. & Sheila Thornton  
Raymond Twers  
Mrs. Margaret Uzick  
Shirley Van Buskirk

Joyce Veitch  
Pemrose Whelan  
Margaret D. Whitmore  
E. Kathleen Wiebe  
Donald & Erna Wiks  
Carole Murray Williams

### ***Fellows (\$50-99)***

Eleanor Peterson  
Lloyd Rogers  
Leo Schneider  
Judith & Gordon Thomas

### ***Associate (\$100-499)***

Betty M. & James Coldwell  
Evelyn Eberhardt  
Frances Klein  
Susan R. Leitch

### **Special Purchases**

*The following people donated \$10 or more to be put towards a special purchase of their choice.*

Peggy Brown  
Terry Dash  
Frank & Nora-anne Dornstauder  
Barb Drever  
Donna Fleury  
Basil Fritz  
Dean Haack  
Gordon Krattenthaler  
John Molter  
Chris Noll  
John Rick  
Matt Rist  
Ronald Sauer  
James Schafer  
Judy Venables  
Ed Wayling

++++



# Notice of Annual Meeting

To be held 29 April, 2000 at the Parkland Motor Hotels, Saskatoon  
924 Spadina Crescent ( Oak Room)

- |       |  |
|-------|--|
| 10:30 | Coffee & Registration. Silent Auction.   |
| 11:00 | Workshop: <i>Blocked Line? Using Time Lines to Get Back on Track.</i> Presented by Laura Hanowski.   |
| 12:00 | Lunch and Presentation of Volunteer of the Year Award/Education Certificates   |
| 1:00  | Workshop: <i>Privacy Versus The Need to Know Versus The Right to Share Others Information - The Internet and Ethics.</i> Presented by Laura Hanowski.  |
| 2:00  | Refreshment Break  |
| 2:15  | Annual Meeting <ul style="list-style-type: none"><li>- Constitution Changes. See page vi</li><li>- Audited Statement. See page 32</li><li>- Appointment of Auditor</li><li>- Brainstorming</li></ul> |

\* \* \* \* \*

There will be an exchange of the Floater Collection and a large Silent Auction. Please bring your floater books as soon as possible on that day. We will be selling SGS Publications at discount prices on this day only.

We would appreciate your registration as soon as possible. *Registration Fee \$15.00. Includes workshops and lunch.* A block of rooms have been reserved for \$56.00 - single / night for those attending this function until March 29, 2000. When booking the room, advise the hotel that you are attending the SGS meeting.

**REGISTER BY:** April 26 - Guarantee for Lunch

## REGISTRATION FOR SGS ANNUAL MEETING & WORKSHOPS

**Bring your pedigree chart and family unit sheet**

Name \_\_\_\_\_

Address \_\_\_\_\_

City \_\_\_\_\_ Postal Code \_\_\_\_\_

Registration Fee: \$15.00 ☐ Cheque ☐ Money Order ☐ Cash ☐

***Make cheque/money order payable to: SGS***

Mail Registration form and fee to: SGS, PO Box 1894, Regina SK S4P 3E1.



**NOTICE OF CHANGES TO CONSTITUTION  
OF SASKATCHEWAN GENEALOGICAL SOCIETY INC,  
29 April 2000**

At the Annual General Meeting, the membership will be asked to approve the following Constitution change V.2 to:

That meetings be changed to read "A quorum of no fewer than 50% plus one (1) of the total number of **voting members** on the Board of Directors is required for any meeting of the Board of Directors.

The change is being requested to clearly define the term "quorum" for the Board of Directors's Meetings. The question arose since the constitution states the number of seats (maximum and minimum) on a board, there was a confusion with C.--V.2 with respect to "seats".

++++



**Changes At SGS Library/Office**

- **Allergies:** Due to allergies we have requested that anyone coming to SGS Library/Office wear no perfume, cologne or aftershave.
- **Security in Building:** When entering the front door of our building you will notice a security system. Do not get discouraged - just buzz the receptionist, tell her you are coming to Genealogy and she will let you in.

**THE NAUGHTY LIST**

Effective January 2000 those who have not responded to overdue library notices are going to have their names printed in **The Bulletin**. Please show consideration for others by returning your books on time or asking for extensions on the borrowing time.

The following people are on the naughty list:

Ron Davis, Regina  
Marion Ghiglione, Saskatoon  
William Isabelle, Regina

++++

- ▶ *Family Chronicle's* Introduction to Genealogy. (Book). Donated by Christine Krismer.
- ▶ *Family Chronicle* Year Two September 1997 - August 1998. (Periodical). Donated by Christine Krismer.
- ▶ Finding Genealogy on the Internet. (Book). Donated by David Hawgood.
- ▶ Genealogy on CD-ROM. (Book). Donated by Genealogical Publishing Co., Inc.
- Managing a Genealogical Project. A Complete Manual for the Management and Organization of Genealogical Materials. (Book). Donated by Genealogical Publishing Co., Inc.

### **General**

- Help! I've Inherited an Attic Full of History Vol. II: Archival Conservation in the Home Environment. (Book). Donated by Ontario Genealogical Society (OGS).

### **Great Britain**

- An Index of Wills Proved in the Archdeaconry Court of London 1700-1807. (Book).
- Catholic Family History: A Bibliography of General Sources. (Book).
- Catholic Family History: A Bibliography of Local Sources. (Book).
- Ecclesiastical Courts, Their Officials and Their Records. (Book).
- Prerogative Court of Canterbury Wills and Other Probate Records. (Book).
- Records of the Militia & Volunteer Forces 1757 - 1945. (Book).

### **Great Britain: England, Northhamptonshire, Northhampton**

- Northampton the 1<sup>st</sup> 8000 Years. Volume 1 and Volume 2. (Book). Donated by Jack Oglesby.

### **Great Britain: England, East Yorkshire**

- Index to 1851 Census West Sculcoates Vol. 1 - A - J and Vol. 2 - K - Z. (Book).

### **Great Britain: England, Suffolk, Hartsmere**

- Suffolk Marriage Index 1813 - 1837. Volume 10: Hartsmere Deanery. (Book).

### **Great Britain: Ireland**

- Irish Wills and Testaments in Great Britain. (Book).

### **Great Britain: Ireland, Cork**

- Tracing Your Cork Ancestors. (Book).

### **Great Britain: Ireland, Donegal**

- Tracing Your Donegal Ancestors. (Book).

### **United States:**

- A Genealogist's Guide to Discovering Your Female Ancestors Special Strategies for uncovering hard-to-find information about your female lineage. (Book).

### **United States: Dakotas**

- Tracing Your Dakota Roots. A Guide to Genealogical Research in the Dakotas. (Book).

### **United States: Minnesota, Renville Co.**

- Baptism, Confirmation, Marriage and Burial Records Hawk Creek Lutheran Church. (Book). Donated by Garth Ulrich.

++++

### **Parcel**

All parcels are to be sent to the street address: SGS, 1870 Lorne Street Room 201, Regina SK S4P 2L7.

Please ensure that all packages are taped securely before mailing. *Note: You will lose your borrowing privileges if parcels are being returned and NOT packaged properly.*

# Book Reviews

BY LAURA HANOWSKI

Librarian

***HELP! I've Inherited an Attic Full of History: A guide for genealogists - and - others- on ways to hand the past on to the future. Volume II: Archival conservation in the home environment.*** By Althea Douglas. Published by The Ontario Genealogical Society, 40 Orchard View Boulevard, Suite 102, Toronto, Ontario M4R 1B9. 1999, vi, 94pp, 8 ½" x 7", illustrations. Softback. Price: \$16.00, OGS Member price: \$13.00. Non-Canadians to pay in US funds. Those paying in U.S. funds may deduct 20% from the total cost. Postage and packing: In Canada \$3.00 first item + \$.75 each additional item. Canadians must add 7% GST to both book and postage charges. Outside Canada \$4.50 first item plus \$1.50 each additional item.

This book begins with the premise "Never Do Anything That Cannot Be Undone Without Harming the Object" and "Be Careful When Handling Anything That Can Harm You."

With this in mind, and many pairs of cotton-knit gloves and a face mask, you may prevent damaging yourself and your precious artifacts. Use the book to learn which simple conservation procedures you can safely carry out yourself and which ones you should leave to a professional. I would strongly recommend having both Volume I and II of these reasonably priced books within easy reach when you are examining your family sources.

***Genealogy on CD-ROM.*** By Marthe Arends. Published by Genealogical Publishing Co., Inc. 1001 N. Calvert St., Baltimore, MD 21202. 1999, 258pp, 8 ½" x 11", illustrations. Softback. Price \$24.95. Postage & handling (US only): One item \$3.50; each additional book \$1.75. International orders (including Canada): Contact them for details.

This guide begins with some valuable advice about the use of CD-ROMs for genealogical research. The remainder of the book is organized by subject listings. Each listing includes the title, publisher, price, system requirements and a description of the contents. While most of the listings are for US based CD-ROMs there are some entries for Canada, Australia, New Zealand, Ireland, England, Sweden, France, Germany, Poland and

Spain. There is a symbol to indicate which CD-ROMs the author has investigated herself.

***Managing A Genealogy Project. A Complete manual For the Management and Organization of Genealogical Materials.*** By William Dollarhide. Published by Genealogical Publishing Co., Inc. 1001 N. Calvert St., Baltimore, MD 21202. 1999, 82pp, 8 ½" x 11", illustrations. Softback. Price \$14.95. Postage & handling (US only): one item \$3.50; each additional book \$1.25. International orders (including Canada): Contact them for details.

This is an up-date of the popular *Managing a Genealogy Project*. The book provides you with concrete advise about how to start your genealogy project and how to organize you research papers. It also provides you with examples of the accepted numbering systems used to-day along with samples of the various charts and logs that will aid you with organizing your present research.

***Finding Genealogy on the Internet.*** By Peter Christian. Published by David Hawgood, 26 Cloister Road, Acton, London W3 ODE. Web Address <http://www.hawgood.co.uk> 1999, 20pp, A5, illustrations. Order from Family Tree Magazine, 61 Great Whyte, Ramsey, Huntingdon, Cambridgeshire PE17 1HL England <http://www.family-tree.co.uk> Price including postage overseas surface £2.39, surface £2.94. Also available on-line from the Society of Genealogists at <http://www.sog.org.uk>

The aim of this book is not to explain what the Internet is but to help you get the best out of those tools for your family history once you've got started. It will help everyone, from a family historian using the Internet for the first time to the computer expert. There is a comparison of different search methods and sites including directories, search engines, GENUKI, On-line Databases, Discussion Groups, Finding Surname Interest and Finding Living People. The examples used are UK based but there are two pages of Internet addresses that can help you with your searches anywhere in the world. I have found this book most helpful for myself and for teaching others about how to use the Internet effectively.

++++

# The Naming of "The Lost - Horse Hills"

BY PEGGY LITTLE LIVINGSTON

*Kathy Robertson, who is a member of SGS, thought this article would be of interest to our members. Permission was granted by Peggy to publish article as written by Robert L. Gibson, Great Falls, Montana.*

"Old Timers" will remember the summer of 1889 as one of the hottest and driest summers ever experienced in old Assiniboia. I only remember day after day those sizzling heat waves we could see rising in the distance. Father would say, "I'm sure that heat is coming right up from the Gulf of Mexico."

Not a blade of grass grew that summer. I can remember the ground at our door burning my bare feet. Many were the anxious inquiries among the settlers: "What is to be done for fall?" We had 400 sheep and a herd of cattle and horses. About the first of July, a council-of-action was called to assist the few living just north of what is now Alameda.

My brother and two neighbours were delegated to go on a trip of discovery. Food was cooked and prepared for at least a two-week trip.

They decided to go north towards the Moose Mountains. They found all hay lands were taken in the mountains north of Carlyle and all along the mountains west. So, they rounded through the pass west of where George Smith was settled.

Matt Morrison was on Moose Creek and had a shack up there. The party continued on up Moose Creek till they came to a hay marsh just northeast of Lost Horse Hills. The hay was splendid, and I suppose it grows there to this day - broad leaf in big tufts and moss. They dug a small well in the creek about one and a half miles south of the hills where camp was to be situated. They found frost at three feet in sinking the shallow well. There was six

inches of dry grass that protected it from the hot sun. They then returned home to Alameda to report on the find. They got everything ready to return to cut and stack the hay, which they completed about the middle of August.

Mr. John Gruscott and I returned to Alameda to build sod buildings, which we completed in 30 days. We built a large sheep shed, two stables - 30 x 50, and also built a large sod shack. I was only 17 years old and they wondered if I would stand the heavy work, but I did. We had to go to a large ravine about four or five miles east or northeast for poles for roofing. In this coulee, many buffalo had been killed as many bones and skulls were lying in the bottom of the ravine in wild profusion. Apparently, the buffalo had been driven over the steep banks and shot. This was a favorite way to do it. We completed the buildings by November 1 and left to notify them at Alameda that all was ready for winter. The return trip with the stock was quite tedious but eventually, we got all the stock safely to winter quarters.

My mother, father, sister Josie (now Mrs. A. G. Paul, Alameda) my brother Porter (now Credit Manager for Security Lumber Co., Moose Jaw), Mr. Wm. G. A. Deyell and myself composed the wintering party. Mr. Deyell moved back to Ontario and since has passed away.

We settled in our quarters nicely for winter. We had a good supply of meat that winter, having had to kill off all our poultry, ducks, turkeys and chickens, also hogs. The stock did well and put on flesh. The hay was the best I ever saw - prairie hay. The milk was like off fresh grass. The butter was a lovely dark orange.

We went through the usual routine of rural life. We dug a well 16 feet deep and had the finest water possible to find in any country and an abundance of



it. Around the middle of January, we caught 187 pike in a spring down the creek from where the buildings were situated. This was a fine addition to our supply of meats. About this time also, one bright sunny day, we saw a herd of 22 deer moving along the contour of the hills. We went hunting that afternoon and bagged two. That winter we got seven altogether. You can imagine how well fed we were, with seven kinds of meat to choose from: beef, pork, ducks, turkeys, chickens, fish and venison. Could anyone ask for better? My mother was a lavish cook and we enjoyed our meals out in the wilds.

Only one person called on us all through that winter. This person was Sam Hopper of Arcola. He drove up in a jumper<sup>1</sup> about the middle of December.

Winter passed away quite swiftly. We had one awful storm on February 9, 1890, one of those that come up with the swiftness of a hurricane. At the time, Porter was down at the spring where we caught the fish, watering the cattle. We all thought he was a "goner," but he was a wise kid, then only 14 years old. He grabbed a cow's tail and hung on, and the cattle led him back to the buildings. One poor old ox could not make it back and we found him dead next day, on his back, with his four feet up straight in the air. A man had overworked him, or he would have withstood the ordeal, we thought. The ox's name was Jonathan. We named him that in fun.

Spring came, and all the rest of the party went back to Alameda with the horses and cattle. My brother Porter and I stayed to keep the sheep until the roads allowed us to go home. We made many trips to "The Lost Horse Hills" during the month or five weeks we stayed behind. These hills had a fascination for us so, one bright day we climbed to the top of the large rough butte on the west end - "a noble pile of earth." While looking around, I spied a burnt match, and I turned to Porter and said, "Someone has been here and the only thing that would bring them would be hunting horses." I said "Let's name these hills, Lost Horse Hills." So we gathered rocks and printed out the name, April 1890 - 49 years since last April.

We used to go up there to see if we could spot any living things, anything human. We were lonesome to see someone in those days of isolation, but we never saw a living soul. It was solitude indeed; and I can sense that feeling right now, so still, just as nature made it. The Indians used this hill down the ages as a lookout post for game and enemies. So far as the formation of the hill is concerned, my opinion is that a great glacier hung just north of the hills and protected the levelling of the formation as the plains by the great run off. This part of the west, to my mind, was a great big mud puddle. The Moose Mountains were formed in the same way. In particular, the south side is abrupt. The ice must have melted away and left it as it is, with a fairly straight fall.

We started on our journey home May 1, 1890, with 400 sheep. I think those sheep were the first ever brought into Saskatchewan. We had a slow, very tortuous journey and arrived May 10. We were very glad to get back. Little lambs were born the last two days of our trip, so we had to deposit them in boxes and boilers in the wagon. Mother said there was a lamb in every nook and corner.

I forgot to say we found the remains of the last buffalo killed in Saskatchewan. This buffalo was shot and wounded by a man named Hazzard who homesteaded near the "Gap" but the buffalo got away and crossed Moose Creek, and Hazzard never could find it. I told him about finding some remains. He said, "No doubt it was the one I shot." He shot it in 1886 and this was in 1890. We found the remains about ten miles south of our camp west of Moose Creek. My father had a close call with his life with a buck deer just west of Lost Horse Butte. The deer was wounded, and it dashed at him. He warded it off with his rifle and it dropped dead at his feet. This deer had plenty of horns too.

I look back on those days of pioneering with satisfaction, having been privileged to live through it and see things in the making. ++++

---

<sup>1</sup> A jumper is a simply constructed sleigh on low wooden runners. *Gage Canadian Dictionary*.

# The 1935 Federal Electoral Roll for Disley, Stony Beach and Keystown, Saskatchewan

TRANSCRIBED BY KENNETH G. AITKEN

This 1935 voters list covers the eligible electors of Federal Rural Polling Division Number 11, of the Lake Centre Electoral District. This division comprises township 18, and that portion of township 19 south of the Qu'Appelle River, in range 23 west of the 2nd meridian. The Polling Station appears to take its name from the Fairville School District.

The village of Disley is located just east of this polling district. The Canadian National Railway's siding of Keystown, (named for the Keys family in this list falls in the polling district) and in 1935 the post office was located at Section 11, Township 18, Range 23 West of the 2nd Meridian. Stony Beach is a hamlet in the northwest quarter of Section 30, Township 17, Range 28 West of the Second. However, the Stony Beach Post office located at Section 6, Township 18, Range 23 West of the 2nd falls within the polling district.

Many of these families are mentioned in *Pense Community 1882-1982*, a copy of which can be

found in the Prairie History Room of Regina Public Library. Those families that were in the area in the early 1920s will be listed in Mona Morrow's *Index of names Located on Cummins Rural Directory Map, 1922 Issue of the Regina Area in Saskatchewan* (Regina: [Mona Morrow] 1990).

The value of voters lists like this is that they are perhaps the best substitute of nominal census returns in times when censuses are not available. As the immediate future of public access to 20th century Canadian census returns is rather bleak, lists like this one are going to be of greater value to the genealogist in the new century ahead. Elsewhere I have described the process of locating 1935 federal electoral rolls and locating the appropriate constituency and polling station.

If you would like to see this listing for yourself you will need Microfilm reel: M-4763 which is available in the Prairie History Room at the Regina Public Library.

Name	Occupation	Nearest Post Office
Allen, Nellie Miss	teacher	Stony Beach
Anderson, L.H.	farmer	Disley
Anderson, L.H. Mrs.	married woman	Disley
Baird, J.A.	farmer	Keystown
Baird, J.W.	farmer	Keystown
Baird, J.A. Mrs.	married woman	Keystown
Bloomingdale, Mrs	widow	Stony Beach
Bowie, W.M. Mrs.	married woman	Keystown
Bowie, W.M.	farmer	Keystown
Bowman, Henry	farmer	Disley
Brooks, John	farmer	Keystown
Brooks, Gerald	farmer	Keystown
Brooks, J. Milton	farmer	Keystown
Brooks, Gerald Mrs.	married woman	Keystown
Brooks, Willard G. Mrs.	married woman	Keystown

<b>Name</b>	<b>Occupation</b>	<b>Nearest Post Office</b>
Brooks, Willard G.	farmer	Keystown
Cairns, P. Miss	spinster	Disley
Cairns, D.	farmer	Disley
Cairns, John	farmer	Disley
Cairns, Neil	farmer	Disley
Cairns, Neil, Mrs.	married woman	Disley
Campbell, Jean Miss	spinster	Keystown
Campbell, Andy A.	farmer	Disley
Campbell, Archie	farmer	Disley
Campbell, Dan A.	farmer	Disley
Campbell, G. H. Mrs.	married woman	Keystown
Campbell, G. Norman	farmer	Keystown
Campbell, George H.	farmer	Keystown
Campbell, Harvey J.	farmer	Disley
Campbell, L. Miss	spinster	Disley
Campbell, W.K.	farmer	Keystown
Campbell, W.K. Mrs.	married woman	Keystown
Doan, Burton	farmer	Stony Beach
Doan, Burton Mrs.	married woman	Stony Beach
Doan, George K.	farmer	Stony Beach
Doan, John Mrs.	widow	Stony Beach
Doan, L.A. Mrs.	married woman	Stony Beach
Doan, Lyle A.	farmer	Stony Beach
Doan, Robert	farmer	Stony Beach
Edit, Lew	farmer	Keystown
Edit, Lew Mrs.	married woman	Keystown
Elhi, Mrs.	widow	Disley
Fletcher, Dan	farmer	Stony Beach
Fletcher, Dan Mrs.	married woman	Stony Beach
Fletcher, William	farmer	Stony Beach
Gilmore, Alex	farmer	Disley
Gilmore, Andy	farmer	Disley
Gilmore, E. Miss	spinster	Disley
Gore, G.A.	farmer	Disley
Gore, George	farmer	Disley
Gore, George Mrs.	married woman	Disley
Hammond, Cecil J.	farmer	Stony Beach
Hilts, Percy	farmer	Keystown
Hogg, Alfred	farmer	Stony Beach
Hogg, Alfred Mrs.	married woman	Stony Beach
Irving, Ada Miss	spinster	Stony Beach
Irving, James	farmer	Stony Beach
Irving, James Mrs.	married woman	Stony Beach
Irving, John	farmer	Stony Beach
Jackson, C.E. Mrs.	married woman	Keystown

<b>Name</b>	<b>Occupation</b>	<b>Nearest Post Office</b>
Jackson, Charles E.	farmer	Keystown
Kay, E. Mrs.	widow	Disley
Keller, H.	farmer	Disley
Keller, Jake	farmer	Disley
Keller, Jake Mrs.	married woman	Disley
Keys, Dave	farmer	Keystone
Keys, George S.	farmer	Keystone
Keys, George S. Mrs	married woman	Keystone
Keys, Jack	farmer	Keystown
Keys, Joe	farmer	Keystown
Keys, Joe Mrs.	married woman	Keystown
Kurek, J.J.	farmer	Disley
Kurek, J.J. Mrs.	married woman	Disley
Kurek, S.	farmer	Disley
Kurek, S. Mrs.	married woman	Disley
Lawton, H.A.	farmer	Keystown
Lawton, J. Mrs.	married woman	Keystown
Lawton, J.	farmer	Keystown
Lawton, W.G.	farmer	Keystown
LeBrun, H.	farmer	Keystown
Martin, A.	farmer	Disley
Martin, A. Mrs.	married woman	Disley
Maxwell, J. B.	farmer	Stony Beach
McEwan, J.D.	farmer	Keystown
McEwan, J.D. Mrs.	married woman	Keystown
Menzie, Peter	farmer	Stony Beach
Menzie, Robert	farmer	Stony Beach
Menzie, Robert Mrs.	married woman	Stony Beach
Peterson, H.	farmer	Keystown
Peterson, H. Mrs.	married woman	Keystown
Pettigrew, Mrs.	widow	Stony Beach
Read, G.W.	farmer	Stony Beach
Read, G.W. Mrs	married woman	Stony Beach
Read, Jenny Miss	spinster	Stony Beach
Read, John Mrs.	widow	Stony Beach
Read, N.M.	farmer	Stony Beach
Read, W.C.	farmer	Stony Beach
Read, W.C. Mrs.	married woman	Stony Beach
Robson, J.G.	farmer	Disley
Rogne, M. Miss	spinster	Stony Beach
Rogne, Tom	farmer	Stony Beach
Rogne, Tom Mrs.	married woman	Stony Beach
Ross, T.J. Mrs.	married woman	Stony Beach
Ross, T.J.	farmer	Stony Beach
Ross, T.O.R.	farmer	Stony Beach

<b>Name</b>	<b>Occupation</b>	<b>Nearest Post Office</b>
Schuler, William	farmer	Stony Beach
Scott, Alex	farmer	Keystown
Scott, Alex Mrs.	married woman	Keystown
Scott, G.	farmer	Keystown
Scott, G. Mrs.	married woman	Keystown
Scott, George	farmer	Keystown
Scott, John Jr.	farmer	Keystown
Scott, John Jr. Mrs.	married woman	Keystown
Scott, John Sr.	farmer	Keystown
Scott, John Sr. Mrs.	married woman	Keystown
Shropshire, H.	farmer	Keystown
Shropshire, R.E.	farmer	Keystown
Shropshire, R.E. Mrs.	married woman	Keystown
Shropshire, W.A.	farmer	Keystown
Skelton, Fred	farmer	Stony Beach
Street, George Mrs.	widow	Stony Beach
Street, Melville	farmer	Stony Beach
Street, V.L.	farmer	Stony Beach
Street, V.L. Mrs.	married woman	Stony Beach
Street, William	farmer	Stony Beach
Symes, Oliver	teacher	Keystown
Therm, Walter	farmer	Disley
Therm, Walter Mrs.	married woman	Disley
Thompson, H.J.	farmer	Disley
Thompson, H.J. Mrs.	married woman	Disley
Turnbull, Mark	farmer	Disley
Turnbull, Mark Mrs.	married woman	Disley
Vance, K. Miss	teacher	Disley
Wallace, Burton	farmer	Stony Beach
Wallace, Burton Mrs.	married woman	Stony Beach
Wilkie, Donald	farmer	Disley
Wilkie, Dunk	farmer	Disley
Wilkie, Ida Miss	spinster	Disley
Wilkie, L.E.	farmer	Disley
Wilkie, M. Miss	spinster	Disley
Wilkie, Neil	farmer	Disley
Wilkie, Neil Mrs.	married woman	Disley
Wilkie, W.	farmer	Disley
Wilson, G.S. Mrs.	married woman	Keystown
Wilson, George S.	farmer	Keystown
Wilson, J. Mrs.	widow	Keystown
Wilson, S. Mrs.	married woman	Keystown
Wilson, Sid	farmer	Keystown
Wilson, William	farmer	Keystown

## References

Aitken, Kenneth G., "The 1935 Federal Electoral Rolls for the Constituency of Assiniboia" *Saskatchewan Genealogical Society Bulletin* Vol. 23 No.2 (June 1992) pp.65-71.

Barry, Bill, *People Places: A Dictionary of Saskatchewan Place Names*. Regina: People Places Publishing, 1998.

National Archives of Canada, *Dominion Franchise Act, List of Electors, 1935; Electoral District of Lake Centre, Rural Polling Station No. 11 Fairville*, microfilm number M-4762.

Hunt, Jenny and Mona Wood (editors), *Pense Community 1882-1982*. [Pense, Sask.: Pense Community History Committee, 1982].

Morrow, Mona, *Index of Names Located on the Cummins Directory Map, 1922 Issue, of Regina Area in Saskatchewan*. Regina: [The Author], 1990.

Robinson, William G., *Saskatchewan Post Offices* Vancouver: William Topping, 1987.

++++

---

## Birth Briefs

Have you ever wondered how people proved who they were and how old they were before the days of civil registration? It is likely true that very few people were called upon to prove that they were who they claimed to be in those early days. A Birth Brief was used by individuals who needed to provide proof of their identity. These were documents that were created by having witnesses swear under oath before magistrates of the town, that the family and the individual were known to them personally, and that they were willing to verify that the claim to kinship was honest.

Many people were attracted to Eastern Europe as merchants, soldiers or business enterprises and later might want to prove they were from an

important or a respectable family. Perhaps a member of the family expired in a foreign land leaving no heirs, and local members of the family, would need a brief to prove they were entitled to the estate.

The SGS library has acquired a copy of Birth Briefs of Aberdeen 1637-1705 that makes interesting reading. Under Innes, Walter there is a detailed account of relationships between several families, a member of which was a Catherine Pitendrich. The only dates that appear is the one when the certificates was "extended in ample form".

++++



# Looking For Ancestors

DEEP shadows post farewell to parting day,  
Solemn tolls the church clock from the tower high;  
I put away my pen and wend my way  
From the silent graveyard where my ancestors lie.  
Night owls swoop and hoot their raucous calls;  
Bright fireflies come dancing on the air;  
Inside these timeworn, friendly, grey stone walls,  
Generations of my forebears lie a-sleeping there.  
'Neath sturdy oaks and ancient elms they rest,  
Midst crumbling, tumbling, flaking, rough-hewed stones;  
And weary, but exultant, in my quest,  
I pay my lonely tribute to their perished bones.  
Where now I stand in tranquil meditation,  
Once walked a merry host of kinsfolk grand;  
Many a village swain did find his inspiration  
To woo a fair young lass, a-strolling hand in hand.  
Their names have all but vanished now,  
Who once did tread these paths with strides so bold;  
Yet they bequeathed to us a fleeting vow  
Of better lives and dreams, these steadfast folks of old.  
Soft moonlight strays across the muted churchyard,  
Sends eerie shadows flickering through the trees,  
And if I raise my head and harken hard  
The voices of my forebears come whispering on the breeze.  
Now far too soon the cloaking night has come,  
My search must end, alas, to my deep sorrow;  
But, rest assured, until my quest is done  
I will be here again upon the morrow.

Courtesy of the author Roy Stockdill of Hertfordshire UK

## Saskatchewan Local History Books

A committee has been struck for a millennium project to develop a bibliography of all local history books ever published in Saskatchewan.

SGS is a member of the committee and is asking its members to support this project . We ask that you send us information on Saskatchewan local history book collections and any local history books that you may have in your collection or know about. We need the following information: complete name of book, location(s) covered, publisher, printer, date published and number of pages.

For more information contact Marge at (306)780-9207 or e-mail:  
[margethomas.sgs@cableregina.com](mailto:margethomas.sgs@cableregina.com)

# Cemetery Program

**BY LINDA NEELY**  
Cemetery Coordinator

In 1999 the cemetery program totals were boosted to 3,096 located, 1,838 recorded and 736 entered into the SRI database. We now have maps for all but four RM's. The remaining ones are #17, 40, 372 and 404. A big thank you to everyone who contributed maps and to the Grenfell Branch who have been working very hard on the map collection.

The RM maps we have for the following RM's are 20-30 years old. We would like current maps if possible: 1, 9, 12, 35, 99, 101, 103, 107, 111, 122, 123, 124, 139, 141, 154, 155, 157, 161, 169, 171, 181, 183, 211, 219, 230, 232, 241, 243, 244, 245, 247, 273, 274, 279, 286, 287, 305, 310, 315, 342, 345, 347, 350, 367, 401, 426, 458, 463, 464.

We have expanded the web site information a little bit by adding the last burial date (if known) in addition to the recording date. This will help researchers in narrowing down information, as often the last burial date is many decades before the

cemetery was found and recorded. There are about thirty (30) visitors a day to the cemetery index, so we know it is being used. Thank you to our SGS volunteers who help to enter the web site data, it is a continuous job and there always seems to be changes to be made with each update, which happens about twice a year. *If you have some free time on your hands, we need some more volunteers to help in entering the cemetery data onto the SRI. You may do this from your home.*

As always it is the SGS volunteers who really make the cemetery program happen and I extend the Society's thanks and appreciation.

Please feel free to contact me at [lnelly@cableregina.com](mailto:lnelly@cableregina.com) if you have any stories about recording, information about cemeteries or questions about cemeteries. I'll be glad to get them.

++++

---

## What Does That Mean?

**Inst.** Or **instant** [in a date] refers to something that happened in the *current* month. **Ult.** or **Ultimo** [in a date] refers to something that happened in the *previous* month.

When reading French-language records, the adjective "**feu**" found before a man's name and

"**feue**" before a woman's name indicates that the person is deceased [as in the late John Smith].

*Adapted from The Tree Tracer, Prince George Genealogical Society, Vol.20, No.3 (September 1999).*

++++

# Computer Corner

BY CHRIS KRISMER

Recall the saying, "Patience is a virtue."? Whether you are entering data and sourcing, waiting for someone to answer a letter or surfing the net, you must be patient.

Careful data and complete source entry means you won't likely have to redo or go over your work again. Complete sourcing results in easier access to your source, should you need to go back again or if you pass it on to someone else. The same applies to the software you choose. A careful study of what is available with an idea of what you expect to do with your data will help you when you are working with your program. It is frustrating to go into a store expecting to have choices and to find there are very few, if any. I also question choices, when the same company owns the rights to several programs. That in itself need not be a problem, if upgrades are done so that a program keeps its distinctive style. Just as a matter of information Broderbund now owns Family TreeMaker, Family Origins and one more, if I am correct.

For your interest I am giving you an Internet site that you can visit for a listing of many of the genealogy software programs available for your use. Pros and Cons of the programs are given for some and you can download a demo of any you may wish to try: <http://www.gensoftsb.com/>

They had a list of Mac programs. One of those programs may interest some. It is GENE, a shareware program. You can find it at: <http://www.ics.uci.edu/~eppstein/gene/>

What I would like to deal with mainly in this article is – using your software to its potential. I know most of us have not done this or even tried many of the features. What kind of charts or print outs is your program capable of and what would you like to be able to do, do you know?

We recognize that we can print group sheets, individual sheets, and descendancy or ascendancy outlines. We can print out generation reports. Timelines can be very interesting, especially if you incorporate your family times lines with historical time

lines. A general overview of the events and the times of a family can be combined with descendancy charts of son # 1, son #2, and daughters. Each of these can have pictures and stories incorporated. You may use some of these when going on a research trip – lots of information on less paper.

Have you ever exported your generation report to a RTF (rich text file), opened it in your word processor and then embellished or edited it? This can easily be done with each family member as a unit or as one big report of all the ascendants or descendants of one person. Again, when you are trying all of these things with your program, be patient. If a particular format doesn't appeal, try another.

Perhaps the only drawback to this may be that should you make changes in the data, notes or sources in the program, you don't automatically get the changes in your writing. You have to start over and you cannot carry the editing done in the word processor back to the program. A major editing would likely not want to be done until you are ready to publish. As you are working with your program, try some of these features with a small group or family. You may be pleasantly surprised at what you can produce.

When printing out pedigree charts or ancestral charts you may want to check what options you have. If there are say three or four of you as siblings, you may want to start with the siblings list and print out the chart from there. In that way the same sheet can be copied or shared with your siblings and no one has to be offended because their name doesn't appear in the number one spot – you are all there. Printing pedigree or ancestry charts with three or four generations on a page will allow you then to print another pedigree chart with the last ancestor as number one, thus going back as far as you want and still having a nice typed chart that is easy to follow. In some programs, you can print out a six or eight page pedigree chart that then requires you to tape it together to make one big chart. One of these at home on a wall is fine but it is not as convenient to use when you are going on a research trip.

I came across this little tip that may interest some of you. It relates to keeping a log of your research on the computer in NOTEPAD. Notepad has a feature that allows you to date and time stamp each time you open a file. Here's how to do it:

1. Open a new notepad document.
2. Type .LOG on the first line.
3. Save as – use whatever file name you choose and remember where you are saving it.
4. Now close it and reopen it.

You should see the current time and date stamped there waiting for your journal entry, research notes or whatever. When you have filled the document up with entries, you can start another in the same way. The text including date and time stamp can be copied and pasted into your favorite word processor or genealogy program whenever you like. It really saves work and saves a lot of time. Try it.

## Internet

Here again, you need to be patient. There are times of the day when the Internet highway is busier than other times. This means travel will be slower. Another thing that sometimes happens is addresses change and what was a correct address today may not be tomorrow. It is a good practice to bookmark sites you may want to go back to or that you may find interesting but do not have the time to search presently. If the site doesn't prove worthwhile after you have book marked it – remove the bookmark.

Listed below are some world wide web pages that may be of interest to you. Some are new, some are for beginners, some have links to other pages, but all are worth looking at.

<http://www.rootscomputing.com>  
<http://www.bluepost.tcimet.net/hodges/>  
<http://www.westgarth.org.uk>  
<http://msnhomepages.talkcity.com/PicnicPl/ian61/>

### Phone Numbers:

<http://www.ancestry.com/search/rectype/directories/eurotel/main.htm>

<http://www.ancestry.com/search/rectype/directories/eurotel/main.htm>

### Beginner Sites:

<http://www.ancestry.com/search/advsearch.htm>  
<http://www.ancestry.com/learn/main.htm>  
<http://www.ancestry.com/save/main.htm>  
<http://www.familyhistory.com>

### Maps:

<http://mapping.usgs.gov/www/gnis/gnisform.html>

### Others:

<http://www.rootsweb.com/newbice/>  
<http://www.familysearch/sq/>  
<http://www.nara.gov/genealogy/>  
<http://www.myfamily.com>

There are also chat lines that you may wish to join.

I cannot emphasize enough the importance of making sure your data is correct and well sourced before you share it with anyone, especially if you choose to put your family tree on the Net. It is doubly important that whatever you enter into your information from the Net is accurate and complete with sources! More and more genealogy pages are being uploaded to the Net. It is your responsibility to keep your tree accurate. With the ease with which we can communicate you can easily see how inaccurate information can be spread very quickly.

One final address for you that is constantly improving and expanding, thus giving you all kinds of help for genealogy research, is Cyndi's Home Page. The web site is: <http://www.cyndislist.com>

She has over 50,000 links to almost anything or anywhere you may wish to search – a site well worth book marking and visiting often.

++++

## AUDITORS' REPORT

To the Members of  
Saskatchewan Genealogical Society Inc.

We have audited the balance sheet of **SASKATCHEWAN GENEALOGICAL SOCIETY INC.**, as at December 31, 1999 and the statements of revenue, expenditures and surplus and cash flows for the year then ended. These financial statements are the responsibility of the society's management. Our responsibility is to express an opinion on these financial statements based on our audit.

We conducted our audit in accordance with generally accepted auditing standards. Those standards require that we plan and perform an audit to obtain reasonable assurance whether the financial statements are free from material misstatement. An audit includes examining, on a test basis evidence supporting the amounts and disclosures in the financial statements. An audit also includes assessing the accounting principles used and significant estimates made by management, as well as evaluating the overall financial statement presentation.

In our opinion, these financial statements present fairly, in all material respects, the financial position of the society as at December 31, 1999 and the results of its operations and its cash flows for the year then ended in accordance with generally accepted accounting principles.

  
E.J.O. Dudley & Co.  
Chartered Accountants

Regina, Saskatchewan  
January 25, 2000

## SASKATCHEWAN GENEALOGICAL SOCIETY INC. Balance Sheet As at December 31, 1999

ASSETS		1999	1998
<b>CURRENT ASSETS</b>			
Cash		\$102,041	\$ 95,802
Accounts receivable		1,888	2,197
Inventory - cost		5,619	4,970
Total Current Assets		<u>109,548</u>	<u>102,969</u>
<b>CAPITAL ASSETS - note 4</b>			
Equipment		68,070	72,661
Less accumulated depreciation		<u>62,309</u>	<u>66,457</u>
Net Capital Assets		5,770	6,204
Total Assets		<u>\$115,318</u>	<u>\$109,173</u>
<b>LIABILITIES AND MEMBERS' EQUITY</b>			
<b>CURRENT LIABILITIES</b>			
Accounts payable		\$ 2,924	\$ 3,135
Deferred revenues - note 3		<u>82,368</u>	<u>77,376</u>
Total Liabilities		<u>85,292</u>	<u>80,511</u>
<b>MEMBERS' EQUITY</b>			
Surplus - page 3		24,256	22,458
Equity in capital assets - note 2		<u>5,770</u>	<u>6,204</u>
Total Members' Equity		<u>30,026</u>	<u>28,662</u>
Total Liabilities and Members' Equity		<u>\$115,318</u>	<u>\$109,173</u>

Approved on behalf of the Board:

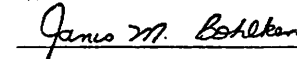
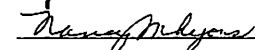
 Director  
 Director

## SASKATCHEWAN GENEALOGICAL SOCIETY INC. Statement of Revenue, Expenditures and Surplus For the year ended December 31, 1999

	1999	1998
<b>REVENUE - page 7</b>		
Administration	\$153,359	\$151,673
Programs	<u>31,142</u>	<u>19,799</u>
Total Revenue	<u>184,501</u>	<u>171,472</u>
<b>EXPENDITURES - pages 8 and 9</b>		
Administration	88,019	86,438
Travel and meetings	5,097	8,568
Membership communications	10,862	10,581
Programs	75,722	62,680
Equipment purchases	<u>3,003</u>	<u>2,705</u>
Total Expenditures	<u>182,703</u>	<u>170,972</u>
<b>EXCESS REVENUE</b>	1,798	500
<b>SURPLUS - beginning of the year</b>	<u>22,458</u>	<u>21,958</u>
- end of the year	<u>\$ 24,256</u>	<u>\$ 22,458</u>

**SASKATCHEWAN GENEALOGICAL SOCIETY INC.**  
Schedule of Revenue  
For the year ended December 31, 1999

	<u>1999</u>	<u>1998</u>
<b>ADMINISTRATION</b>		
Grants - Saskatchewan Lotteries Trust Fund	\$ 93,500	\$ 92,500
Memberships	43,627	41,730
Interest	2,892	2,698
Donations and fundraising	11,234	12,102
Expense recovery - GST refundable portion	1,888	2,300
Miscellaneous	218	343
Total Administration Revenue	<u>\$153,359</u>	<u>\$151,673</u>
<b>PROGRAMS</b>		
Family History Fair	\$ 0	\$ 1,358
Saskatchewan resident index	363	318
Workshop contracts	0	600
Subscriptions	4,956	5,365
Research	5,471	5,762
Education	2,870	2,297
Special purchases donation	800	1,282
Cemetery	328	305
Reader printer	197	326
Publications	997	758
Seminar and annual meeting	850	819
Seminar donations	0	95
Profit on sales	1,434	514
Hosting seminar	12,191	0
Advertising	685	0
Total Program Revenue	<u>\$ 31,142</u>	<u>\$ 19,799</u>

**SASKATCHEWAN GENEALOGICAL SOCIETY INC.**  
Statement of Cash Flows  
For the year ended December 31, 1999

<b>CASH FLOWS FROM (FOR) OPERATING ACTIVITIES</b>	<u>1999</u>	<u>1998</u>
Excess revenue	\$ 1,798	\$ 500
Changes in non-cash working capital:		
Accounts receivable	309	( 282)
Inventory	( 649)	49
Accounts payable	( 211)	( 239)
Deferred revenues	<u>4,892</u>	<u>2,002</u>
Net increase (decrease) in cash	<u>6,239</u>	<u>2,030</u>
<b>CASH POSITION</b>		
Beginning of year	<u>95,802</u>	<u>93,772</u>
End of year	<u>\$102,041</u>	<u>\$ 95,802</u>

**SASKATCHEWAN GENEALOGICAL SOCIETY INC.**  
Notes to the Financial Statements  
December 31, 1999

**1. GENERAL**

The Society is incorporated under the Non-Profit Corporations Act of Saskatchewan. Its primary objective is the promotion and development of the study, research, and preservation of genealogy and family history in Saskatchewan.

**2. SIGNIFICANT ACCOUNTING POLICIES**

The Society has adopted the practice of recording capital assets as expenditures in the year acquired. This procedure was adopted in order that grants received, which are based on anticipated capital expenditures, as well as usual operating expenditures, might be more closely matched with the corresponding expenditures.

In order to accurately reflect the financial position of the Society, the capital assets are then recorded with an offsetting credit to "Equity in Capital Assets". Depreciation is recorded on the straight line basis on computer equipment at 40% per annum and 20% on other equipment. This is recorded as a charge to "Equity in Capital Assets".

Total capital assets charged to operations during the year were \$3,003 (1998 - \$2,705)

**3. DEFERRED REVENUES**

Revenues received in the year, but applicable to future years, are as follows

	<u>1999</u>	<u>1998</u>
Subscriptions	\$ 330	\$ 267
Workshops and other fees	928	430
Memberships	15,614	18,442
Donations and fundraising (specified)	12,996	11,487
Operating grant 1 <sup>st</sup> half	<u>52,500</u>	<u>46,750</u>
	<u>\$ 82,368</u>	<u>\$ 77,376</u>

**4. CAPITAL ASSETS**

	<u>Cost</u>	<u>Accum. Deprec.</u>	<u>Net Book Value</u>	
	<u>1999</u>	<u>1998</u>	<u>1999</u>	<u>1998</u>
Computer equipment	\$ 35,229	\$ 30,863	\$ 4,366	\$ 5,092
Other equipment	<u>32,850</u>	<u>31,446</u>	<u>1,404</u>	<u>1,112</u>
	<u>\$ 68,079</u>	<u>\$ 62,309</u>	<u>\$ 5,770</u>	<u>\$ 6,204</u>

**5. INCOME TAX STATUS**

The Society is a non-profit organization within the meaning of the Income Tax Act and is therefore exempt from income taxes.



**SASKATCHEWAN GENEALOGICAL SOCIETY INC.**  
Schedule of Expenditures  
For the year ended December 31, 1999

	<u>1999</u>	<u>1998</u>
<b>ADMINISTRATION</b>		
Personnel		
Salaries	\$ 59,300	\$ 58,138
Benefits	<u>11,735</u>	<u>10,966</u>
Total Personnel	<u>71,035</u>	<u>69,104</u>
Office		
Rent	6,060	5,974
Printing and copying	917	880
GST	1,988	2,279
Communications	174	187
Telephone	1,392	1,387
Office supplies	1,058	735
Maintenance and repairs	88	0
Sundry	<u>226</u>	<u>100</u>
Total Office	<u>11,903</u>	<u>11,522</u>
Corporate		
Promotions	303	778
Professional development	175	103
Membership	1,444	1,494
Committee expense	705	625
Bank charges	62	52
Fees, license, and insurance	<u>2,382</u>	<u>2,760</u>
Total Corporate	<u>5,081</u>	<u>5,812</u>
Total Administration	<u>\$ 88,019</u>	<u>\$ 86,438</u>
<b>TRAVEL AND MEETINGS</b>		
Staff travel	784	1,564
Volunteer travel	2,599	5,035
Membership meetings	1,133	1,501
Board meetings	<u>581</u>	<u>468</u>
Total Travel and Meetings	<u>\$ 5,097</u>	<u>\$ 8,568</u>
<b>MEMBERSHIP COMMUNICATIONS</b>		
Bulletins		
Printing	9,349	9,246
Postage	1,188	1,113
Supplies	<u>325</u>	<u>222</u>
Total Membership Communications	<u>\$ 10,862</u>	<u>\$ 10,581</u>

**SASKATCHEWAN GENEALOGICAL SOCIETY INC.**  
Schedule of Expenditures  
For the year ended December 31, 1999

	<u>1999</u>	<u>1998</u>
<b>PROGRAMS</b>		
Library		
Program co-ordinator	\$ 39,597	\$ 38,573
Casual labour	237	0
Rent	6,060	5,974
Library resources	1,883	1,532
Bookbinding	1,506	811
Subscriptions	4,619	4,699
Postage	1,615	1,645
Printing	173	158
Research	1,279	1,408
Supplies	<u>551</u>	<u>666</u>
Total Library	<u>57,520</u>	<u>55,466</u>
Special purchases	800	1,282
Obituary files	356	172
Awards Recognition	70	68
Saskatchewan resident index	310	503
Fundraising	1,150	1,365
Cemetery	373	187
Education	2,084	1,312
Sask Heritage Resources Directory	48	198
Branch administration	219	183
Family History Fair	0	1,358
Reader printer	356	444
Publications	245	142
Hosting seminar	<u>12,191</u>	<u>0</u>
Total Programs	<u>\$ 75,722</u>	<u>\$ 62,680</u>
<b>EQUIPMENT PURCHASES (NET OF SALES)</b>		
Office	2,510	\$ 2,705
Library	<u>493</u>	<u>0</u>
Total Equipment Purchases	<u>\$ 3,003</u>	<u>\$ 2,705</u>

E.J.C. DUDLEY & CO

# SGS Bulletin Board

## LIBRARY CLOSURES:

April 8 - Family History Fair in Regina  
April 21 & 22 - Easter  
April 28 & 29 - Annual General Meeting in Saskatoon  
May 22 - Victoria Day  
July 3 - Canada Day  
August 7 - Saskatchewan Day  
September 4 - Labour Day  
October 7-9 - Thanksgiving Day  
October 21 - SGS Seminar in Regina  
November 11 - Remembrance Day  
December 23 - January 1, 2001 - Christmas Break

May 24, 2000      9:00-11:00 am  
**Home Sources: Part One - Your Home & Home**  
**Sources: Part Two - Your Community**

May 31, 2000      9:00-11:00am  
**The Internet - Friend or Foe?**

June 7, 2000      9:00-11:00 am  
**Genealogy Programs and the CD-Rom**

June 14, 2000      9:00-11:00 am  
**Next Step**

\*\*\*

## SUMMER HOURS:

Effective May 1, 2000 hours are:  
**Monday - Friday, 9:30 a.m. - 4:30 p.m.**  
(*Last Saturday opened - April 15, 2000*)

## WINTER HOURS:

Effective September 19 hours are:  
**Tuesday - Saturday, 9:30 a.m. - 4:30 p.m.**  
(*Last Monday opened - September 11, 2000*)

## WORKSHOPS:

Workshops are held at SGS, 1870 Lorne Street,  
Regina, SK. Pre-register two (2) days prior to  
workshop at (306)780-9207. **Fees: \$7.50 per class.**  
***Special Rates: (Pre-registration and prepayment  
required) \$42.00 for all seven (7) workshops.***

## BEGINNING YOUR GENEALOGY

May 3, 2000      9:00-11:00 am  
**Using Pedigree Charts and Family Unit Sheets**

May 10, 2000      9:00-11:00 am  
**Developing a Research Plan**

May 17, 2000      9:00-11:00 am  
**Analyzing Data**

## GENEALOGY SUMMER CAMP

July 17-21, 2000

Under the guidance of an experienced researcher you have a chance to learn how to conduct genealogical research in Saskatchewan. Attend tutorials about specific records then spend time applying this new found knowledge at SGS Library, Regina Public Library and Saskatchewan Archives Board.

This hands on program will help participants make the optimum use of their research time.

Fee: \$65.00

Time: 9:00 am - 4:30 pm daily

Minimum of 6 students and maximum of 10

Contact SGS at (306) 780-9207 for more information, an application form or a detailed brochure.

++++

SGS presents the fourth Family History Fair  
**"Preserving Family History Beyond 2000"**  
 Saturday, April 8, 2000 from 9:30 am - 4:30 pm  
 St. Martin's Parish Hall - 4720 Castle Road, Regina

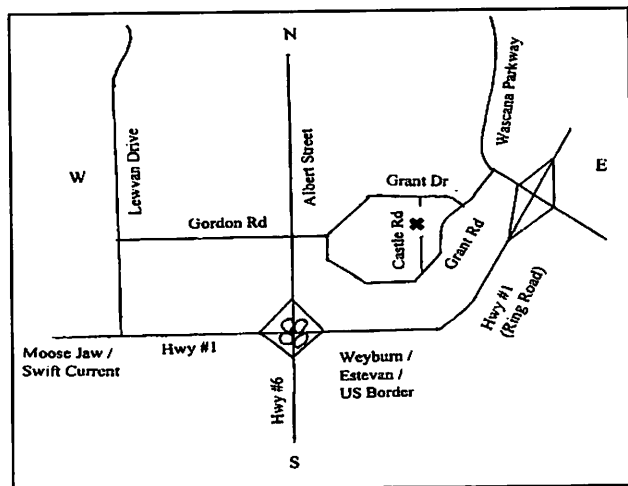

**EXHIBITORS:** Exhibitors will be available to demonstrate and sell their products and services.

**WORKSHOPS:**

1. **Using charts To Organize Your Family History**
2. **The Research Plan, Part 1**
  - Who are you looking for? Name changes
  - Where are you looking? Places and place name changes
3. **The Research Plan, Part 2**
  - When are you looking? Time frame
  - What are you looking for? Resources to check
4. **How to Plan A Family Reunion**

**ADMISSION:**

Adults \$3.00 Children under 12 FREE  
*Workshops are included in the admission fee.*

For further information or a brochure, contact:  
 Saskatchewan Genealogical Society at (306)780-9207

++++

**LOCATION:** St. Martin's Parish Hall is fully handicapped accessible.

## Millennium Past ... Millennium Future

Seminar October 20-22 Hosted by **Regina Branch**  
*Saskatchewan Genealogical Society*

Ramada Hotel (formerly Sands, recently renovated)

Keynote Address: Penny Christensen

*"Saving Money in Genealogy"*



**Workshops:** Long Distance Research (Britain),  
 Proving your Pedigree, National Archives Resources  
 (Immigration & Aboriginal/Metis Records),  
 Genetics, Danish Research, Military Records  
 (International, National & Local), Native  
 Ancestry, Doukhobors Provincial & Church  
 Archives, German Ancestry, Publishing a Book,  
 Transcribing German Script, Computer Use, Family  
 History Library Resources, Beginner's Workshop

**Contacts for further information:**

Dianne Romph 789-8088 Darlene Clifford 789-7432

# Announcements

BY JOHN CHAMBERLAIN

## **The Millennium British Family History Conference**

The Wiltshire Family History Society in association with the Federation of Family History Societies is hosting the Millennium British Family History Conference at Bath University, 26-30 Apr 2000. If you would like to receive full information on the programme and costs, etc. when ready in late 1998 contact: Wiltshire FHS, Conference 2000, The Workroom, 10 Castle Lane, Devizes, Wilts SN10 3SB OR e-mail: [donainge@aol.com](mailto:donainge@aol.com).

## **Celebrating Slavic Community**

This conference focuses on historical community development and will be held 28 - 30 April, 2000 in Saskatoon. For further information, contact: Don Kossick, Saskatoon Community Outreach at (306) 933-4346 or Bob Ivanochko in Regina at (306) 787-2986.

## **Ontario Genealogical Society - Seminar 2000**

The Ottawa Branch of the OGS will be hosting the OGS Seminar 2000. The seminar will be held at the Ottawa Congress Centre, Ottawa, Ontario 12 - 14 May 2000. The seminar will consist of 45 lectures in 5 concurrent streams. Other features include a Wall of Ancestors, Workshops, and Tours. New for 2000 is the Family History Competition. The Competition will be a judged event with prizes. Special rate information is available on hotels and travel. For further information on the seminar or guidelines and entry form for the Family History Competition visit <http://www.cyberus.ca/~ogsottawa/sem2000.htm>; write to OGS Seminar 2000, Merivale Postal Outlet, PO Box 65087, Nepean ON K2G 5Y3; or e-mail [ogsottawa@cyberus.ca](mailto:ogsottawa@cyberus.ca)

## **National Genealogical Society Conference in the States**

Join NGS as the 2000 Conference in the States comes to New England 31 May - 3 June 2000 in

Providence, Rhode Island. For a brochure or further information contact: NGS 2000 Conference Brochure, 4527 17<sup>th</sup> Street North, Arlington VA 22207-2399; Web site: [www.ngsgenealogy.org](http://www.ngsgenealogy.org); or E-mail: [conference@ngsgenealogy.org](mailto:conference@ngsgenealogy.org)

## **Germans From Russia Heritage Society (GRHS) Convention**

Dakota Pioneer chapter, Germans from Russia Heritage Society is celebrating the GRHS convention 13-16 July 2000 at the Radisson Inn, 800 S. 3<sup>rd</sup>, Bismarck, North Dakota. For further details or a brochure, contact: GRHS 2000 Convention, 1008 East Central Avenue, Bismarck ND 58501.

## **MISCELLANEOUS**

### **Yorkshire Family History Fair**

5<sup>th</sup> Yorkshire Family History Fair will take place 24 June 2000 and York Racecourse (Knavesmire Stand) from 10:00 am-4:30 pm. Believed to be the biggest event of its kind in the UK. For details contact: Mr. A Sampson, 1 Oxbang close, Redcar, Cleveland, TS10 4ND, England.

### **Yorkshire 2000**

Yorkshire 2000 to be held 3 - 10 August 2000 is a celebration of the Heritage of the Yorkshire Settlers who settled in the Maritimes between 1772 and 1775. Please contact Yorkshire 2000, c/o Tantrammar Heritage Trust, PO Box 6301, Sackville, New Brunswick Canada E4L 1G6 or visit <http://tapnet.tap.nb.ca/tht/york2000.html>.

### **24th International Congress of Genealogical and Heraldic Sciences**

24<sup>th</sup> International Congress of Genealogical and Heraldic Sciences will take place in the historical city of Besancon / France, from 2<sup>nd</sup> - 7<sup>th</sup> May, 2000. For programme and information update see internet site: <http://congres2000.besancon.net>.

++++

# Queries

BY JOHN CHAMBERLAIN

**BARNETT:** Seek info on grandfathers brother Harry (Harold) **Barnett** who came from Kingston on Thames, London. His father was a Metropolitan Policeman, who I believe served at Holborn, by the name George **Barnett** and he married Emily (nee **Town**). Ernest **Barnett** (his brother and my grandfather) was b in 1882 and Harry was younger (year of birth unknown). George, Emily and Ernest moved to Bournemouth in 1911, I do not know if Harry came with them or if he was already married and continued to live in London. Harry apparently divorced his wife Lilah (name I was given) and subsequently remarried in Canada and had another child. Believe that he died of cancer without returning home. Jill Owen, 6 Noyce Gardens, Townsend, Bournemouth, Dorset England BH8 0JZ.

**BURDEN:** Edward and Mary **Burden** and their children George, Richard, John, Edmund Kenward, Sarah, Mahala and Olive Jane came to Canada in April or May 1843. Traveling with them were Susan

**Boorman** (b.1828), Robert **Bridger** (b.1823), Hezekiah and Elizabeth **Iden** and their children George, Carolyn and Elizabeth. Any info about any of these people would be appreciated. Mary Sones, 1109 95<sup>th</sup> Avenue, Dawson Creek BC V1G 1J2.

**ERSKINE/SPEIRS:** Seek descs of John **Erskine** b.1830 in Scotland; d ? In Paisley?, Renfrew Scotland; m 2 September 1848 in Houston, Renfrew to Mary Stewart **Speirs** b 1830/31 in Bridge of Weir, Renfrew. Had 8 children: Mary Stewart, William, James\*, John, Margaret Speirs, Jennie, Ann and Agnes Pattison (All **Erskines**). \*James (b 25 {21?} July 1854. Came to Canada in 1905 and was my husband's, Glenn **Erskine**, grandfather. Wondering if James siblings relocated? Willing to share info. Shirley Erskine, 327 Kirkcaldy Drive, Brandon MB R7A 0C3, E-mail: [serskine@geocities.com](mailto:serskine@geocities.com).

++++

---

## In Memorium

- Ethel Mary (nee Root) Arnot - November 13, 1999 - Regina SK. Ethel and her husband Jack were very active with SGS Regina Branch. Ethel served as financial secretary of SGS for 1979 and 1980. She was honoured by SGS Regina Branch at one of their potluck suppers.
- Bruno Petschulat husband of Louise - December 4, 1999 - Regina SK
- Josie (nee Weiss) Gleisinger wife of Garth - January 12, 2000 - Melville SK
- Betty Koch wife of Alvin - January 29, 2000 - Regina SK

# Advertising

## B4U

### Family History Services

*Blanche L. Fleming*

626 Moffet Drive  
Weyburn, SK  
S4H 2M7  
(306)842-2593

SGS Certified  
\*Researcher  
\*Instructor  
\*Record Searcher

bl.fleming@sk.sympatico.ca

### ADVERTISING

SGS accepts paid advertisements for the Bulletin. Camera ready and disk copy preferable. Contact SGS for policy and rates. SGS Bulletin, PO Box 1894, Regina Saskatchewan S4P 3E1. E-mail: [margethomas.sgs@cableregina.com](mailto:margethomas.sgs@cableregina.com). Cutoff for Bulletins are April 15, 2000, July 15, 2000 and October 15, 2000.

### Birth, Marriage & Death Certificates for England and Wales

Fast Efficient Service  
\$30.00 per Certificate

Please provide reference including:

- full name
- quarter and year registered, registration district and page

Other research services available

*Linda Wiggins and Partners*  
Box 172, Lumsden SK S0G 3C0

Phone: (306) 731-2309  
E-mail: [terracebank@sk.sympatico.ca](mailto:terracebank@sk.sympatico.ca)

*Your Western Canadian source*

## Genealogical Services Directory

*Year 2000 edition*

The best guide to what's available to help you with your research. Interlink is the exclusive dealer in North America.



**\$19.95**

*plus postage, GST*

## Interlink Bookshop

• GENEALOGICAL SERVICES •

e-mail [ibgs@pacificcoast.net](mailto:ibgs@pacificcoast.net)  
3840A Cadboro Bay Road, Victoria, B.C., V8N 4G2  
Phone (250) 477-2708 • (800) 747-4877

[www.pacificcoast.net/~ibgs](http://www.pacificcoast.net/~ibgs)

### Join the Regina Branch

- We Exchange and Share Information, Expertise and Experience
- We have **Guest Speakers** at our monthly Meetings
- We are hosting the 2000 Seminar in October
- We are in need of a **Secretary**
- We **Published** the 4<sup>th</sup> in a series of The Territories - 1891 - Census of Canada

\$10.00 yearly includes 4 issues of "NOW and THEN"

For more information contact Bob at (306)584-2582

We meet the 4<sup>th</sup> Tuesday of the month At Knox-Metropolitan United Church (South side door) 2340 Victoria Avenue At 7:30 p.m.





## SGS BRANCHES: CONTACTS & MEETINGS

BATTLEFORDS BRANCH: Box 138, Meota, SK S0M 1X0.  
Meetings: 3rd Wed. (except June, July, August & December) 7:00 pm  
at North Battleford Public Library. Contact: Carolyn Hayes #892-4314

BIGGAR BRANCH: Box 1103, Biggar, S0K 0M0. Meetings: 2nd  
Wed. 7:30 pm at Post Office - 2<sup>nd</sup> Avenue entrance. Contact: Barb  
Archibald #948-2138

BORDER BRANCH: 2615 - 53rd Ave., Lloydminster, AB T9V 2L6.  
Meetings: 4th Mon. 7:00 pm at Lloydminster Public Library.  
Contact: Edith Cunningham # (780) 875-0578

CENTRAL BUTTE BRANCH: Box 298, Central Butte, S0H 0T0.  
Meetings: 4th Wed. (except July, August & December) at 7:30 pm at  
various locations. Contact: Joanne Berg #796-2148

CRAIK BRANCH: Box 337, Craik, S0G 0V0. Meetings: 3rd Mon.  
7:30 pm at Craik R.M. Office. Contact: June Exelby #734-2820

ESTEVEAN BRANCH: Inactive. Contact: Faith Stepp, Box 81,  
Torquay, S0C 2L0. #923-4507

GRASSLANDS BRANCH: Box 272, Mankota, S0H 2W0.  
Meetings: 3rd Tues at 7:30 pm at Hazenmore SK. Contact: Linda  
Calvin #478-2314

GRENFELL BRANCH: Box 61, Grenfell, S0G 2B0. Meetings: 3rd  
Tues. 7:30 pm at Grenfell Museum. Contact: Lloyd Arthur #697-3176

MOOSE JAW BRANCH: Box 154, Briercrest, S0H 0K0.  
Meetings: 2nd Tues. (except July & August) 7:00 pm at 1068  
Athabasca St. W. Contact: Marge Cleave #799-2004

NORTH-EAST BRANCH: Box 1988, Melfort, S0E 1A0.  
Meetings: 1st Tues. 7:30 pm at N.E. Leisure Centre. Contact: Sandra  
LeBarre #874-2829

PANGMAN BRANCH: Box 23, Pangman, S0C 2C0. Meetings: 4th  
Wed/Sat (except January, February & March), time varies at Pangman  
Regional Library. Contact: Edith Merritt #442-4206

PIESTONE BRANCH: Box 1454, Moosomin, S0G 3N0.  
Meetings: 3rd Wed. 7:30 pm at Moosomin Public Library. Contact:  
Ferne James #435-3845

PRINCE ALBERT BRANCH: Box 1464, Prince Albert, S6V 5T1.  
Meetings: 2nd Tues. 7:30 pm at P.A. Museum. Contact: Annette  
Krayetski #763-5029

QUILL PLAINS BRANCH: Box 68, Kelvington, S0A 1W0.  
Meetings: 1st Wed. 7:30 pm at local libraries. Contact: Dianne Gradin  
#327-5379

RADVILL BRANCH: Inactive. Contact: Elda Henheffer #869-3153

REGINA BRANCH: 2818 Sinton Avenue, Regina, SK S4S 1K3.  
Meetings: 4th Tues. 7:30 pm at Knox Metropolitan Church. Contact:  
Robert Ewart #584-2582

SASKATOON BRANCH: Albert Community Centre, Box 5, 610  
Clarence Avenue South, Saskatoon, S7H 2E2. Meetings: 2nd Wed.  
7:00 pm at Albert Community Centre. Contact: Lynda Andrew #978-  
1656

SOUTHEAST BRANCH: Box 460, Carnduff, S0C 0S0. Meetings: 4th  
Mon. (except July, August & December in Oxbow or Carnduff) 8:00  
pm at Oxbow Public Library. Contact: Stella Harrison #482-3410

SWIFT CURRENT BRANCH: 207 - 12 Cheadle Street W, Swift  
Current, S9H 0A9. Meetings: 4th Mon. 7:30 pm at Salvation Army,  
780 1<sup>st</sup> Avenue NW. Contact: Beverly Hagen #297-3122

WEST CENTRAL BRANCH: Box 472, Eston, S0L 1A0. Meetings:  
3rd Tues., time varies, at Wheatland Regional Library. Contact: Gail  
Milton #962-3382

WEYBURN BRANCH: Box 1422, Weyburn, S4H 3J9. Meetings: 4th  
Mon. (except July, August & December) 7:30 pm at R.M. Office 23 -  
6th Street. Contact: Terry Smith #842-1309

YORKTON BRANCH: 28 Dalewood Cres., Yorkton, S3N 2P7  
Meetings: 2nd Tues. (except July & August) 7:00 pm at Yorkton  
Public Library. Contact: Rita Chernoff #782-0022

### Study Group:

PORCUPINE PLAIN: Contact: Louise Butterfield, Box 63, Somme,  
S0E 1N0 #278-2705.

### SGS Bulletin

- Articles are required for the Bulletin that are of genealogical value either generic topics or specific countries.
- Fillers are required that are of genealogical value - they may be a quarter, half or full page item.
- All submitted material will be considered for publication, however the Editor has the option of editing, reserving or rejecting any submission. Manuscripts must be fully referenced and carry the writers signature. Please advise the Editor if the material has previously appeared in another publication. **SGS will be responsible for requesting permission for articles to be reprinted.**
- To allow a variety in each issue, please submit articles early so we have time to edit, format and decide which issue it will appear in.
- Disk copy or e-mail preferable in **rich text** format.

*Thank you for sharing your articles/fillers with us*



# SASKATCHEWAN GENEALOGICAL SOCIETY RESEARCH POLICIES

## BASIC SEARCH

*\$33 CDN or \$33 US per person.* The SGS will do a basic search of Saskatchewan sources. We require a given name and surname. Sources searched: 1. Homestead index & file. 2. Obituary index. 3. Cemetery index & file. 4. Local histories. 5. Newspaper index. 6. SRI.

Additional sources may be checked if a locality is given or found as a result of the search. If a specific date for an event is given a newspaper check may be done if available.

You will receive a written report of the research that has been done, noting all the sources checked. Up to \$2.00 worth of copying plus postage is included. Beyond that copying charges would be quoted. Current fees are 25¢ per page for paper to paper copies and 50¢ per page for microfilm to paper copies. NOTE: It takes as long to do an unsuccessful search as a successful search. Your chances for a successful search may depend upon how accurately you are able to describe the search you wish to have done.

## INTERNATIONAL GENEALOGICAL INDEX (IGI) 1992 EDITION - Members Only

*Mail Search - \$2 per name, per location.* ie. John Smith, England, Kent Co. Includes search, 1 copy, return postage. Addition Christian names 50¢ each. Smith in England, Kent - Mary & George would be 50¢ each. Prints now 30¢ ea. For other research options & an explanation of the IGI, order the Research Guide for \$2.

## SASKATCHEWAN CEMETERY SEARCH

*\$2.00 per name, plus a self-addressed stamped envelope if the name of the cemetery is given.*

*\$10 per name if all cemeteries need to be checked.*

## SGS SASKATCHEWAN RESIDENT INDEX (SRI)

General Search - all entries for a particular surname. Includes: 3 pages of printouts, quote for entries beyond this number. *\$3 per surname.*

Particular Search - one name. Includes print for one page. \$2.

## INDEX TO BIRTHS, MARRIAGES & DEATHS

*3 year search. - \$10 per person. US & foreign pay US funds.*

- England & Wales 1837-1890; 1900; 1901; 1912-1914
- Ontario Births 1869-1902; Marriages 1869-1917; Deaths 1869-1927

For a marriage record both parties considered as one. Report will include the information from the index as well as information about how to find the original record.

## SEARCH FEE FOR THE FOLLOWING RECORDS:

*\$5 per surname. US & foreign pay US funds.*

- Index to 1881 & 1891 Census for Assiniboia East, Assiniboia West & the District of Saskatchewan.
- Index to 1870 Census of Manitoba
- Index to 1871 Census of Ontario
- Index to Upper & Lower Canada Land Records 1737-1867
- Index to Ontario Land Records (*Original Landowners only*)
- Index to 1881 Census Index England & Wales, Isle of Man, Guernsey, Jersey & Royal Navy (Fee is per surname per county)
- Index to Old Parochial Registers (OPR) of Scotland for Aberdeen, Angus, Glasgow, Inverness, Kincardine, Orkney, Sutherland, Renfrew, Ross & Cromarty, Kirkcubright. (*Fee is per surname per county*)
- Index to BC Vital Statistics: Marriages 1872-1921; Deaths 1872-1976
- Aberdeenshire Index of Monumental Inscriptions. The Index will tell you which cemetery your surname is found. The SGS has a large collection of these Monumental Inscriptions. IF the SGS has the cemetery we will check it for you. Remember, Members living in Canada may borrow these books. If the book isn't in the library we will advise you about the title and let you know the cost so that you could purchase it.

Report will include date found plus information so searcher can locate the original source OR we will provide up to 3 prints from microfiche if the index is found on microfiche.

## Analysis & Research Plan

*\$50 per family of origin.* We will provide a professional analysis of the information a person has and will develop a search plan for further research. Can be done in person or by mail.

*Contact the Society for details about other research services that are available.*

- Indian and Metis Sources
- Pre-1869 Marriage Records for Ontario
- Repertoires for RC Parishes of Quebec 1700-1765
- Householders Index for Griffith Valuations in Ireland 1845-1867

**No Refund for entries not found.**

**ALL RESEARCH POLICIES ARE SUBJECT TO  
CHANGE SHOULD COSTS INCREASE.**



**Saskatchewan Genealogical Society Inc.**

PO Box 1894

Regina Saskatchewan S4P 3E1

Paid at Regina, SK

Publications Mail

Registration No.

**09800**

Return Postage Guaranteed